

UPDATED: 10/25/2013

**NOTE: +8' POSTS  
ALONG RWY EDGE  
AND  
+2' BARREL AND  
PIPE THRESHOLD  
MARKERS ON  
BOTH ENDS OF  
RUNWAY**

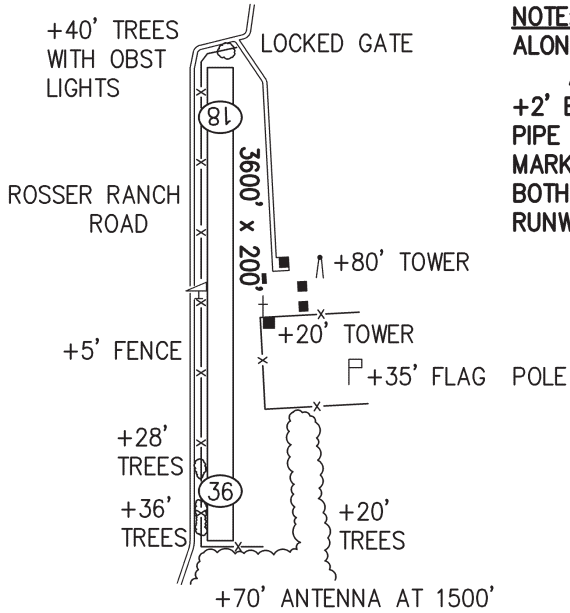

**Lat:** N 33° 00.92'  
**Lon:** W 98° 37.52'

**Elev:** 1112' MSL  
**TPA:** STD

**Sectional:** DALLAS-FT WORTH  
**Downtown to Apt:** 06 nm/SW

**Owner:** RICHARD M ROSSER  
4913 WYNNE LANE  
GRAHAM, TX 76450  
**Phone:** 940-549-7258

**Manager:** R M ROSSER  
4913 WYNNE LANE  
GRAHAM, TX 76450  
940-549-7258

**ATTENDANCE SCHEDULE:** UNATTENDED

**FUEL:** NONE

**REPAIRS:** Airframe: NONE      Power Plant: NONE

**LIGHTS:** NONE

**CTAF:** 122.9

**REMARKS:** FOOD (6MI); LODGING (7MI)

**FIXED BASE OPERATORS:** NONE

