



Texas Department of Transportation
TECHNICAL PROVISIONS

STATE HIGHWAY 71 TOLL LANES

Attachment 17-1
Conceptual ITS Layout
Addendum 1

STATE HIGHWAY 71
CONCEPTUAL ITS LAYOUT
ATTACHMENT 17-1

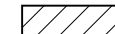
LEGEND

-  PROPOSED TOLL
-  PROPOSED NON-TOLL (SH 71 MAINLANES)
-  PROPOSED NON-TOLL (FM 973)

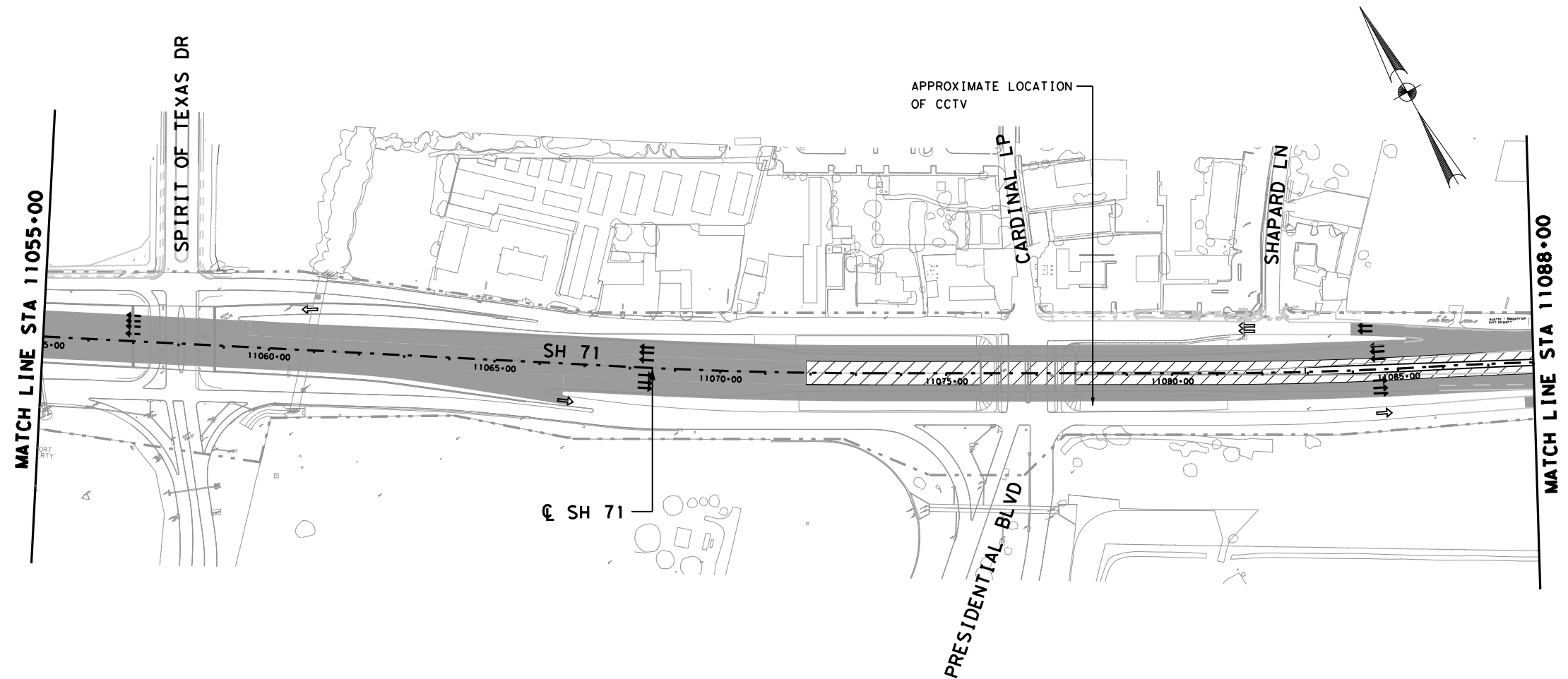
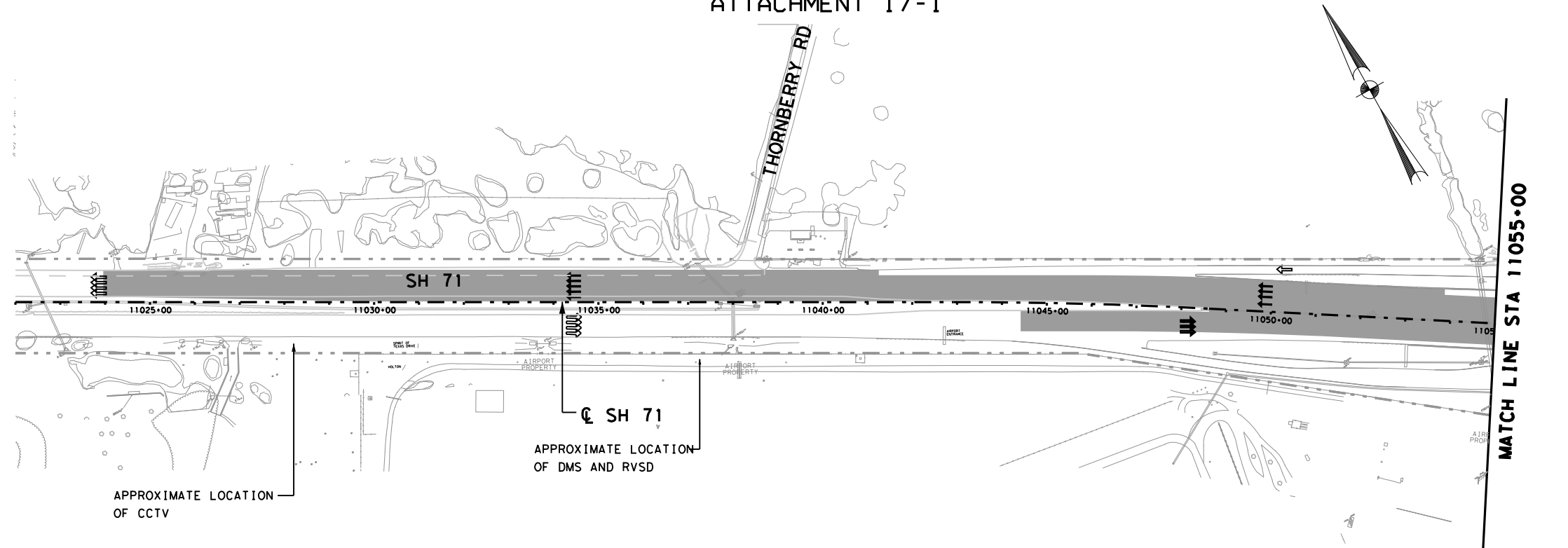

STATE HIGHWAY 71
CONCEPTUAL ITS LAYOUT
ATTACHMENT 17-1



SCALE: 1"=300'

SHEET 1 OF 3

1/14/2014 7:31:24 AM
C:\Users\Don\Desktop\Exhibit 17-1\SH71-ITS-01.dgn

C:\Users\Don\Desktop\Exhibit 17-1\SH71-ITS-01.dgn

LEGEND

-  PROPOSED TOLL
-  PROPOSED NON-TOLL (SH 71 MAINLANES)
-  PROPOSED NON-TOLL (FM 973)

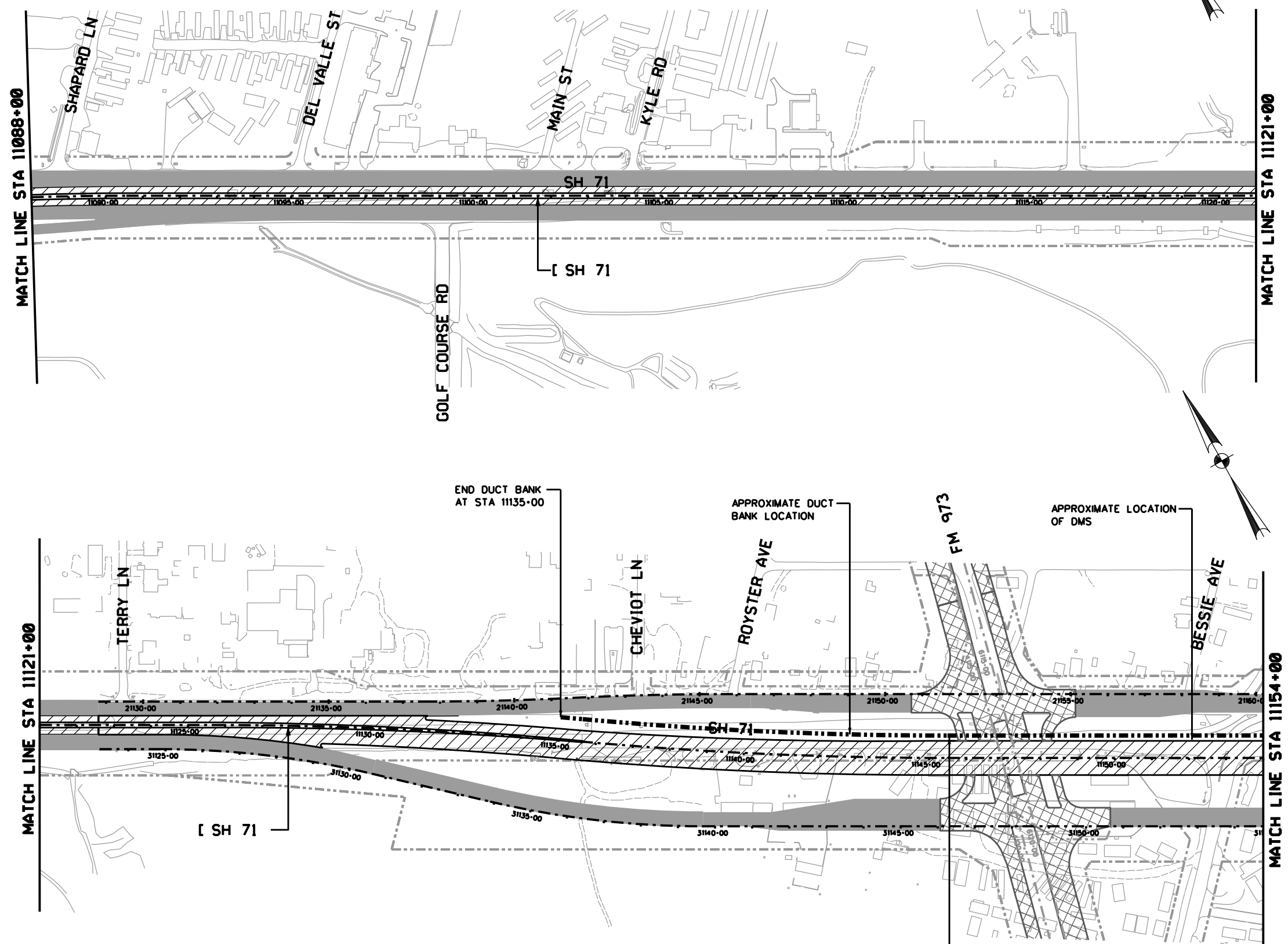

**SH 71 TOLL LANES
CONCEPTUAL ITS LAYOUT
ATTACHMENT 17-1**



SCALE: 1"=300'

SHEET 2 OF 3

SDATES
SPILES

FILES

LEGEND

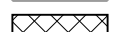
-  PROPOSED TOLL
-  PROPOSED NON-TOLL (SH 71 MAINLANES)
-  PROPOSED NON-TOLL (FM 973)

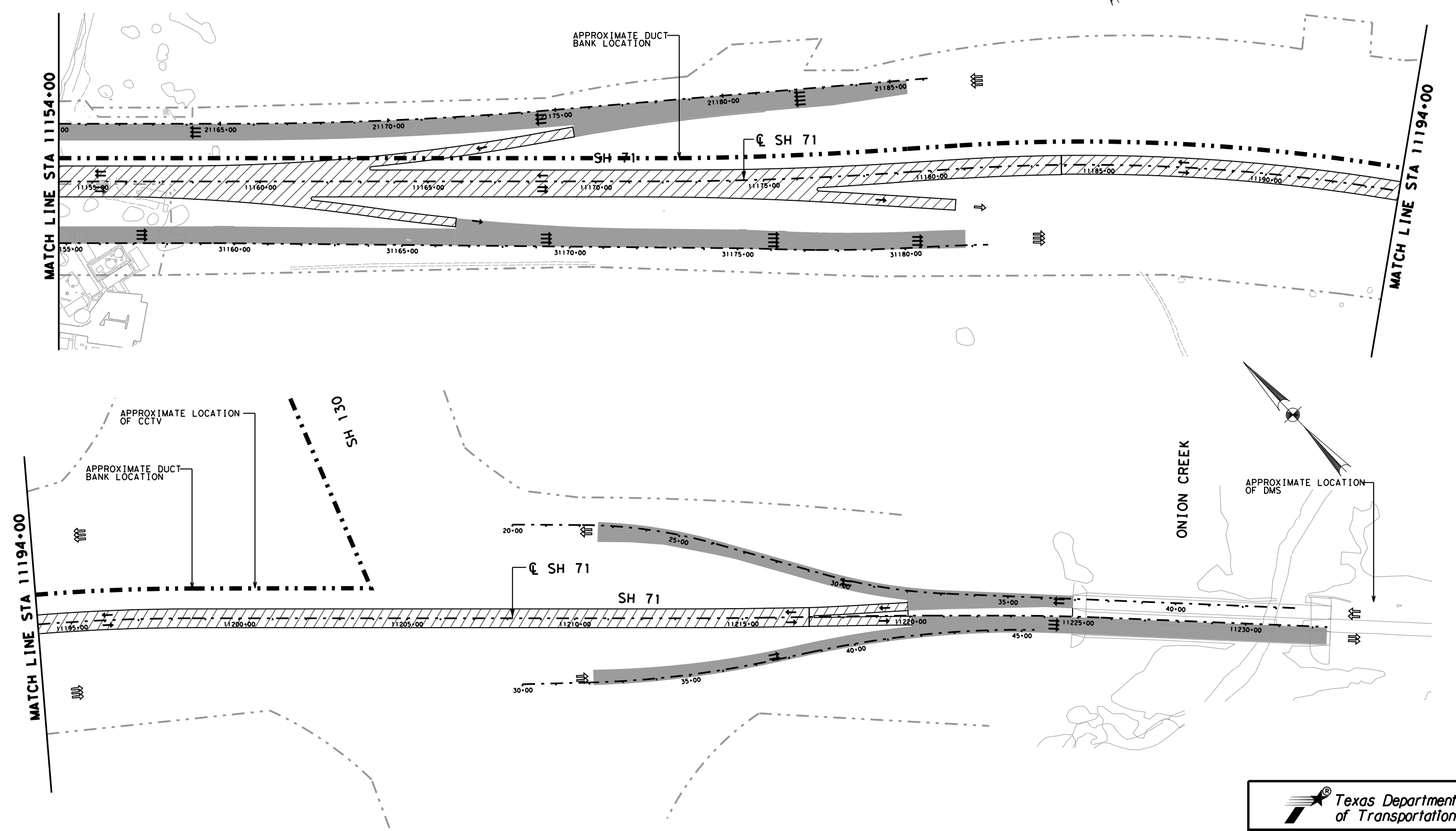

STATE HIGHWAY 71
 CONCEPTUAL ITS LAYOUT
 ATTACHMENT 17-1

1/14/2014 7:40:49 AM
 C:\Users\Don\Desktop\Exhibit 17-1\SH71-ITS-03.dgn

C:\Users\Don\Desktop\Exhibit 17-1\SH71-ITS-03.dgn