

11/4/2014 11:17:10 AM \\IEA-FLSRV\Jobs\2003B Falls County Bridges\06.00 Design\06.00 CR425\06.04 Sheets\06.04.03 Roadway\0909-38-052 (AAA) - CR 425 (FCR 386) - PLAN & PROFILE.dgn

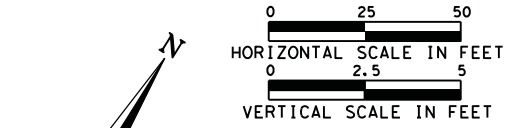
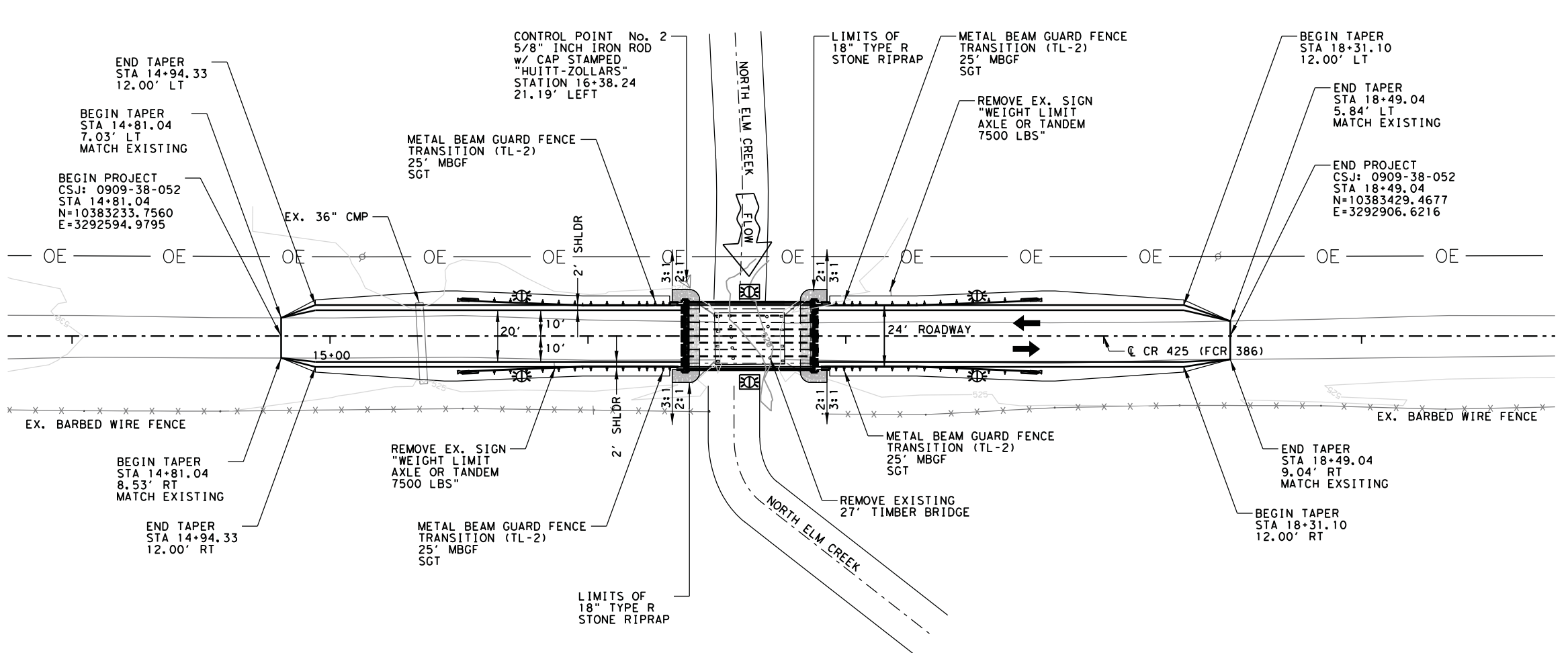

LEGEND

- INSTL DEL ASSM (D-SW) SZ 1 (TYC)GF2(B1)
- INSTL DEL ASSM (D-SW) SZ 1 (TYC)CTB(B1)

NOTES

1. CONTRACTOR SHALL FIELD VERIFY LOCATION OF ALL EXISTING UTILITIES PRIOR TO CONSTRUCTION.
2. SEE TxDOT D&M(3)-14 TWO-WAY, TWO LANE ROADWAY WITH METAL BEAM GUARD FENCE FOR PLACEMENT OF BRIDGE/CULVERT DELINEATORS AND OBJECT MARKER.
3. HORIZONTAL AND VERTICAL ALIGNMENT DESIGNED FOR 30 MPH.

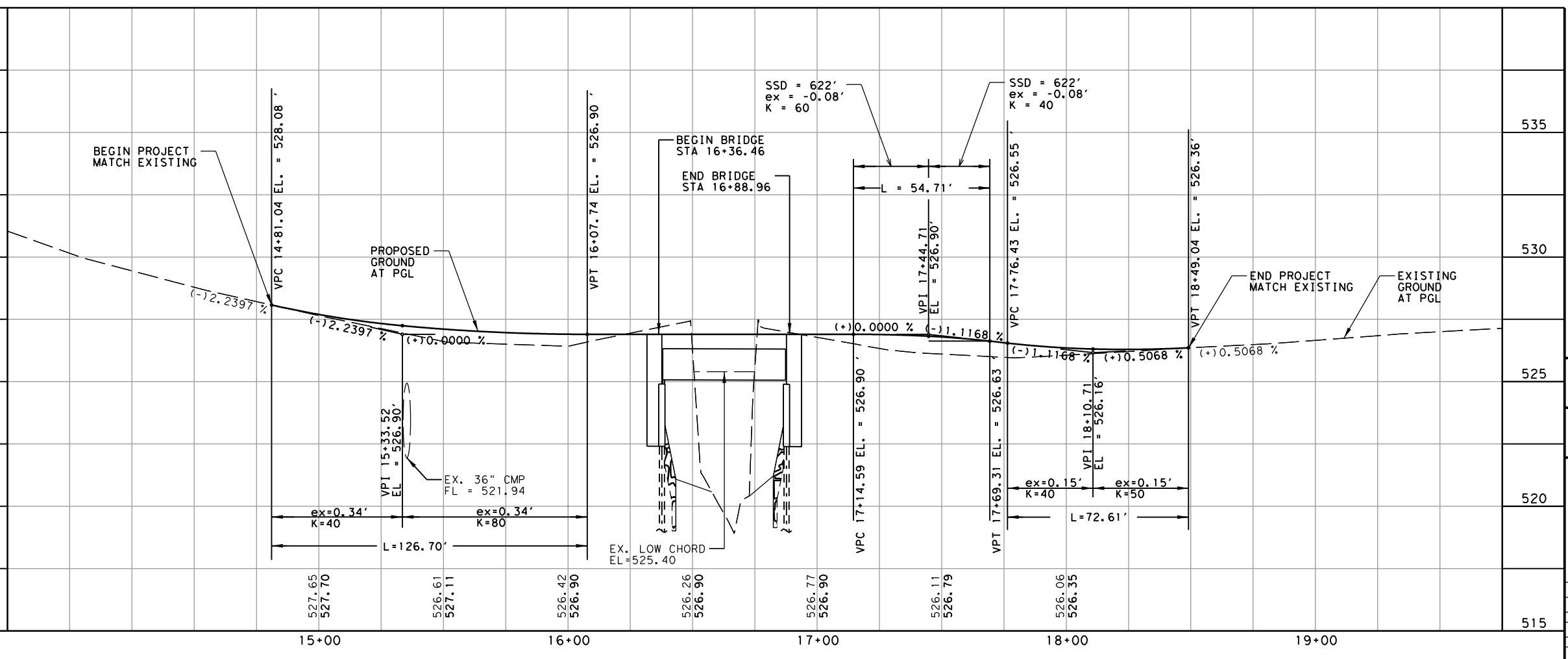

30% SUBMITTAL

THIS DOCUMENT IS RELEASED UNDER THE AUTHORITY OF:
 W. RICHARD RENTON, JR.
 TEXAS LICENSE NO: 84792
 DATE: 11/4/2014
 IT IS NOT TO BE USED FOR BIDDING, CONSTRUCTION, OR PERMIT PURPOSES.

©2014 Texas Department of Transportation
IEA 18333 PRESTON ROAD SUITE 205 DALLAS, TEXAS 75252 (214) 884-4253 Firm Registration No. F-10161

CR 425 (FCR 386)

PLAN & PROFILE

FED. RD. DIV. NO. 6	FEDERAL AID PROJECT NO. SEE TITLE SHEET	SHEET NO. 026
STATE TEXAS	DISTRICT WACO	COUNTY FALLS
CONT 0909	SECT 38	JOB 052, etc. HIGHWAY NO CR 425, etc.