

DISCLAIMER: This standard is governed by the "Texas Engineering Practice Act". No warranty of any kind is made by TxDOT for any purpose whatsoever. TxDOT assumes no responsibility for the conversion of this standard to other formats or for incorrect results or damages resulting from its use.

DATE:  
FILE:

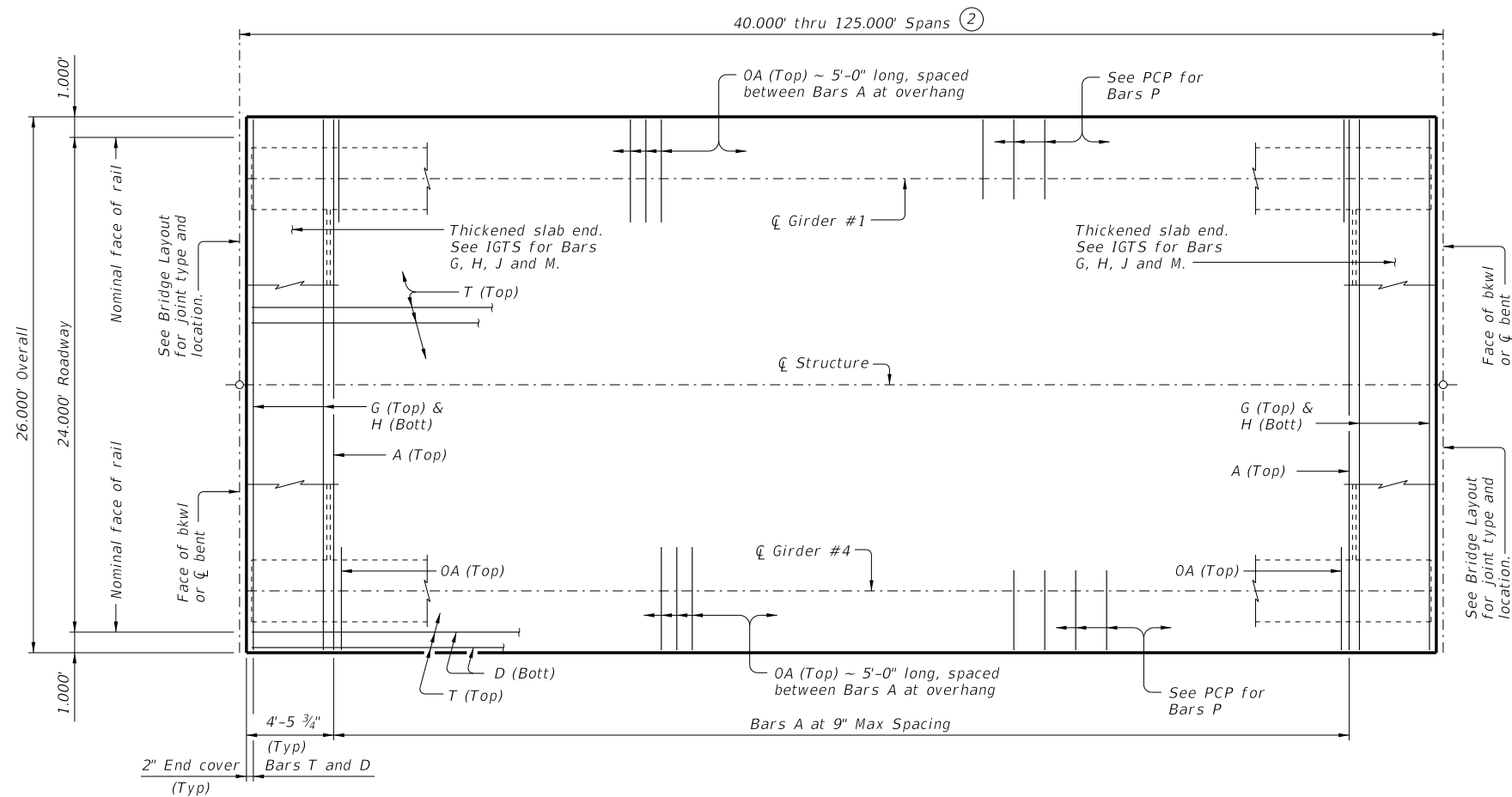

**PLAN** ①

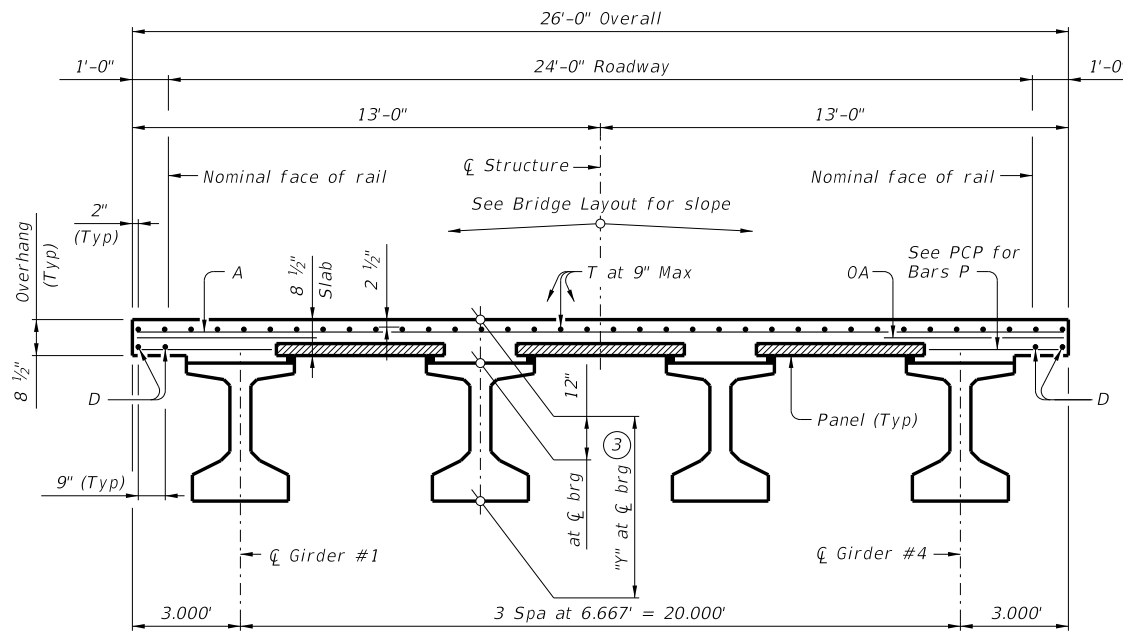

**TYPICAL TRANSVERSE SECTION**  
(Showing girder type Tx46)

TABLE OF SECTION DEPTHS	
GIRDER TYPE	"Y" AT $\zeta$ BRG ③
	Ft./In
Tx28	3'-4"
Tx34	3'-10"
Tx40	4'-4"
Tx46	4'-10"
Tx54	5'-6"

**BAR TABLE**

BAR	SIZE
A	#4
D	#4
G	#4
H	#4
J	#4
M	#4
OA	#5
P	#4
T	#4

① If multi-span units (with slab continuous over interior bents) are indicated on the Bridge Layout, see standard IGCS for adjustment to slab reinforcement and quantities.

② Span lengths for Prestressed Concrete I-Girder type:  
Type Tx28 for spans lengths 40,000' thru 75,000'.  
Type Tx34 for spans lengths 40,000' thru 85,000'.  
Type Tx40 for spans lengths 40,000' thru 100,000'.  
Type Tx46 for spans lengths 40,000' thru 115,000'.  
Type Tx54 for spans lengths 40,000' thru 125,000'.

③ "Y" value shown is based on theoretical girder camber, dead load deflection from an 8 1/2" concrete slab, a constant roadway grade, and using precast panels (PCP). The Contractor will adjust this value as necessary for any roadway vertical curve.

HL93 LOADING

SHEET 1 OF 2



**PRESTRESSED CONCRETE I-GIRDER SPANS (TYPE Tx28 THRU Tx54) 24' ROADWAY**

**SIG-24**

FILE: IG-SIG2400-23.dgn	DN: JMH	CK: NRM	DW: JTR	CK: TAR
©TxDOT August 2017	CONT	SECT	JOB	HIGHWAY
REVISIONS				
10-19: Increased "X" and "Y" Values.	DIST	COUNTY	SHEET NO.	
01-23: Removed PCP(O) reference.				

TABLE OF DEAD LOAD DEFLECTIONS

TYPE Tx28 GIRDERS			TYPE Tx34 GIRDERS			TYPE Tx40 GIRDERS			TYPE Tx46 GIRDERS			TYPE Tx54 GIRDERS		
SPAN LENGTH	"A"	"B"		"A"	"B"		"A"	"B"		"A"	"B"		"A"	"B"
Ft	Ft	Ft	Ft	Ft	Ft	Ft	Ft	Ft	Ft	Ft	Ft	Ft	Ft	Ft
40	0.007	0.010	40	0.004	0.006	40	0.003	0.004	40	0.002	0.003	40	0.001	0.002
45	0.012	0.017	45	0.007	0.010	45	0.005	0.007	45	0.004	0.005	45	0.002	0.003
50	0.019	0.027	50	0.011	0.016	50	0.007	0.010	50	0.005	0.007	50	0.004	0.005
55	0.028	0.040	55	0.017	0.024	55	0.011	0.016	55	0.008	0.011	55	0.005	0.007
60	0.041	0.057	60	0.024	0.034	60	0.016	0.022	60	0.011	0.015	60	0.007	0.010
65	0.056	0.079	65	0.033	0.047	65	0.022	0.031	65	0.015	0.021	65	0.010	0.014
70	0.077	0.108	70	0.046	0.064	70	0.030	0.042	70	0.021	0.029	70	0.014	0.019
75	0.102	0.143	75	0.061	0.085	75	0.040	0.056	75	0.027	0.038	75	0.018	0.025
			80	0.079	0.111	80	0.052	0.073	80	0.036	0.050	80	0.024	0.033
			85	0.102	0.143	85	0.066	0.093	85	0.046	0.064	85	0.030	0.042
						90	0.084	0.118	90	0.057	0.080	90	0.038	0.053
						95	0.105	0.147	95	0.071	0.100	95	0.047	0.066
						100	0.130	0.182	100	0.088	0.124	100	0.058	0.082
									105	0.108	0.151	105	0.071	0.100
									110	0.130	0.182	110	0.086	0.121
									115	0.156	0.219	115	0.103	0.144
									120			120	0.123	0.172
									125			125	0.145	0.203

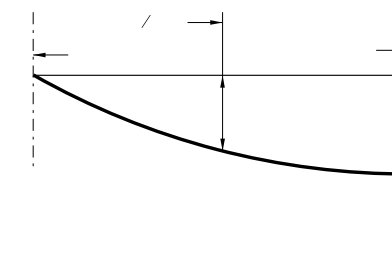

TABLE OF ESTIMATED QUANTITIES

SPAN LENGTH	REINF CONCRETE SLAB	Prestressed Concrete Girders			TOTAL REINF STEEL <sup>5</sup>
		ABUT TO INT BT <sup>4</sup>	INT BT TO INT BT <sup>4</sup>	ABUT TO ABUT <sup>4</sup>	
Ft	SF	LF	LF	LF	Lb
40	1,040	158.00	158.00	158.00	2,392
45	1,170	178.00	178.00	178.00	2,691
50	1,300	198.00	198.00	198.00	2,990
55	1,430	218.00	218.00	218.00	3,289
60	1,560	238.00	238.00	238.00	3,588
65	1,690	258.00	258.00	258.00	3,887
70	1,820	278.00	278.00	278.00	4,186
75	1,950	298.00	298.00	298.00	4,485
80	2,080	318.00	318.00	318.00	4,784
85	2,210	338.00	338.00	338.00	5,083
90	2,340	358.00	358.00	358.00	5,382
95	2,470	378.00	378.00	378.00	5,681
100	2,600	398.00	398.00	398.00	5,980
105	2,730	418.00	418.00	418.00	6,279
110	2,860	438.00	438.00	438.00	6,578
115	2,990	458.00	458.00	458.00	6,877
120	3,120	478.00	478.00	478.00	7,176
125	3,250	498.00	498.00	498.00	7,475

- ④ Fabricator will adjust lengths for girder slopes as required.
- ⑤ Reinforcing steel weight is calculated using an approximate factor of 2.3 lbs/SF.

MATERIAL NOTES:

GENERAL NOTES:

Multi-span units, with slab continuous over in may be formed with the details shown on this sheet and the I-Girder Continuous Slab Detail (IGCS) standard. See I-Girder Thickened Slab End Details (IGTS) standard for details and quantity adjustments. See Prestressed Concrete Panels (PCP) standard and Prestressed Concrete Panel Fabrication Details (PCP-FAB) standard for panel details not shown. See I-Girder Miscellaneous Slab Details (IGMS) standard for miscellaneous details. See applicable rail details for rail anchorage in slab. See Permanent Metal Deck Forms (PMDF) standard for details and quantity adjustments if this option is used. This standard does not support the use of transition bents.

Cover dimensions are clear dimensions, unless noted otherwise.

**Bridge Division Standard**

PRESTRESSED CONCRETE I-GIRDER SPANS (TYPE Tx28 THRU Tx54) 24' ROADWAY

SIG-24

FILE:	DN: JMH	CK: NRN	DW: JTR	CK: TAR
©TxDOT August 2017	CONT	SECT	JOB	HIGHWAY
REVISIONS				
10-19: Increased "X" and "Y" Values.				
01-23: Removed PCP(O) reference.				
	DIST	COUNTY	SHEET NO.	

DATE: FILE: