

DISCLAIMER: The use of this standard is governed by the "Texas Engineering Practice Act." No warranty of any kind is made by TxDOT for any purpose whatsoever. TxDOT assumes no responsibility for the conversion of this standard to other formats or for incorrect results or damages resulting from its use.

BAR TABLE

BAR	SIZE
A	#4
D	#4
G	#4
H	#4
J	#4
M	#4
OA	#5
P	#4
T	#4

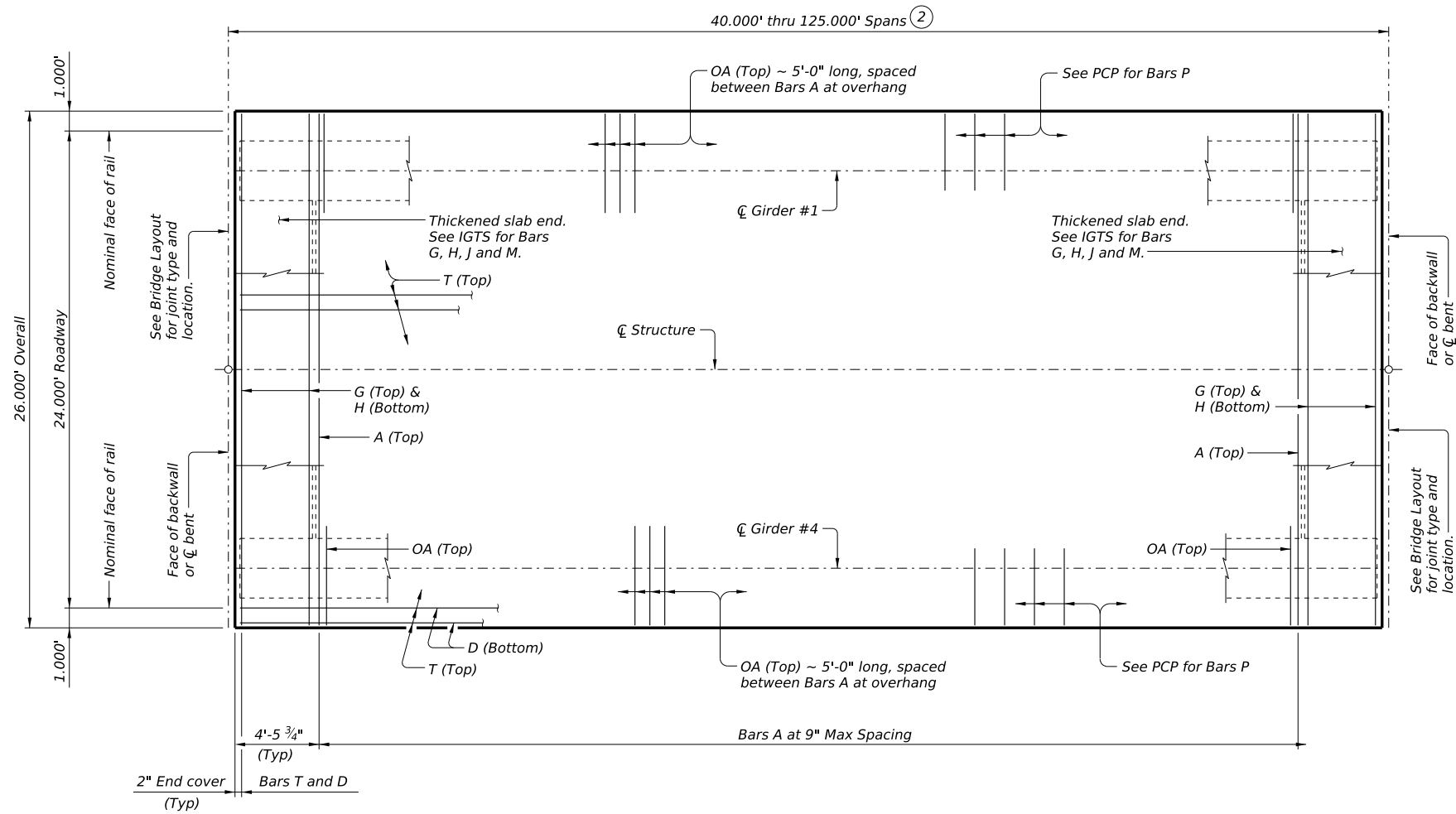

- ① If multi-span units (with slab continuous over interior bents) are indicated on the Bridge Layout, see standard IGCS for adjustment to slab reinforcement and quantities.
- ② Span lengths for Prestressed Concrete I-Girder type:
 Type Tx28 for spans lengths 40,000' thru 75,000'.
 Type Tx34 for spans lengths 40,000' thru 85,000'.
 Type Tx40 for spans lengths 40,000' thru 100,000'.
 Type Tx46 for spans lengths 40,000' thru 115,000'.
 Type Tx54 for spans lengths 40,000' thru 125,000'.
- ③ "Y" value shown is based on theoretical girder camber, dead load deflection from an 8 1/2" concrete slab, a constant roadway grade, and using precast panels (PCP). The Contractor will adjust this value as necessary for any roadway vertical curve.

PLAN ①

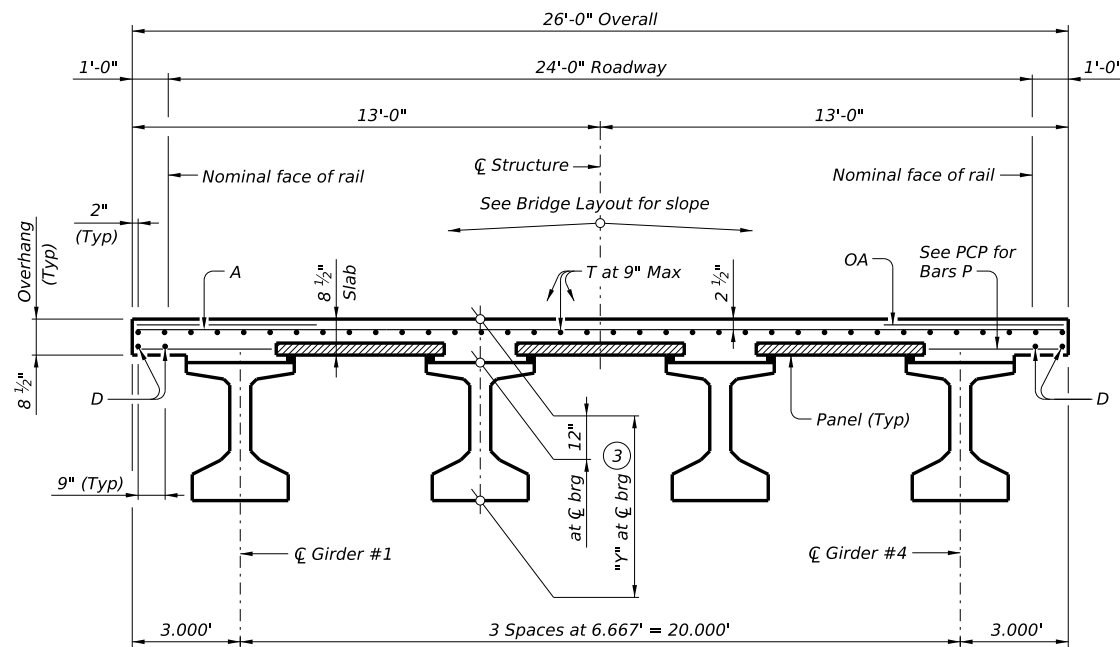

TYPICAL TRANSVERSE SECTION
(Showing girder type Tx46)

TABLE OF SECTION DEPTHS	
GIRDER TYPE	"Y" AT \bar{C} BRG ③
Tx28	3'-4"
Tx34	3'-10"
Tx40	4'-4"
Tx46	4'-10"
Tx54	5'-6"

HL93 LOADING

SHEET 1 OF 2



PRESTRESSED CONCRETE I-GIRDER SPANS (TYPE Tx28 THRU Tx54) 24' ROADWAY

SIG-24

FILE: IG-SIG2400-24.dgn	DN: JMH	CK: NRN	DW: JTR	CK: TAR
© TxDOT August 2017	CONT	SECT	JOB	HIGHWAY
REVISIONS				
10-19: Increased "X" and "Y" values				
01-23: Removed PCP(D) reference				
11-24: Flipped top mat				
DIST	COUNTY	SHEET NO.		

DATE: FILE:

TABLE OF DEAD LOAD DEFLECTIONS

TYPE Tx28 GIRDERS		
SPAN LENGTH	"A"	"B"
Ft	Ft	Ft
40	0.007	0.010
45	0.012	0.017
50	0.019	0.027
55	0.028	0.040
60	0.041	0.057
65	0.056	0.079
70	0.077	0.108
75	0.102	0.143

TYPE Tx34 GIRDERS		
SPAN LENGTH	"A"	"B"
Ft	Ft	Ft
40	0.004	0.006
45	0.007	0.010
50	0.011	0.016
55	0.017	0.024
60	0.024	0.034
65	0.033	0.047
70	0.046	0.064
75	0.061	0.085
80	0.079	0.111
85	0.102	0.143

TYPE Tx40 GIRDERS		
SPAN LENGTH	"A"	"B"
Ft	Ft	Ft
40	0.003	0.004
45	0.005	0.007
50	0.007	0.010
55	0.011	0.016
60	0.016	0.022
65	0.022	0.031
70	0.030	0.042
75	0.040	0.056
80	0.052	0.073
85	0.066	0.093
90	0.084	0.118
95	0.105	0.147
100	0.130	0.182

TYPE Tx46 GIRDERS		
SPAN LENGTH	"A"	"B"
Ft	Ft	Ft
40	0.002	0.003
45	0.004	0.005
50	0.005	0.007
55	0.008	0.011
60	0.011	0.015
65	0.015	0.021
70	0.021	0.029
75	0.027	0.038
80	0.036	0.050
85	0.046	0.064
90	0.057	0.080
95	0.071	0.100
100	0.088	0.124
105	0.108	0.151
110	0.130	0.182
115	0.156	0.219

TYPE Tx54 GIRDERS		
SPAN LENGTH	"A"	"B"
Ft	Ft	Ft
40	0.001	0.002
45	0.002	0.003
50	0.004	0.005
55	0.005	0.007
60	0.007	0.010
65	0.010	0.014
70	0.014	0.019
75	0.018	0.025
80	0.024	0.033
85	0.030	0.042
90	0.038	0.053
95	0.047	0.066
100	0.058	0.082
105	0.071	0.100
110	0.086	0.121
115	0.103	0.144
120	0.123	0.172
125	0.145	0.203

SPAN LENGTH	"A"	"B"	"C"	"D"	"E"
40	1,040	158.00	158.00	158.00	2,392
45	1,170	178.00	178.00	178.00	2,691
50	1,300	198.00	198.00	198.00	2,990
55	1,430	218.00	218.00	218.00	3,289
60	1,560	238.00	238.00	238.00	3,588
65	1,690	258.00	258.00	258.00	3,887
70	1,820	278.00	278.00	278.00	4,186
75	1,950	298.00	298.00	298.00	4,485
80	2,080	318.00	318.00	318.00	4,784
85	2,210	338.00	338.00	338.00	5,083
90	2,340	358.00	358.00	358.00	5,382
95	2,470	378.00	378.00	378.00	5,681
100	2,600	398.00	398.00	398.00	5,980
105	2,730	418.00	418.00	418.00	6,279
110	2,860	438.00	438.00	438.00	6,578
115	2,990	458.00	458.00	458.00	6,877
120	3,120	478.00	478.00	478.00	7,176
125	3,250	498.00	498.00	498.00	7,475

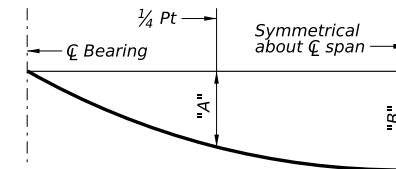

DEAD LOAD DEFLECTION DIAGRAM

Calculated deflections shown are due to the concrete slab on interior girders only ($E_c = 5000$ ksi). Adjust values as required for exterior girders and if optional slab forming is used. These values may require field verification.

- ④ Fabricator will adjust lengths for girder slopes as required.
- ⑤ Reinforcing steel weight is calculated using an approximate factor of 2.3 lbs/SF.

MATERIAL NOTES:

GENERAL NOTES:

See I-Girder Thickened Slab En and quantity adjustments.
 See Prestressed Concrete Panels (PCP) standard and Prestressed Concrete Panel Fabrication Details (PCP-FAB) standard for panel details not shown.
 See I-Girder Miscellaneous Slab Details (IGMS) standard for miscellaneous details.
 See applicable rail details for rail anchorage in slab.
 See Permanent Metal Deck Forms (PMDF) standard for details and quantity adjustments if this option is used.
 This standard does not support the use of transition bents.

Cover dimensions are clear dimensions, unless noted otherwise.

HL93 LOADING

SHEET 2 OF 2



PRESTRESSED CONCRETE I-GIRDER SPANS (TYPE Tx28 THRU Tx54) 24' ROADWAY

SIG-24

FILE:	DN: JMH	CK: NRN	DW: JTR	CK: TAR
© TXDOT August 2017	CONT	SECT	JOB	HIGHWAY
REVISIONS				
10-19: Increased "X" and "Y" values				
01-23: Removed PCP(D) reference				
11-24: Flipped top mat				
DIST	COUNTY			SHEET NO.

DATE:
FILE: