

DISCLAIMER: The use of this standard is governed by the "Texas Engineering Practice Act". No warranty of any kind is made by TxDOT for any purpose whatsoever. TxDOT assumes no responsibility for the conversion of this standard to other formats or for incorrect results or damages resulting from its use.

DATE: FILE:

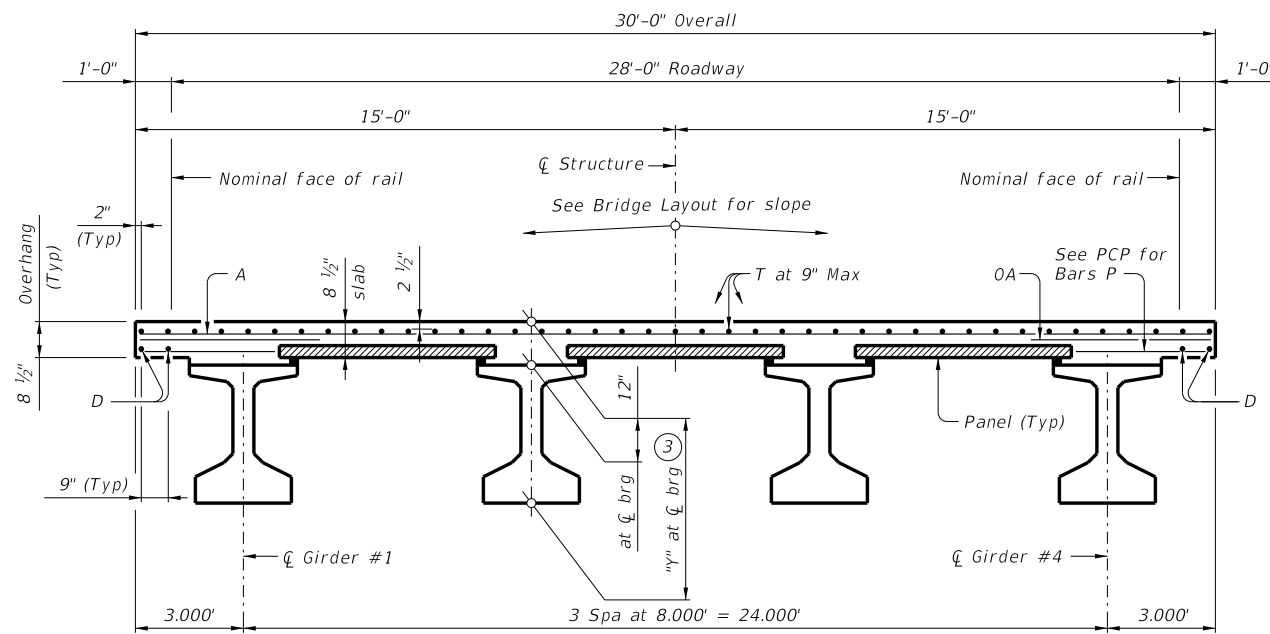
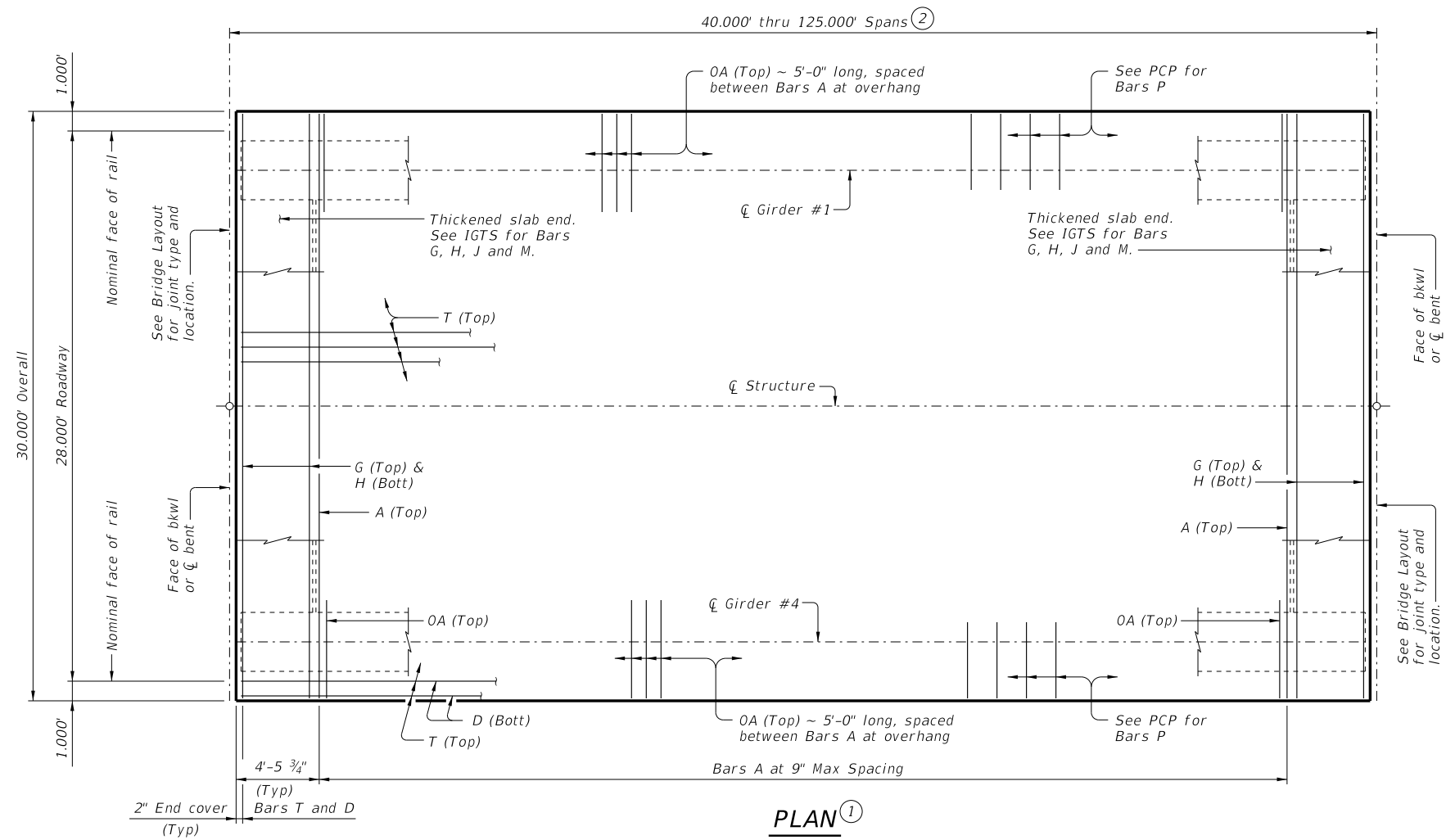

TYPICAL TRANSVERSE SECTION  
(Showing girder type Tx46)

TABLE OF SECTION DEPTHS	
GIRDER TYPE	"Y" AT $\phi$ BRG (3)
	Ft/In
Tx28	3'-4"
Tx34	3'-10"
Tx40	4'-4"
Tx46	4'-10"
Tx54	5'-6"

BAR TABLE

BAR	SIZE
A	#4
D	#4
G	#4
H	#4
J	#4
M	#4
OA	#5
P	#4
T	#4

- If multi-span units (with slab continuous over interior bents) are indicated on the Bridge Layout, see standard IGCS for adjustment to slab reinforcement and quantities.
- Span lengths for prestressed concrete I-Girder Type:  
 Type Tx28 for spans lengths 40.000' thru 70.000'.  
 Type Tx34 for spans lengths 40.000' thru 85.000'.  
 Type Tx40 for spans lengths 40.000' thru 95.000'.  
 Type Tx46 for spans lengths 40.000' thru 105.000'.  
 Type Tx54 for spans lengths 40.000' thru 125.000'.
- "Y" value shown is based on theoretical girder camber, dead load deflection from an 8 1/2" concrete slab, a constant roadway grade, and using precast panels (PCP). The Contractor will adjust this value as necessary for any roadway vertical curve.

HL93 LOADING SHEET 1 OF 2



PRESTRESSED CONCRETE I-GIRDER SPANS  
(TYPE Tx28 THRU Tx54)  
28' ROADWAY

SIG-28

FILE: IG-SIG2800-23.dgn	DN: JMH	CK: NRN	DW: JTR	CK: TAR
©TxDOT August 2017	CONT	SECT	JOB	HIGHWAY
REVISIONS				
10-19: Increased "X" and "Y" Values.	DIST	COUNTY	SHEET NO.	
01-23: Removed PCP() reference.				

TABLE OF DEAD LOAD DEFLECTIONS

TYPE T <sub>x</sub> 28 GIRDERS			TYPE T <sub>x</sub> 34 GIRDERS			TYPE T <sub>x</sub> 40 GIRDERS			TYPE T <sub>x</sub> 46 GIRDERS			TYPE T <sub>x</sub> 54 GIRDERS		
SPAN LENGTH	"A"	"B"	SPAN LENGTH	"A"	"B"	SPAN LENGTH	"A"	"B"	SPAN LENGTH	"A"	"B"	SPAN LENGTH	"A"	"B"
Ft	Ft	Ft	Ft	Ft	Ft	Ft	Ft	Ft	Ft	Ft	Ft	Ft	Ft	Ft
40	0.009	0.013	40	0.006	0.008	40	0.004	0.005	40	0.002	0.003	40	0.001	0.002
45	0.015	0.021	45	0.009	0.012	45	0.006	0.008	45	0.004	0.006	45	0.003	0.004
50	0.024	0.033	50	0.014	0.019	50	0.009	0.013	50	0.006	0.009	50	0.004	0.006
55	0.034	0.048	55	0.020	0.028	55	0.014	0.019	55	0.009	0.013	55	0.006	0.008
60	0.048	0.068	60	0.029	0.041	60	0.019	0.027	60	0.013	0.018	60	0.009	0.012
65	0.068	0.095	65	0.041	0.057	65	0.026	0.037	65	0.018	0.025	65	0.012	0.017
70	0.092	0.129	70	0.055	0.077	70	0.036	0.050	70	0.024	0.034	70	0.016	0.023
			75	0.073	0.102	75	0.048	0.067	75	0.033	0.046	75	0.021	0.030
			80	0.095	0.134	80	0.062	0.087	80	0.043	0.060	80	0.028	0.039
			85	0.122	0.171	85	0.080	0.112	85	0.054	0.076	85	0.036	0.050
						90	0.101	0.142	90	0.068	0.096	90	0.046	0.064
						95	0.126	0.177	95	0.085	0.120	95	0.057	0.080
									100	0.105	0.148	100	0.070	0.098
									105	0.129	0.181	105	0.085	0.120
									110			110	0.103	0.145
									115			115	0.123	0.173
									120			120	0.147	0.206
									125			125	0.173	0.243

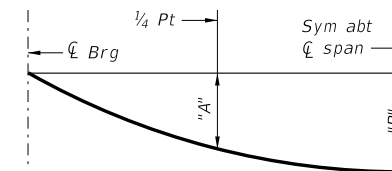

TABLE OF ESTIMATED QUANTITIES

SPAN LENGTH	REINF CONCRETE SLAB	Prestressed Concrete Girders			TOTAL REINF STEEL <sup>5</sup>
		ABUT TO INT BT <sup>4</sup>	INT BT TO INT BT <sup>4</sup>	ABUT TO ABUT <sup>4</sup>	
Ft	SF	LF	LF	LF	Lb
40	1,200	158.00	158.00	158.00	2,760
45	1,350	178.00	178.00	178.00	3,105
50	1,500	198.00	198.00	198.00	3,450
55	1,650	218.00	218.00	218.00	3,795
60	1,800	238.00	238.00	238.00	4,140
65	1,950	258.00	258.00	258.00	4,485
70	2,100	278.00	278.00	278.00	4,830
75	2,250	298.00	298.00	298.00	5,175
80	2,400	318.00	318.00	318.00	5,520
85	2,550	338.00	338.00	338.00	5,865
90	2,700	358.00	358.00	358.00	6,210
95	2,850	378.00	378.00	378.00	6,555
100	3,000	398.00	398.00	398.00	6,900
105	3,150	418.00	418.00	418.00	7,245
110	3,300	438.00	438.00	438.00	7,590
115	3,450	458.00	458.00	458.00	7,935
120	3,600	478.00	478.00	478.00	8,280
125	3,750	498.00	498.00	498.00	8,625

- Fabricator will adjust lengths for girder slopes as required.
- Reinforcing steel weight is calculated using an approximate factor of 2.3 Lbs/SF.

MATERIAL NOTES:

GENERAL NOTES:

Specific  
 Multi-span units, with slab continuous over interior bents, may be formed with the details shown on this sheet and the I-Girder Continuous Slab Detail (IGCS) standard.  
 See I-Girder Thickened Slab End Details (IGTS) standard for details and quantity adjustments.  
 See Prestressed Concrete Panels (PCP) standard and Prestressed Concrete Panel Fabrication Details (PCP-FAB) standard for panel details not shown.  
 See I-Girder Miscellaneous Slab Details (IGMS) standard for miscellaneous details.  
 See applicable rail details for rail anchorage in slab.  
 See Permanent Metal Deck Forms (PMDF) standard for details and quantity adjustments if this option is used.  
 This standard does not support the use of transition bents.

Cover dimensions are clear dimensions, unless noted otherwise.

<p><b>PRESTRESSED CONCRETE I-GIRDER SPANS (TYPE T<sub>x</sub>28 THRU T<sub>x</sub>54) 28' ROADWAY</b></p> <p><b>SIG-28</b></p>				
FILE:	DN: JMH	CK: NRM	DW: JTR	CK: TAR
©TxDOT	CONT	SECT	JOB	HIGHWAY
REVISIONS	DIST		COUNTY	SHEET NO.