

DISCLAIMER: The use of this standard is governed by the "Texas Engineering Practice Act." No warranty of any kind is made by TxDOT for any purpose whatsoever. TxDOT assumes no responsibility for the conversion of this standard to other formats or for incorrect results or damages resulting from its use.

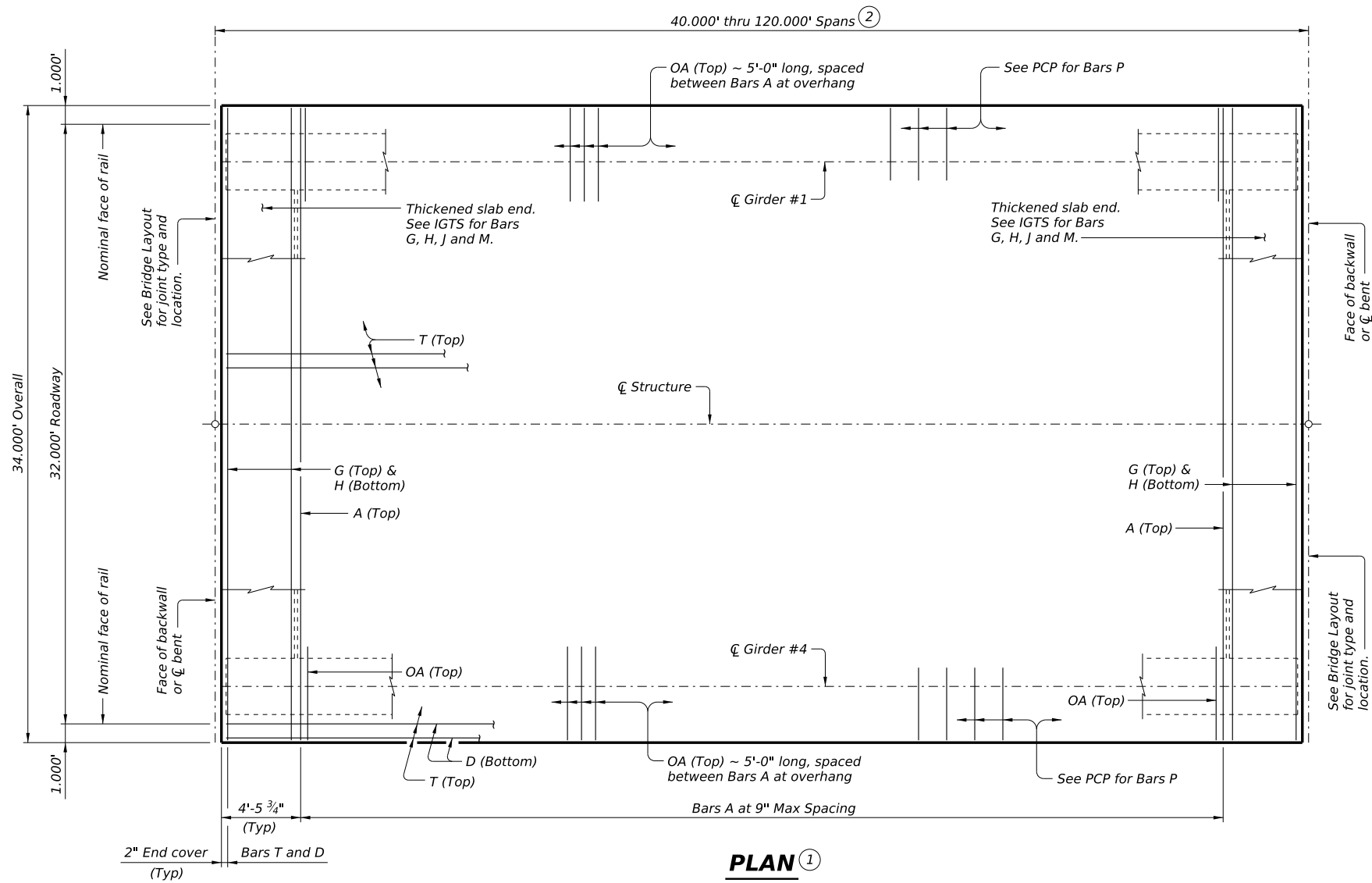

PLAN ①

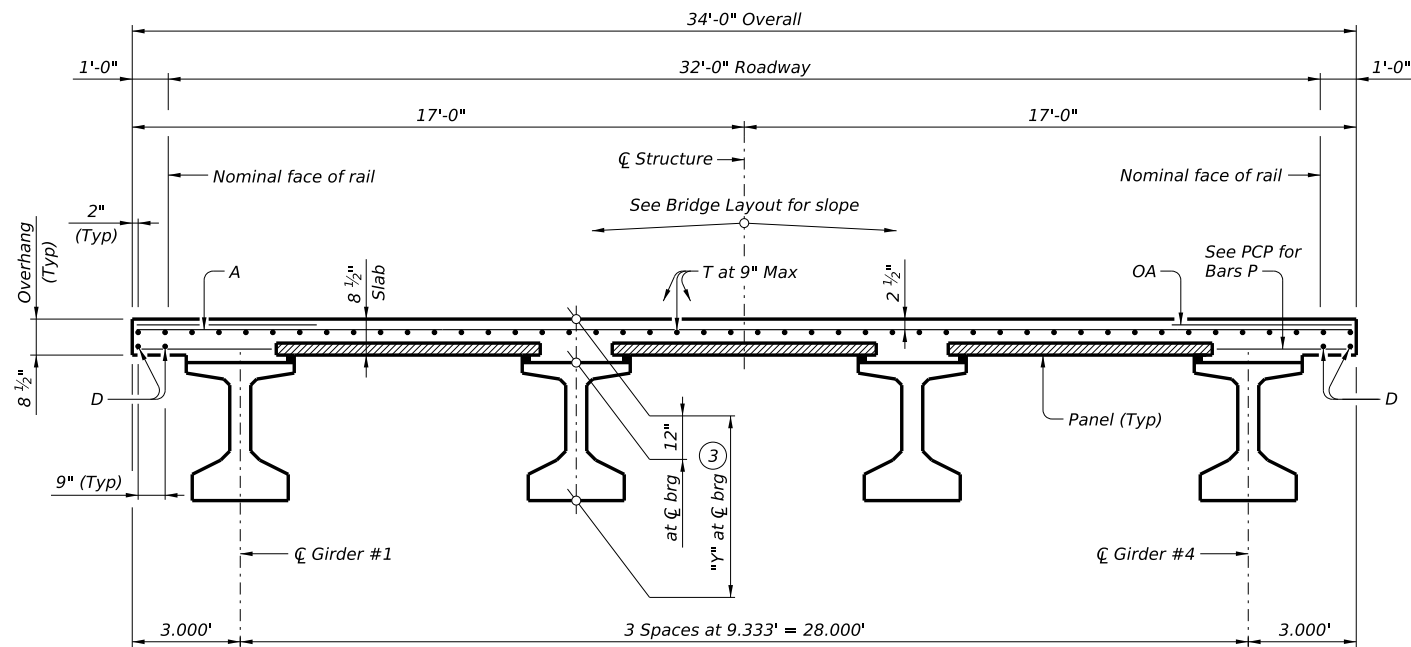

TYPICAL TRANSVERSE SECTION
(Showing girder type Tx46)

TABLE OF SECTION DEPTHS	
GIRDER TYPE	"Y" AT \bar{C} BRG ③
	Ft/In
Tx28	3'-4"
Tx34	3'-10"
Tx40	4'-4"
Tx46	4'-10"
Tx54	5'-6"

BAR TABLE

BAR	SIZE
A	#4
D	#4
G	#4
H	#4
J	#4
M	#4
OA	#5
P	#4
T	#4

- ① If multi-span units (with slab continuous over interior bents) are indicated on the Bridge Layout, see standard IGCS for adjustment to slab reinforcement and quantities.
- ② Span lengths for prestressed concrete I-Girder type:
Type Tx28 for spans lengths 40.000' thru 65.000'.
Type Tx34 for spans lengths 40.000' thru 80.000'.
Type Tx40 for spans lengths 40.000' thru 90.000'.
Type Tx46 for spans lengths 40.000' thru 100.000'.
Type Tx54 for spans lengths 40.000' thru 120.000'.
- ③ "Y" value shown is based on theoretical girder camber, dead load deflection from an 8 1/2" concrete slab, a constant roadway grade, and using precast panels (PCP). The Contractor will adjust this value as necessary for any roadway vertical curve.

HL93 LOADING SHEET 1 OF 2



PRESTRESSED CONCRETE I-GIRDER SPANS (TYPE Tx28 THRU Tx54) 32' ROADWAY

SIG-32

FILE: IG-SIG3200-24.dgn	DN: JMH	CK: ASB	DW: JTR	CK: TAR
© TxDOT August 2017	CONT	SECT	JOB	HIGHWAY
REVISIONS				
10-19: Increased "X" and "Y" values				
01-23: Removed PCP(O) reference				
11-24: Flipped top mat				
DIST	COUNTY	SHEET NO.		

DATE: FILE:

DISCLAIMER: The use of this standard is governed by the "Texas Engineering Practice Act." No warranty of any kind is made by TxDOT for any purpose whatsoever. TxDOT assumes no responsibility for the conversion of this standard to other formats or for incorrect results or damages resulting from its use.

TABLE OF DEAD LOAD DEFLECTIONS

TYPE Tx28 GIRDERS			TYPE Tx34 GIRDERS			TYPE Tx40 GIRDERS			TYPE Tx46 GIRDERS			TYPE Tx54 GIRDERS		
SPAN LENGTH	"A"	"B"	SPAN LENGTH	"A"	"B"	SPAN LENGTH	"A"	"B"	SPAN LENGTH	"A"	"B"	SPAN LENGTH	"A"	"B"
Ft	Ft	Ft	Ft	Ft	Ft	Ft	Ft	Ft	Ft	Ft	Ft	Ft	Ft	Ft
40	0.011	0.015	40	0.006	0.009	40	0.004	0.006	40	0.003	0.004	40	0.002	0.003
45	0.017	0.024	45	0.010	0.014	45	0.006	0.009	45	0.004	0.006	45	0.003	0.004
50	0.026	0.037	50	0.016	0.022	50	0.011	0.015	50	0.007	0.010	50	0.005	0.007
55	0.040	0.056	55	0.024	0.033	55	0.016	0.022	55	0.011	0.015	55	0.007	0.010
60	0.057	0.080	60	0.034	0.048	60	0.022	0.031	60	0.015	0.021	60	0.010	0.014
65	0.079	0.111	65	0.047	0.066	65	0.031	0.043	65	0.021	0.030	65	0.014	0.020
			70	0.064	0.090	70	0.042	0.059	70	0.028	0.040	70	0.019	0.027
			75	0.085	0.120	75	0.056	0.078	75	0.038	0.053	75	0.025	0.035
			80	0.111	0.156	80	0.073	0.102	80	0.049	0.069	80	0.033	0.046
						85	0.093	0.131	85	0.063	0.089	85	0.042	0.059
						90	0.118	0.165	90	0.080	0.113	90	0.053	0.074
									95	0.100	0.140	95	0.066	0.093
									100	0.123	0.173	100	0.081	0.114
									105	0.100	0.140	105	0.100	0.140
									110	0.120	0.169	110	0.120	0.169
									115	0.144	0.202	115	0.144	0.202
									120	0.172	0.241	120	0.172	0.241

TABLE OF ESTIMATED QUANTITIES

SPAN LENGTH	REINF CONCRETE SLAB	Prestressed Concrete Girders			TOTAL REINF STEEL
		ABUT TO INT BT	INT BT TO INT BT	ABUT TO ABUT	
Ft	SF	LF	LF	LF	Lb
40	1,360	158.00	158.00	158.00	3,128
45	1,530	178.00	178.00	178.00	3,519
50	1,700	198.00	198.00	198.00	3,910
55	1,870	218.00	218.00	218.00	4,301
60	2,040	238.00	238.00	238.00	4,692
65	2,210	258.00	258.00	258.00	5,083
70	2,380	278.00	278.00	278.00	5,474
75	2,550	298.00	298.00	298.00	5,865
80	2,720	318.00	318.00	318.00	6,256
85	2,890	338.00	338.00	338.00	6,647
90	3,060	358.00	358.00	358.00	7,038
95	3,230	378.00	378.00	378.00	7,429
100	3,400	398.00	398.00	398.00	7,820
105	3,570	418.00	418.00	418.00	8,211
110	3,740	438.00	438.00	438.00	8,602
115	3,910	458.00	458.00	458.00	8,993
120	4,080	478.00	478.00	478.00	9,384

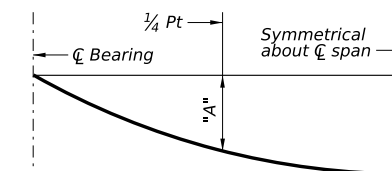

DEAD LOAD DEFLECTION DIAGRAM

Calculated deflections shown are due to the concrete slab on interior girders only (Ec = 5000 ksi). Adjust values as required for exterior girders and if optional slab forming is used. These values may require field verification.

- ④ Fabricator will adjust lengths for girder slopes as required.
- ⑤ Reinforcing steel weight is calculated using an approximate factor of 2.3 lbs/SF.

MATERIAL NOTES:
 Provide Class S concrete (f'c = 4,000 psi).
 Provide Class S (HPC) concrete if shown elsewhere in the plans.
 Provide Grade 60 reinforcing steel.
 Provide bar laps, where required, as follows:
 Uncoated ~ #4 = 1'-7"
 Epoxy coated ~ #4 = 2'-5"
 Deformed welded wire reinforcement (WWR) (ASTM A1064) of equal size and spacing may be substituted for Bars A, D, OA, P or T unless noted otherwise.

GENERAL NOTES:
 Designed according to AASHTO LRFD Bridge Design Specifications.
 Multi-span units, with slab continuous over interior bents, may be formed with the details shown on this sheet and the I-Girder Continuous Slab Detail (IGCS) standard.
 See I-Girder Thickened Slab End Details (IGTS) standard for details and quantity adjustments.
 See Prestressed Concrete Panels (PCP) standard and Prestressed Concrete Panel Fabrication Details (PCP-FAB) standard for panel details not shown.
 See I-Girder Miscellaneous Slab Details (IGMS) standard for miscellaneous details.
 See applicable rail details for rail anchorage in slab.
 See Permanent Metal Deck Forms (PMDf) standard for details and quantity adjustments if this option is used.
 This standard does not support the use of transition bents.

Cover dimensions are clear dimensions, unless noted otherwise.

PRESTRESSED CONCRETE I-GIRDER SPANS (TYPE Tx28 THRU Tx54) 32' ROADWAY

SIG-32

FILE: IG-SIG3200-24.dgn	DN: JMH	CK: ASB	DW: JTR	CK: TAR
©TxDOT August 2017	CONT	SECT	JOB	HIGHWAY
REVISIONS 10-19: Increased "X" and "Y" values 01-23: Removed PCP(O) reference 11-24: Flipped top mat	DIST	COUNTY	SHEET NO.	

DATE:
FILE: