

DISCLAIMER: This standard is governed by the "Texas Engineering Practice Act". No warranty of any kind is made by TxDOT for any purpose whatsoever. TxDOT assumes no responsibility for the conversion of this standard to other formats or for incorrect results or damages resulting from its use.

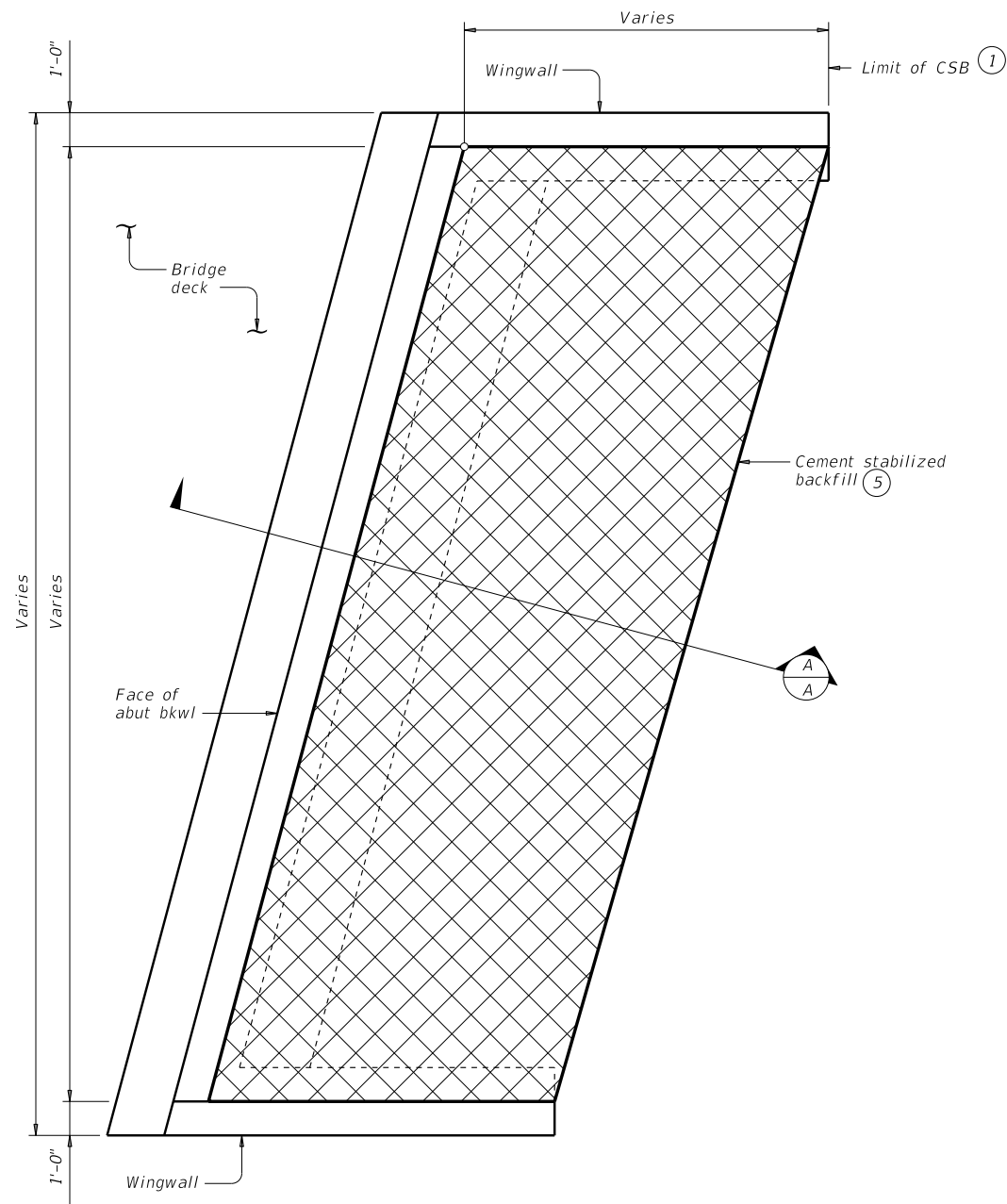

OPTION 1 ~ PLAN WITH WINGWALLS

Cast-in-place retaining walls similar.

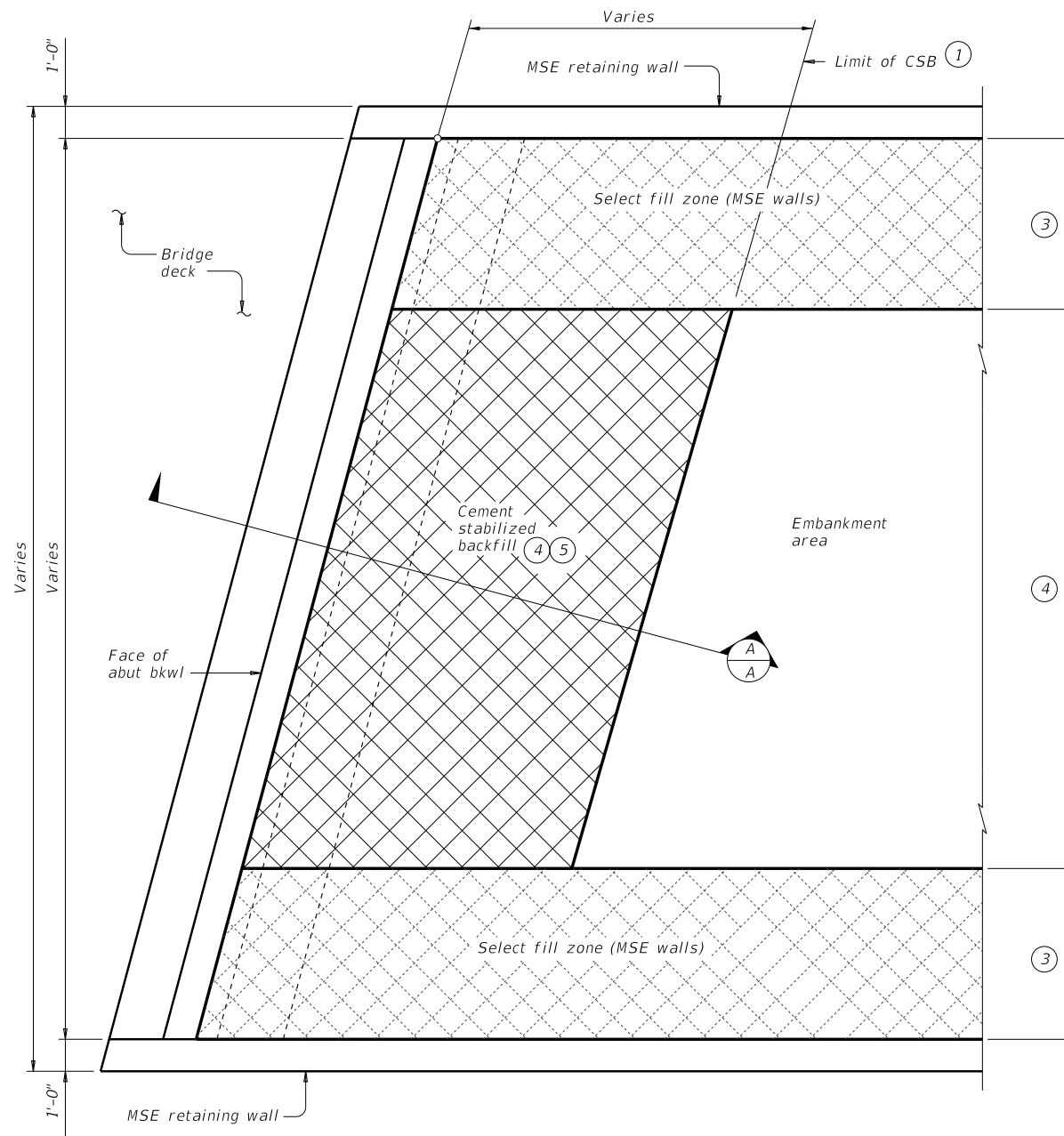

OPTION 1 ~ PLAN WITH MSE RETAINING WALLS

- ① Usual limit of Cement Stabilized Backfill is at end of wingwall. Extend CSB limits as required to maintain a slope no steeper than 1:1 at bottom of backfill.
- ② Bench backfill as shown with 12" (approximate) bench depths.
- ③ Where MSE retaining walls are present, adjust CSB limits to accommodate the select fill zone. See retaining wall details for additional information.
- ④ When distance between select fill zones is less than 5'-0", MSE select fill may be substituted for cement stabilized backfill with approval from the Engineer.
- ⑤ If shown in the plans, flowable backfill can be used as a substitute for cement stabilized backfill with the following constraints:
 - a) If flowable backfill is to be placed over MSE backfill, then a filter fabric will be placed over the MSE backfill prior to placement of the flowable fill; and
 - b) Place flowable fill in lifts not exceeding 2 feet in height. Place each successive lift when the previous lift has stiffened/hardened (i.e. has lost its flowability).

GENERAL NOTES:

See the Bridge Layout for selected Option. Option 1 is intended for construction only requiring plasticity index (PI) controlled embankment fill or excavation in competent soils/rocks in order to construct the abutment. Option 2 is intended for new construction requiring high plasticity embankment fill with a PI greater than 30 or pavement built in poor native soil. Poor soils are defined as high plasticity clays or expansive clays.

Construct abutment backfill in accordance with Item 400, "Excavation and Backfill for Structures".

Provide Cement Stabilized Backfill (CSB) meeting the requirements of Item 400, "Excavation and Backfill for Structures", to the limits shown at bridge abutments.

If required elsewhere in the plans, provide Flowable Backfill meeting the requirements of Item 401, "Flowable Backfill", to the limits shown at bridge abutments.

Details are drawn showing left forward skew. See Bridge Layout for actual skew direction.

These details do not apply when Concrete Block retaining walls are used in lieu of wingwalls.

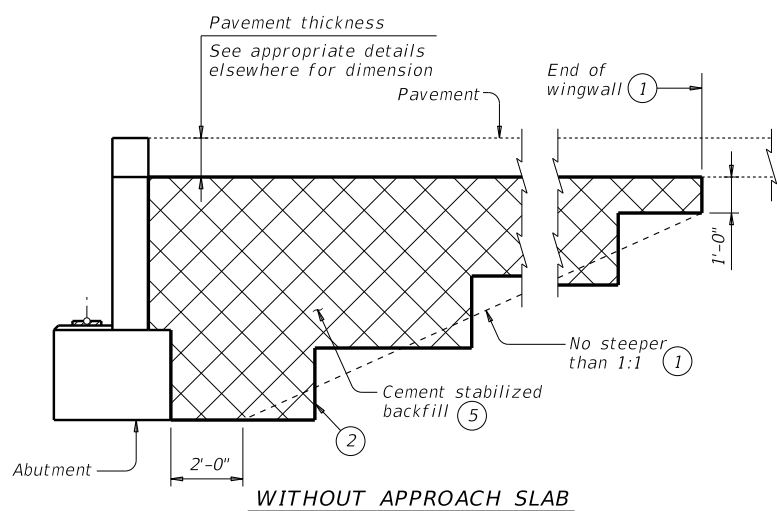

WITHOUT APPROACH SLAB

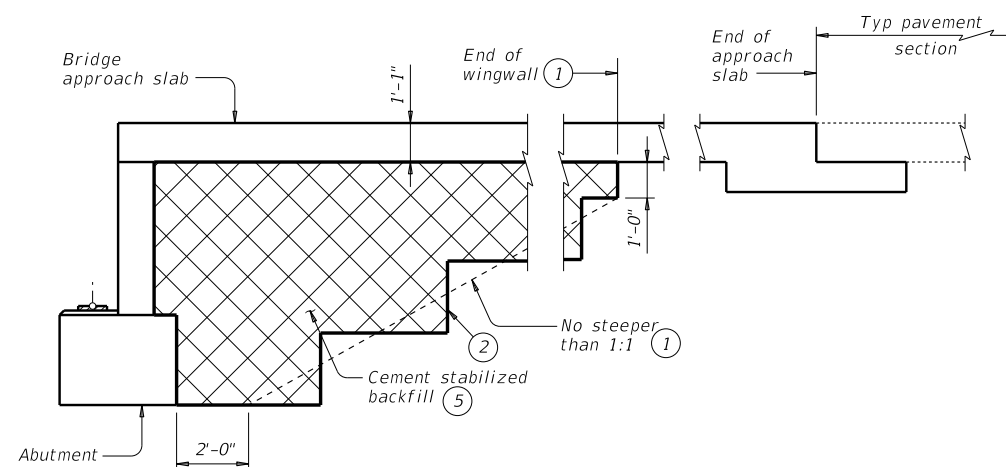

WITH APPROACH SLAB
(Showing BAS-C, BAS-A similar.)

SECTION A-A

SHEET 1 OF 2



CEMENT STABILIZED ABUTMENT BACKFILL BRIDGE ABUTMENT

CSAB

FILE: MS-CSAB-23.dgn	DN: TxDOT	CK: TxDOT	DW: TxDOT	CK: TxDOT
©TxDOT April 2019	CONT	SECT	JOB	HIGHWAY
REVISIONS				
02-20: Added Option 2.	DIST	COUNTY	SHEET NO.	
03-23: Updated General Notes.				

DATE: FILE:

DISCLAIMER: This standard is governed by the "Texas Engineering Practice Act". No warranty of any kind is made by TxDOT for any purpose whatsoever. TxDOT assumes no responsibility for the conversion of this standard to other formats or for incorrect results or damages resulting from its use.

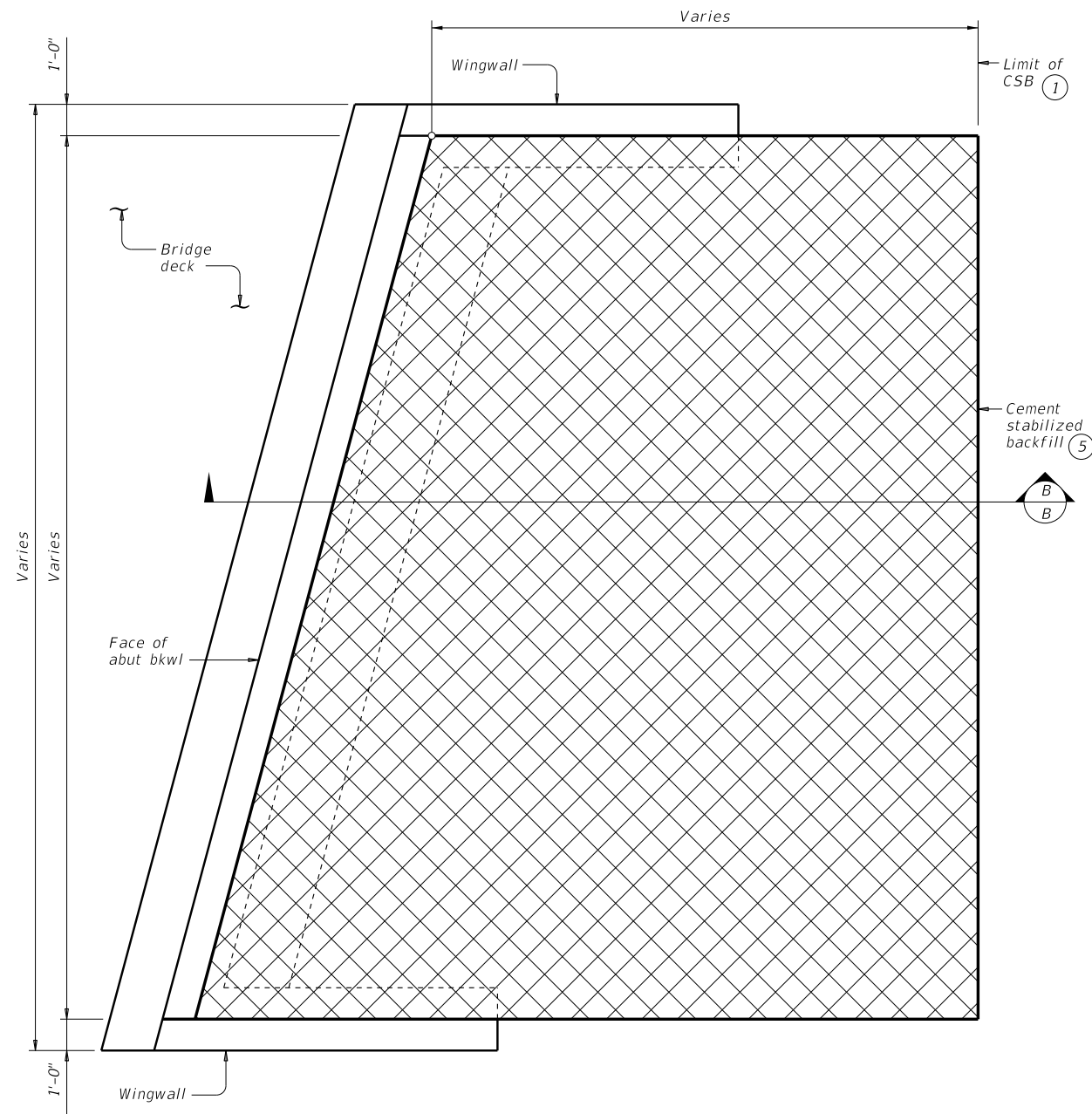

OPTION 2 ~ PLAN WITH WINGWALLS

Cast-in-place retaining walls similar.

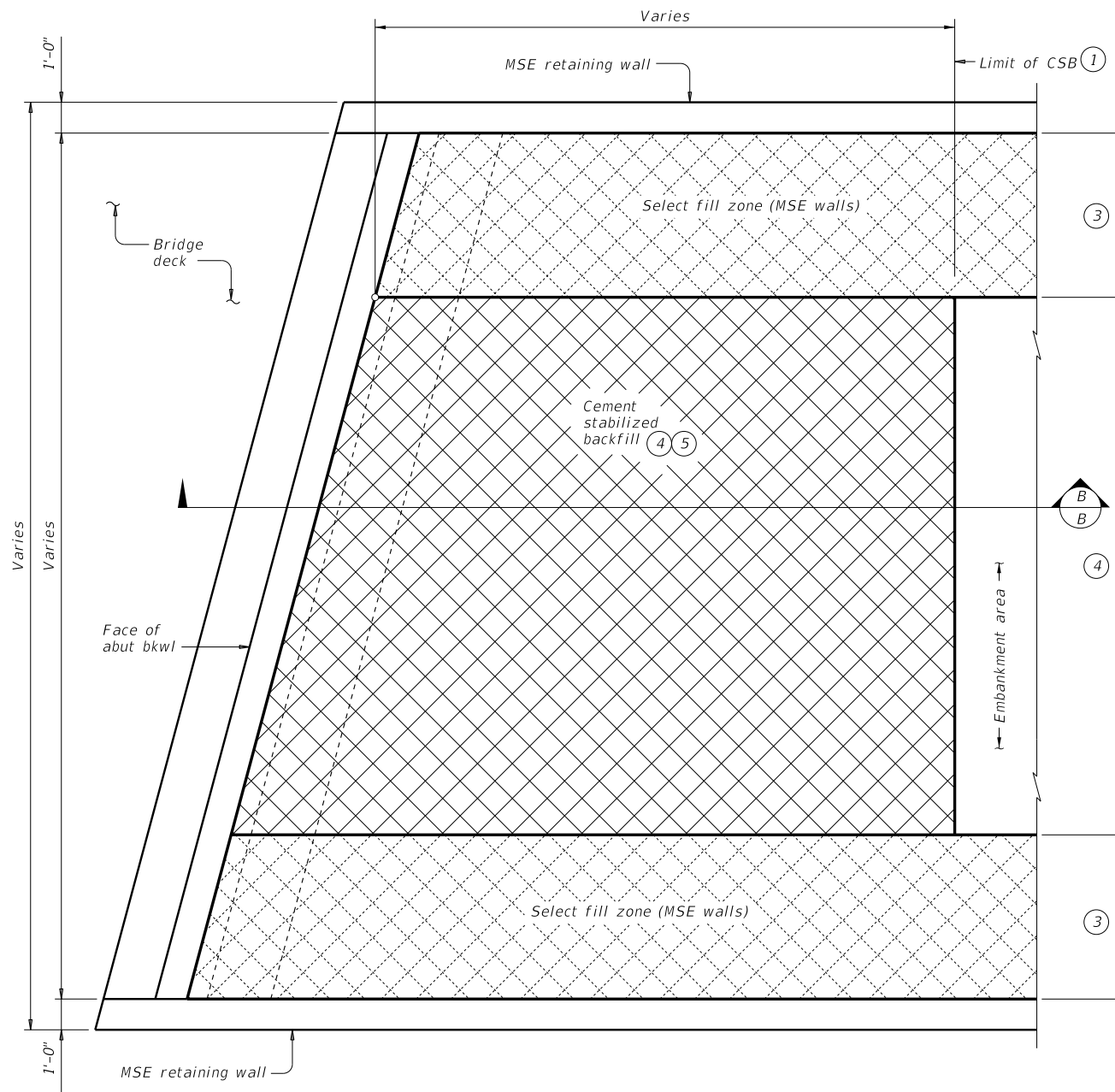

OPTION 2 ~ PLAN WITH MSE RETAINING WALLS

- ① Usual limit of Cement Stabilized Backfill is at end of wingwall. Extend CSB limits as required to maintain a slope no steeper than 1:1 at bottom of backfill.
- ② Bench backfill as shown with 12" (approximate) bench depths.
- ③ Where MSE retaining walls are present, adjust CSB limits to accommodate the select fill zone. See retaining wall details for additional information.
- ④ When distance between select fill zones is less than 5'-0", MSE select fill may be substituted for cement stabilized backfill with approval from the Engineer.
- ⑤ If shown in the plans, flowable backfill can be used as a substitute for cement stabilized backfill with the following constraints:
 - a). If flowable backfill is to be placed over MSE backfill, then a filter fabric will be placed over the MSE backfill prior to placement of the flowable fill; and
 - b). Place flowable fill in lifts not exceeding 2 feet in height. Place each successive lift when the previous lift has stiffened/hardened (i.e. has lost its flowability).
- ⑥ 1'-0" for BAS-A
1'-10" for BAS-C

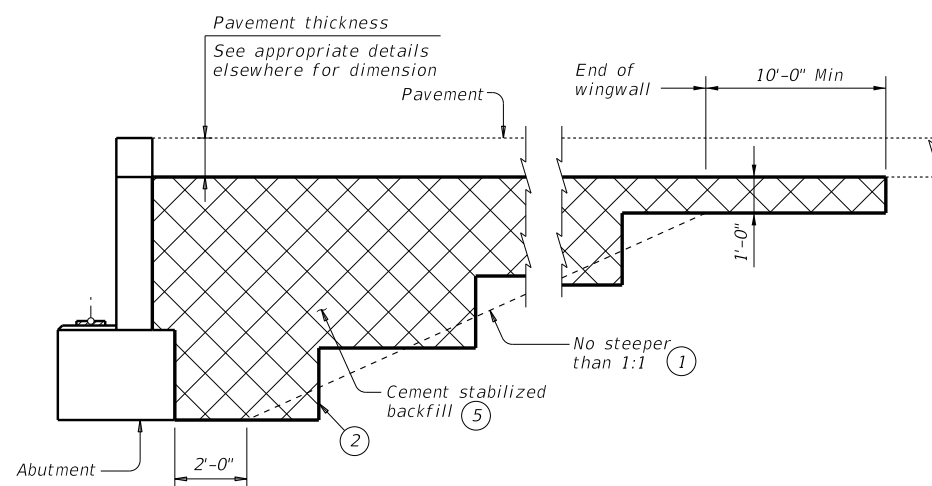

WITHOUT APPROACH SLAB

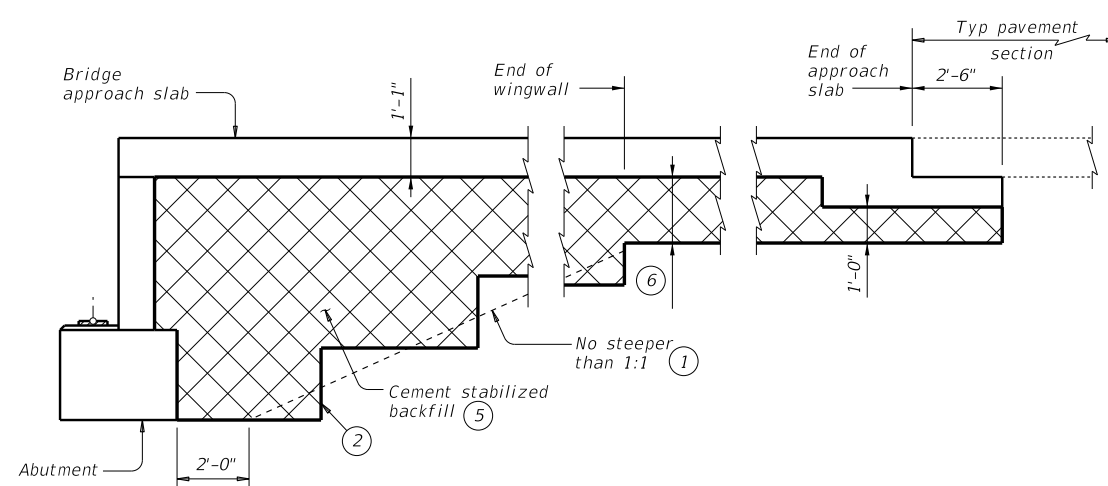

SECTION B-B

WITH APPROACH SLAB
(Showing BAS-C, BAS-A similar.)

SHEET 2 OF 2



**CEMENT STABILIZED
ABUTMENT BACKFILL
BRIDGE ABUTMENT**

CSAB

FILE: MS-CSAB-23.dgn	DN: TxDOT	CK: TxDOT	DW: TxDOT	CK: TxDOT
©TxDOT April 2019	CONT	SECT	JOB	HIGHWAY
REVISIONS				
02-20: Added Option 2.				
03-23: Updated General Notes.				
	DIST	COUNTY		SHEET NO.

DATE:
FILE: