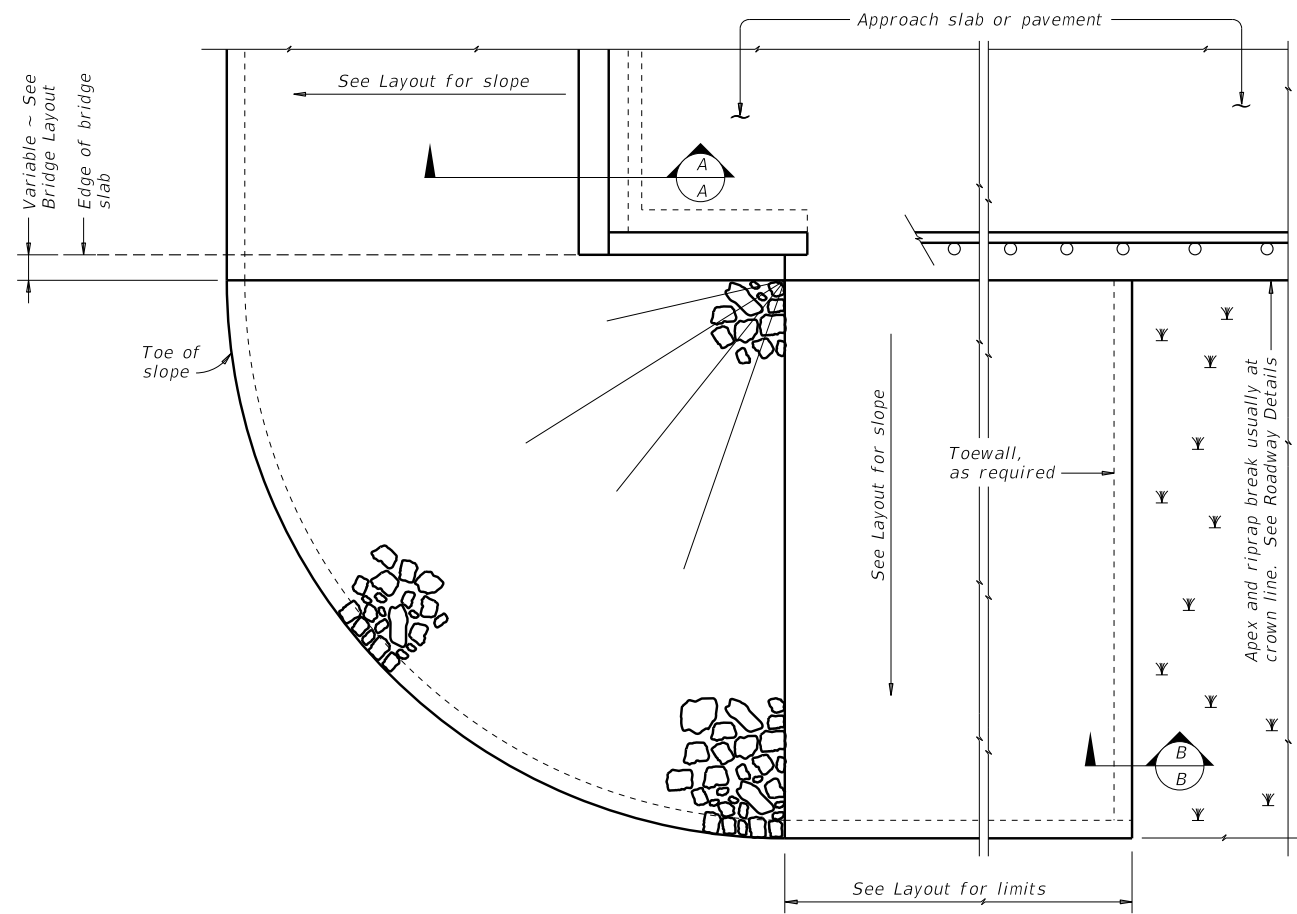
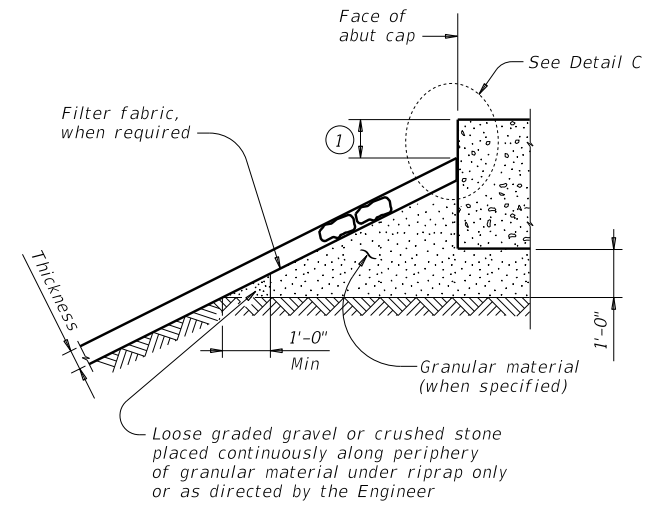


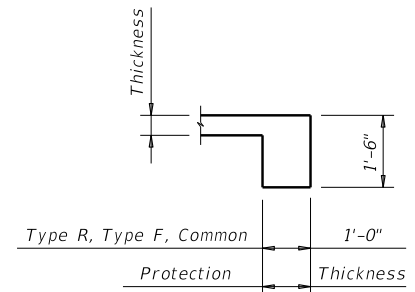
DISCLAIMER: This standard is governed by the "Texas Engineering Practice Act". No warranty of any kind is made by TxDOT for any purpose whatsoever. The use of this standard for the conversion of this standard to other formats or for incorrect results or damages resulting from its use. TxDOT assumes no responsibility for the conversion of this standard to other formats or for incorrect results or damages resulting from its use.



**PLAN**

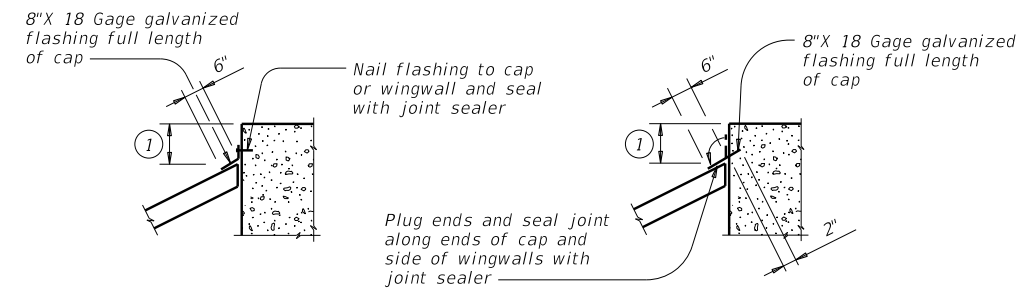


**SECTION A-A AT CAP**



**SECTION B-B**

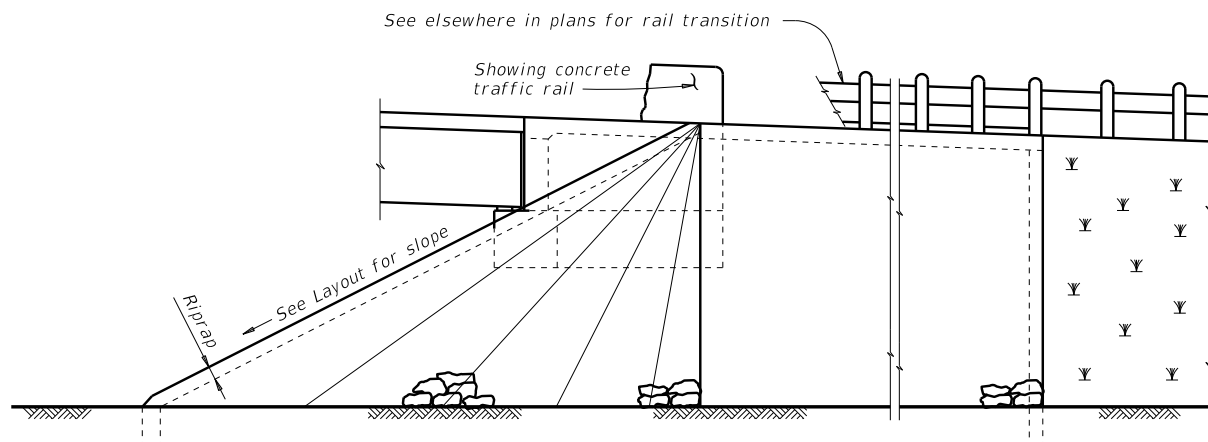
Provide toewall when shoulder drain is located adjacent to limits of stone riprap. Omit toewall when thickness of protection riprap is greater than 18".



**CAP OPTION A**

**CAP OPTION B**

**DETAIL C**



**ELEVATION**

① Top of cap to top of riprap dimension varies as directed by the Engineer. Provide 9" Min for beam/slab type bridges and 1'-6" for slab span, box beam, or slab beam bridges.

**GENERAL NOTES:**

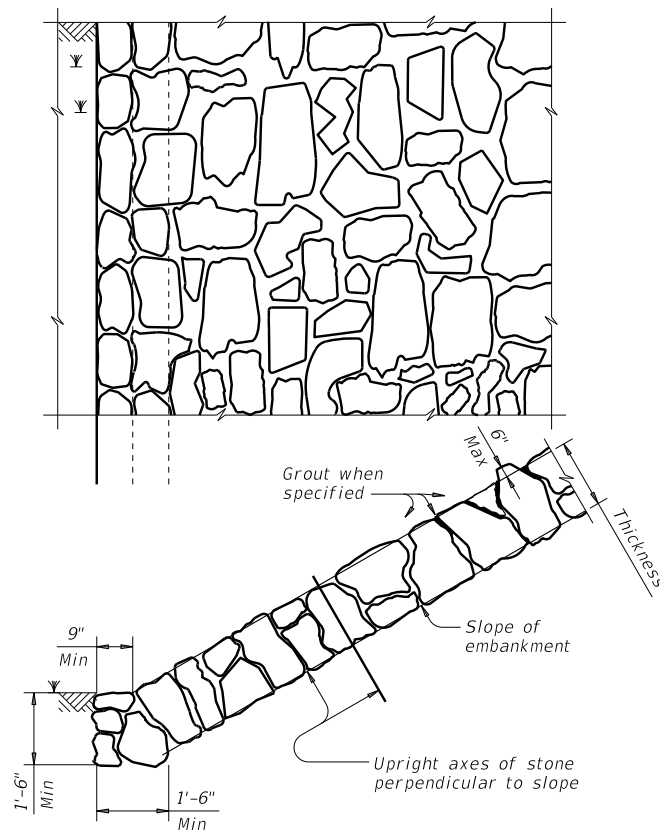
Refer to Item 432, "Riprap" for stone size and gradation, and construction details. See Layout for limits and thickness of riprap specified.  
See elsewhere in plans for locations and details of shoulder drains.

SHEET 1 OF 2

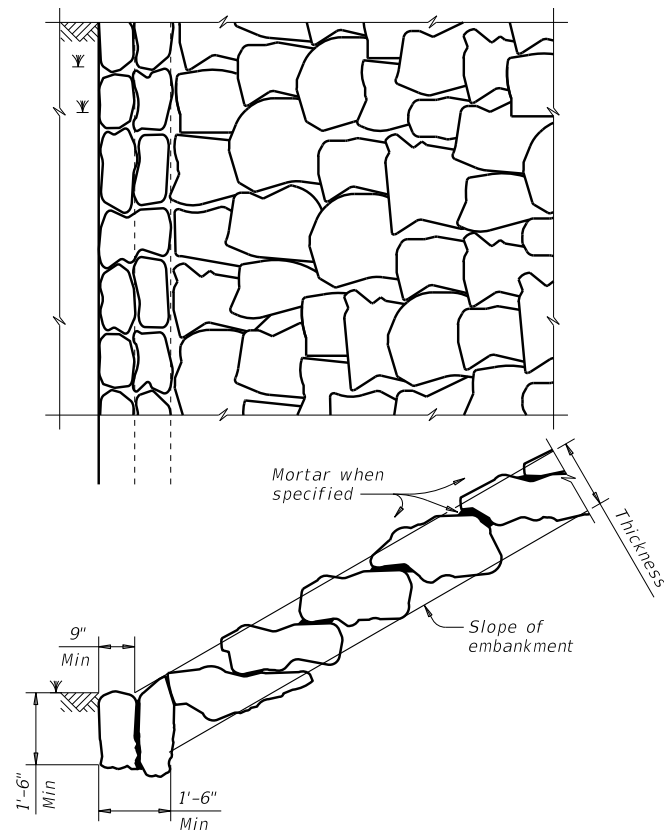
		<b>Bridge Division Standard</b>	
<h2>STONE RIPRAP</h2>			
<h3>SRR</h3>			
FILE: MS-SRR-19.dgn	DN: AES	CK: JGD	DW: BWH
©TxDOT April 2019	CONT	SECT	JOB
REVISIONS			HIGHWAY
	DIST	COUNTY	SHEET NO.

DATE:  
FILE:

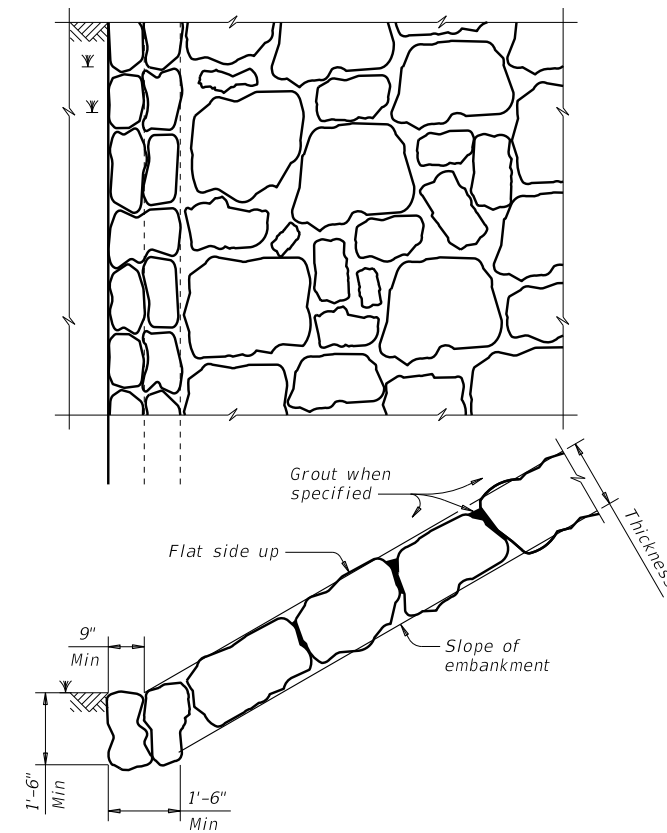
DISCLAIMER: This standard is governed by the "Texas Engineering Practice Act". No warranty of any kind is made by TxDOT for any purpose whatsoever. TxDOT assumes no responsibility for the conversion of this standard to other formats or for incorrect results or damages resulting from its use.



**FIGURE 1 ~ TYPE R STONE RIPRAP**  
dry or grouted

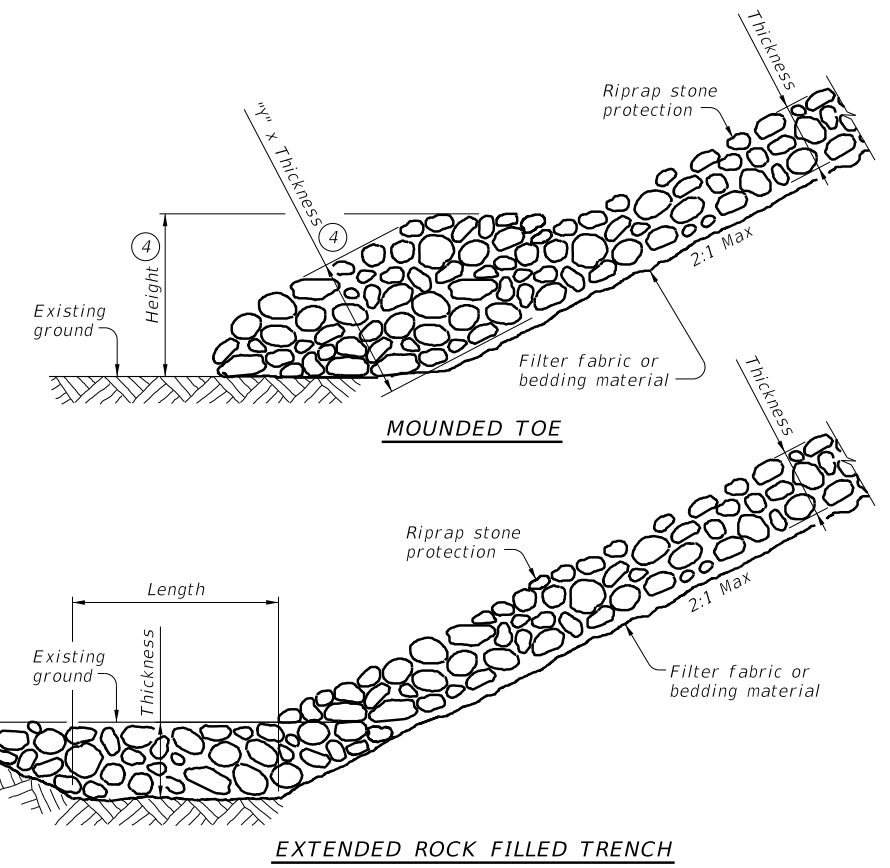


**FIGURE 2 ~ TYPE F STONE RIPRAP**  
dry or mortared

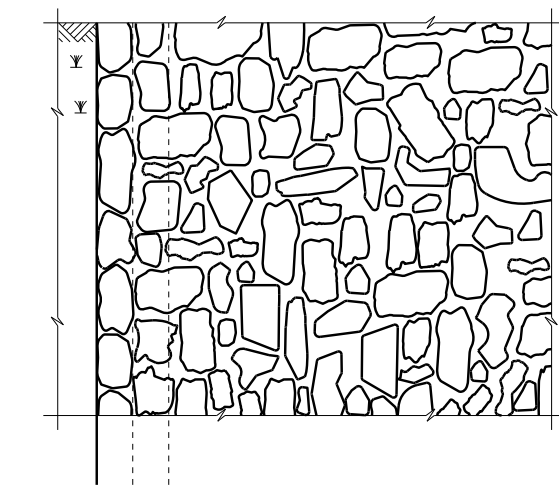


**FIGURE 3 ~ TYPE F STONE RIPRAP**  
grouted

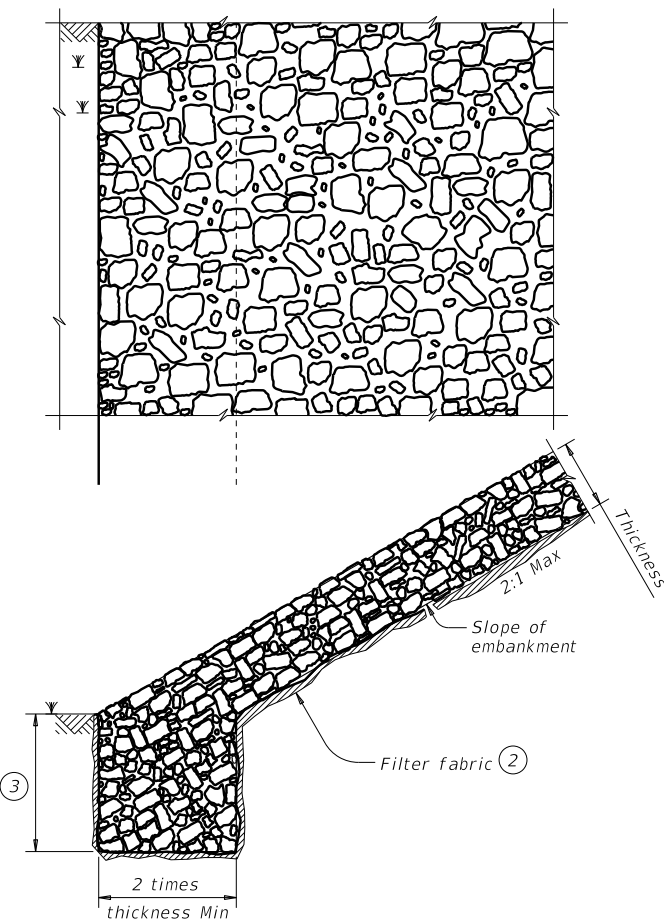
- ② Provide bedding material instead of filter fabric if shown elsewhere in plans. See Layout for thickness of bedding material.
- ③ Minimum toe depth is the larger of the maximum scour depth or 2 times the riprap thickness.
- ④ "Y" and Height need to be defined. See layout or detail sheet for values if this option is used.
- ⑤ List Stone Protection as size (XX inch) and thickness (YY inch) on the layout.  
Example: Riprap (Stone Protection) XX inch, Thickness = YY inch.



**PROTECTION STONE RIPRAP TOE OPTIONS ⑤**



**FIGURE 4 ~ COMMON STONE RIPRAP**  
dry or grouted



**FIGURE 5 ~ PROTECTION STONE RIPRAP ⑤**

SHEET 2 OF 2



**STONE RIPRAP**

**SRR**

FILE: MS-SRR-19.dgn	DN: AES	CK: JGD	DW: BWH	CK: AES
©TxDOT April 2019	CONT	SECT	JOB	HIGHWAY
REVISIONS				
	DIST	COUNTY	SHEET NO.	

DATE:  
FILE: