

DISCLAIMER: This standard is governed by the "Texas Engineering Practice Act." No warranty of any kind is made by TxDOT for any purpose whatsoever. TxDOT assumes no responsibility for the conversion of this standard to other formats or for incorrect results or damages resulting from its use.

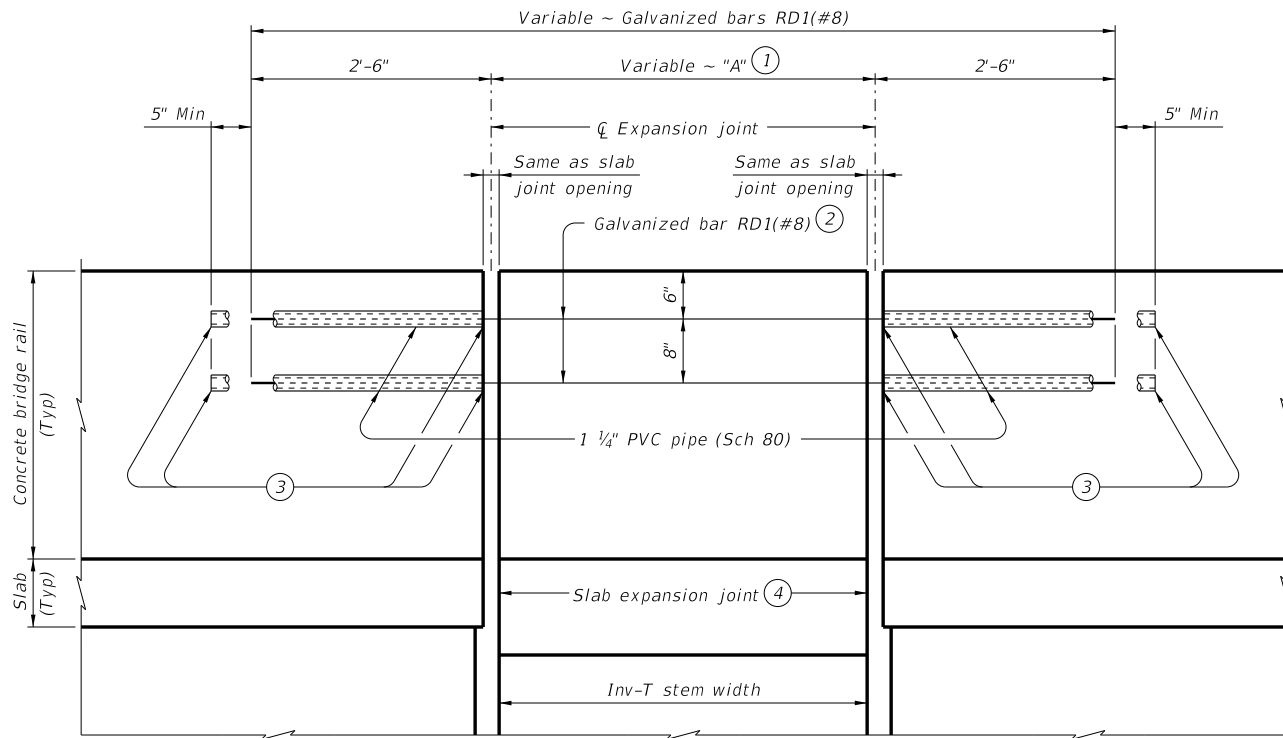

SHOWING SLAB EXPANSION JOINTS

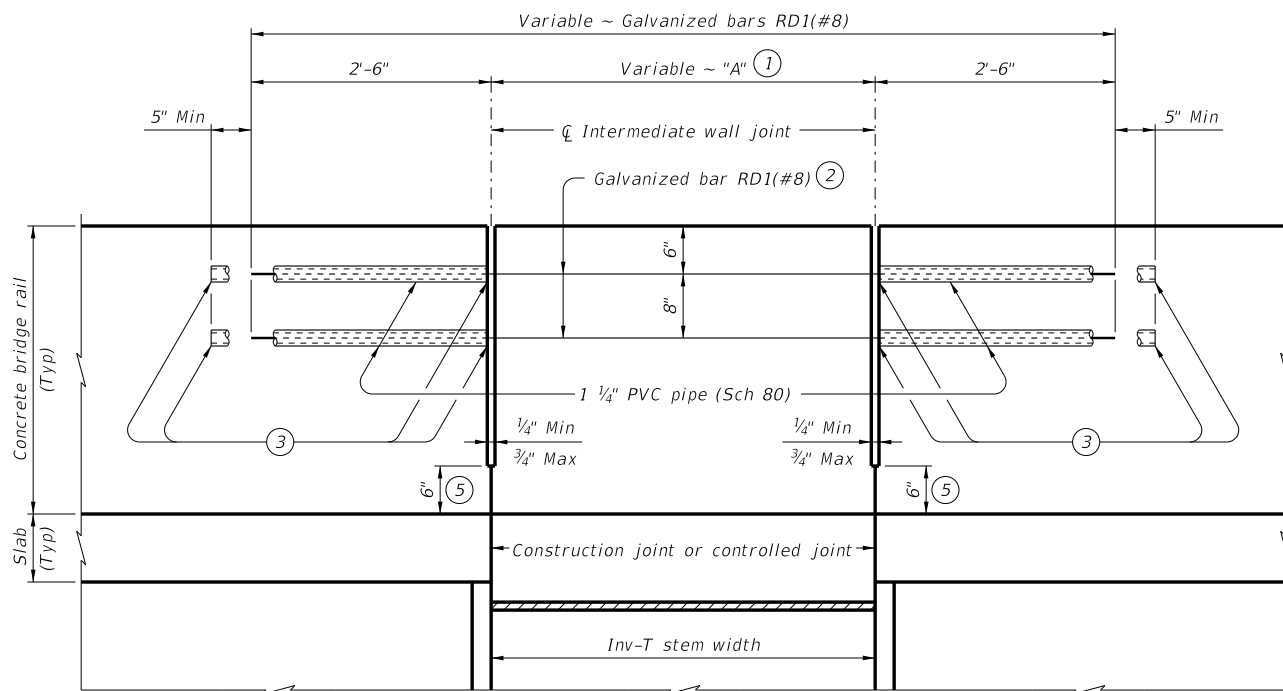

SHOWING SLAB CONST JTS OR CONTROLLED JTS

ELEVATION EXAMPLE FOR CONCRETE RAILS OVER INV-T BENTS^⑥

(Showing placement of 2 Bars RD1(#8) in T221, C221, T222, T551 or SSTR rails, other rails are shown on Sheet 2 of 2. Concrete rail, slab, and Inv-T stem reinforcing not shown for clarity.)

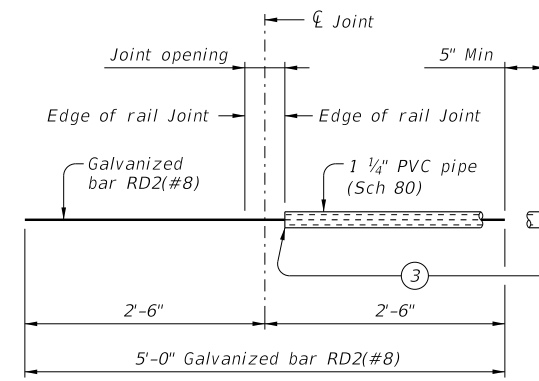

OPTIONAL BAR RD2(#8) ASSEMBLY DETAIL^①

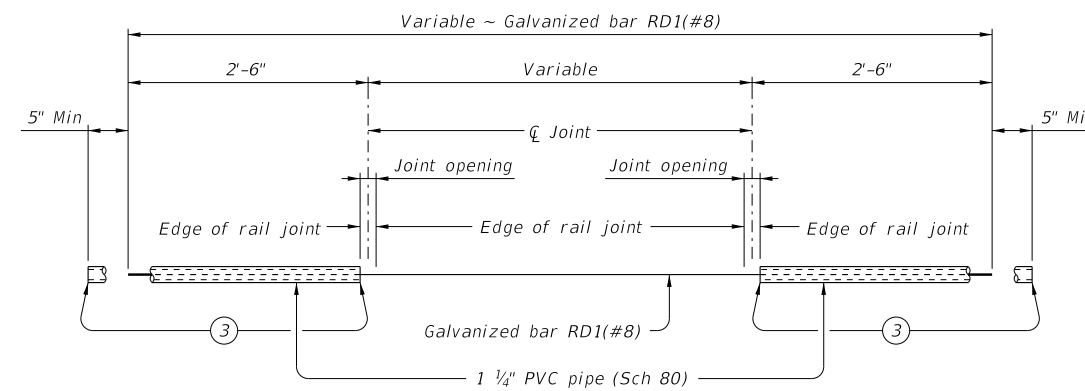

BAR RD1(#8) ASSEMBLY DETAIL^①

- ① When "A" dimension is 6 feet or greater along rail, galvanized Bars RD1(#8) can be replaced with 2 galvanized Bars RD2(#8) at contractor's option. Place Bars RD1(#8) or optional Bars RD2(#8) at each joint over Inv-T bents as shown.
- ② See "Bar RD1(#8) Assembly Detail" or "Optional Bar RD2(#8) Assembly Detail"
- ③ Tape ends of 1 1/4" PVC Sch 80 to prevent concrete or mortar from seeping in.
- ④ See Bridge Layout for joint type.
- ⑤ Increase 2" for structures with overlay.
- ⑥ For rails requiring 2 or 3 Bars RD1(#8) over Inv-T bents, see "Rail Sections Locating 2 Bars RD(#8)" or "Rail Sections Locating 3 Bars RD(#8)."

SHEET 1 OF 2



CONCRETE RAIL JOINTS OVER INVERTED-T BENTS

CRJ-ITB

FILE: RL-CRJ-ITB-20.dgn	DN: TxDOT	CK: TAR	DW: JTR	CK: TAR
©TxDOT	CONT	SECT	JOB	HIGHWAY
REVISIONS				
DIST	COUNTY			SHEET NO.

DATE:
FILE:

DISCLAIMER: The use of this standard is governed by the "Texas Engineering Practice Act." No warranty of any kind is made by TxDOT for any purpose whatsoever. TxDOT assumes no responsibility for the conversion of this standard to other formats or for incorrect results or damages resulting from its use.

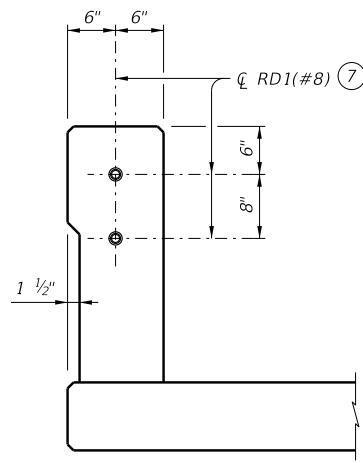

T221, T222 & C221 RAIL

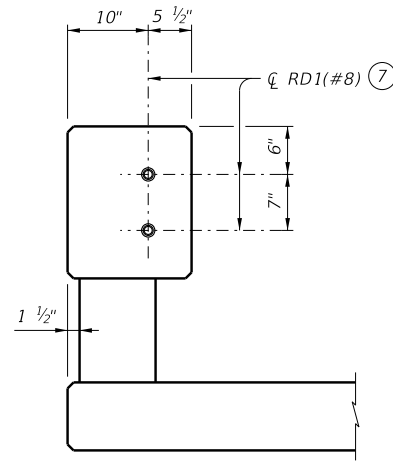

T223 & C223 RAIL

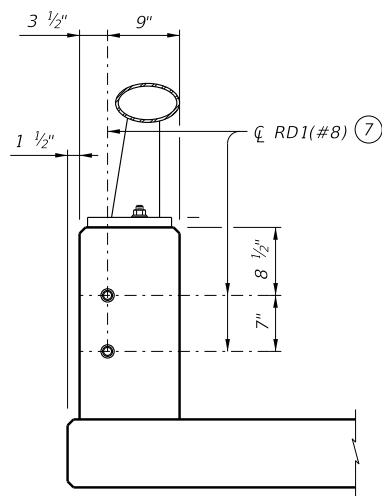

T402 & C402 RAIL

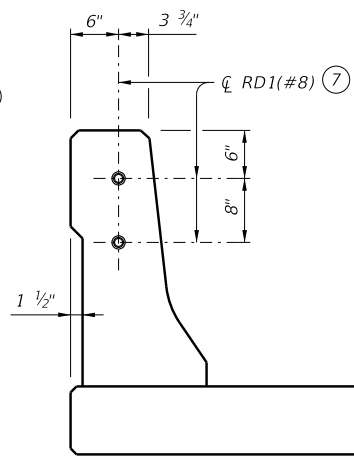

T551 & T552 RAIL

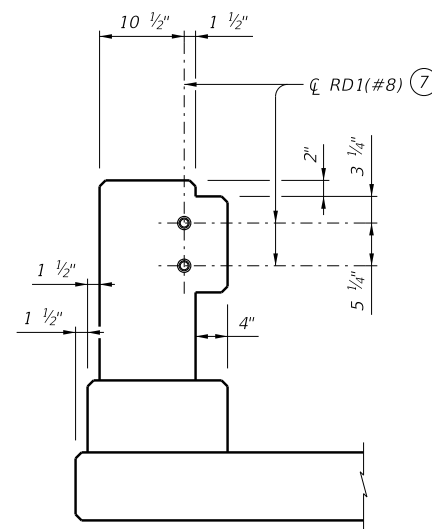

T66 & C66 RAIL

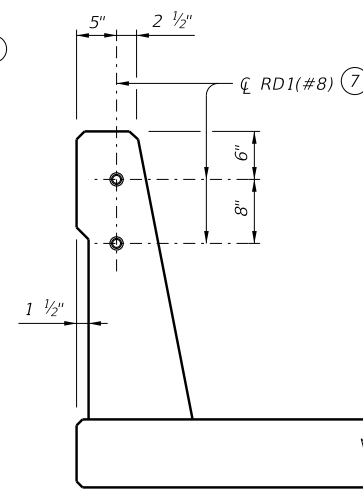

SSTR RAIL

RAIL SECTIONS LOCATING 2 BARS RD(#8)

(Rail and slab reinforcing not shown for clarity.)

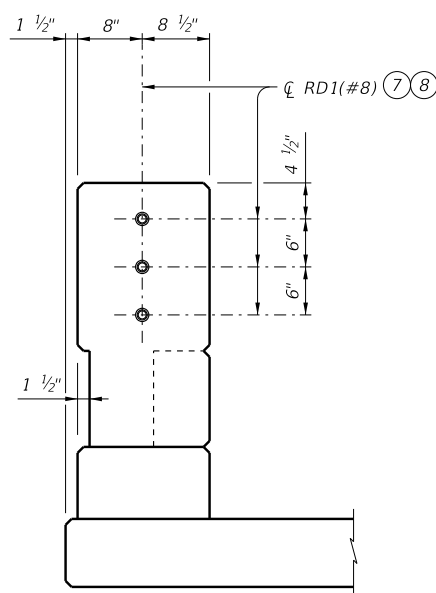

T224 RAIL

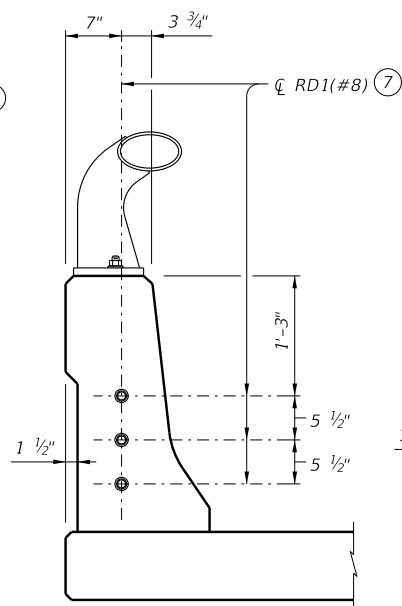

T80HT RAIL

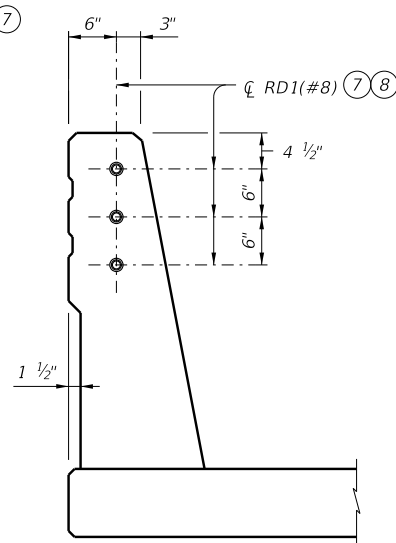

T80SS RAIL

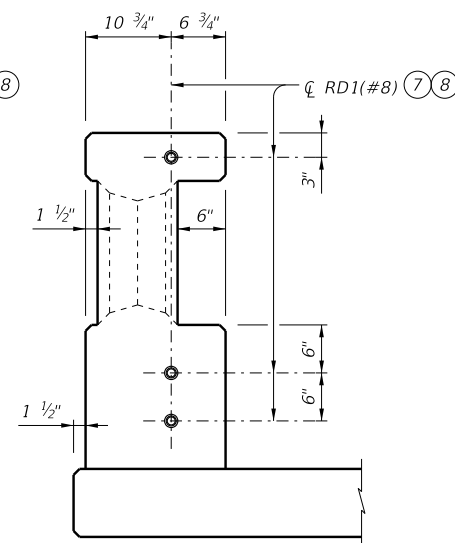

C412 RAIL

RAIL SECTIONS LOCATING 3 BARS RD(#8)

(Rail and slab reinforcing not shown for clarity.)

CONSTRUCTION NOTES:

Verify dimensions "A" over Inv-T bents before ordering materials.

MATERIAL NOTES:

Galvanize Bars RD1(#8) and/or RD2(#8).

Provide Grade 60 reinforcing steel.

Provide 1 1/4" PVC pipe size (Sch 80).

GENERAL NOTES:

This standard is for concrete rails when the rail joints are located at the face of an Inv-T bent stem as shown.

See appropriate rail standard for details and notes not shown.

See elsewhere in the plans for the rail type.

Do not use these details on bridges with expansion joints providing more than 5" movement.

Payment for assembly Bars RD1(#8) and/or assembly Bars RD2(#8) are subsidiary to Item 450 "Railing."

⑦ See "Bar RD1(#8) Assembly Detail" or "Optional Bar RD2(#8) Assembly Detail" and "Elevation Example For Concrete Rails Over Inv-T Bents" for placement and the assembly along rails over Inv-T bents.

⑧ Replace Bars RD(#8) shown on applicable rail standard with Bars RD1(#8) when over Inv-T bents. Optional Bars RD2(#8) can replace Bars RD1(#8) when dimensions "A" are 6 feet and greater. See "A" dimensions on "Elevation Example For Concrete Rails Over Inv-T Bents."



CONCRETE RAIL JOINTS OVER INVERTED-T BENTS

CRJ-ITB

FILE: RL-CRJ-ITB-20.dgn	DN: TxDOT	CK: TAR	DW: JTR	CK: TAR
©TxDOT	CONT	SECT	JOB	HIGHWAY
REVISIONS				
DIST	COUNTY			SHEET NO.

DATE:
FILE: