

DISCLAIMER: The use of this standard is governed by the "Texas Engineering Practice Act". No warranty of any kind is made by TxDOT for any purpose whatsoever. TxDOT assumes no responsibility for the conversion of this standard to other formats or for incorrect results or damages resulting from its use.

DATE: FILE:

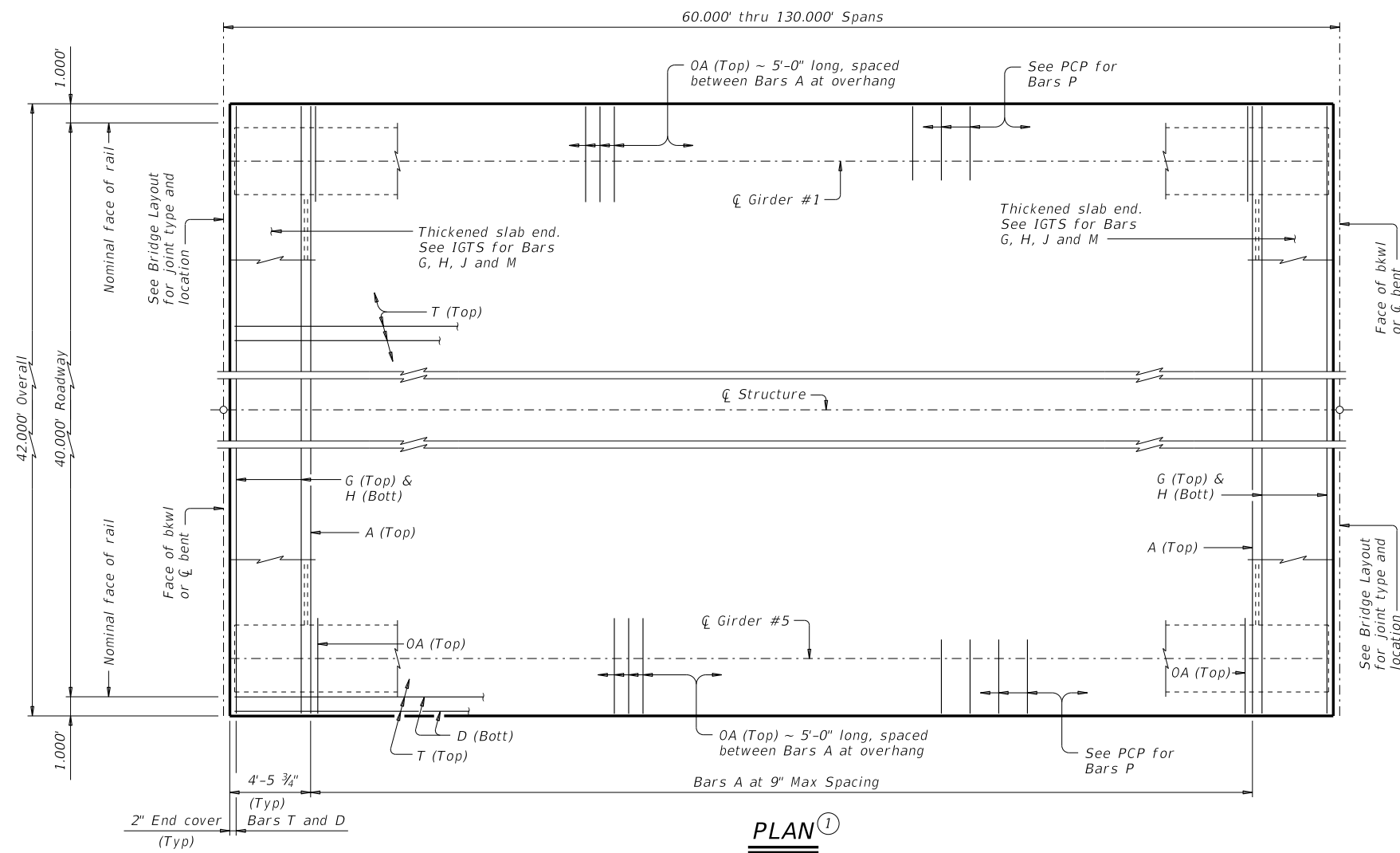

- ① If multi-span units (with slab continuous over interior bents) are indicated on the Bridge Layout, see standard IGCS for adjustment to slab reinforcement and quantities.
- ② "Y" value shown is based on theoretical girder camber, dead load deflection from an 8 1/2" concrete slab, a constant roadway grade, and using precast panels (PCP). The Contractor will adjust this value as necessary for any roadway vertical curve and/or if the precast overhang panel (PCP(O)) option is used.

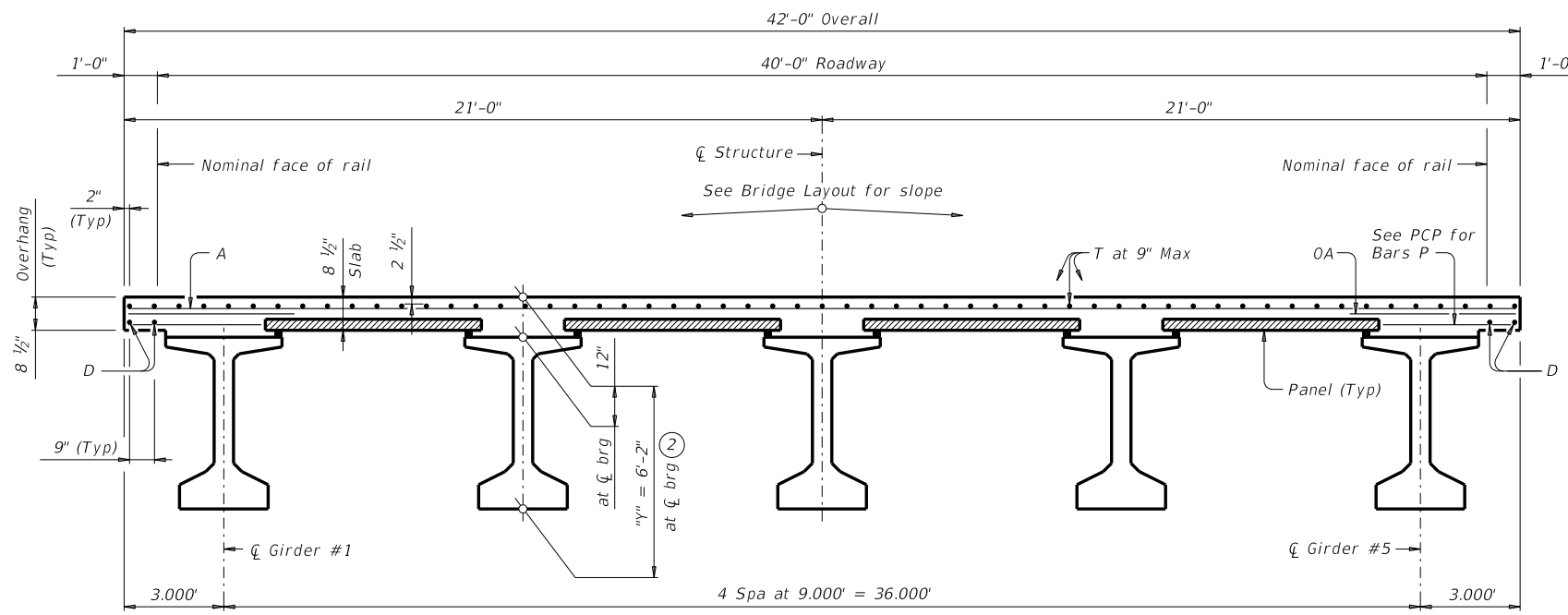

BAR TABLE	
BAR	SIZE
A	#4
D	#4
G	#4
H	#4
J	#4
M	#4
OA	#5
P	#4
T	#4

HL93 LOADING SHEET 1 OF 2



**PRESTRESSED CONCRETE I-GIRDER SPANS (TYPE T x 62) 40' ROADWAY**

**SIG-62-40**

FILE: sig53sts-19.dgn	DN: JMH	CK: ASB	DW: JTR	CK: TAR
©TxDOT August 2017	CONT	SECT	JOB	HIGHWAY
REVISIONS				
10-19: Increased "X" and "Y" Values				
DIST	COUNTY	SHEET NO.		

DISCLAIMER:  
 The use of this standard is governed by the "Texas Engineering Practice Act". No warranty of any kind is made by TxDOT for any purpose whatsoever. TxDOT assumes no responsibility for the conversion of this standard to other formats or for incorrect results or damages resulting from its use.

DATE:  
 FILE:

TABLE OF DEAD LOAD DEFLECTIONS		
TYPE Tx62 GIRDERS		
SPAN LENGTH	"A"	"B"
Ft	Ft	Ft
60	0.006	0.009
65	0.009	0.012
70	0.012	0.017
75	0.016	0.022
80	0.021	0.029
85	0.026	0.037
90	0.033	0.046
95	0.041	0.058
100	0.051	0.071
105	0.062	0.087
110	0.075	0.105
115	0.090	0.126
120	0.107	0.150
125	0.126	0.177
130	0.148	0.208

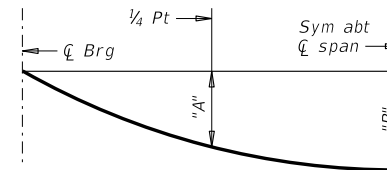

**DEAD LOAD DEFLECTION DIAGRAM**

Calculated deflections shown are due to the concrete slab on interior girders only ( $E_c = 5000$  ksi). Adjust values as required for exterior girders and if optional slab forming is used. These values may require field verification.

SPAN LENGTH	REINF CONCRETE SLAB	Prestressed Concrete Girders			TOTAL REINF STEEL ④
		ABUT TO INT BT ③	INT BT TO INT BT ③	ABUT TO ABUT ③	
Ft	SF	LF	LF	LF	Lb
60	2,520	297.50	297.50	297.50	5,796
65	2,730	322.50	322.50	322.50	6,279
70	2,940	347.50	347.50	347.50	6,762
75	3,150	372.50	372.50	372.50	7,245
80	3,360	397.50	397.50	397.50	7,728
85	3,570	422.50	422.50	422.50	8,211
90	3,780	447.50	447.50	447.50	8,694
95	3,990	472.50	472.50	472.50	9,177
100	4,200	497.50	497.50	497.50	9,660
105	4,410	522.50	522.50	522.50	10,143
110	4,620	547.50	547.50	547.50	10,626
115	4,830	572.50	572.50	572.50	11,109
120	5,040	597.50	597.50	597.50	11,592
125	5,250	622.50	622.50	622.50	12,075
130	5,460	647.50	647.50	647.50	12,558

③ Fabricator will adjust lengths for girder slopes as required.

④ Reinforcing steel weight is calculated using an approximate factor of 2.3 lbs/SF.

**GENERAL NOTES:**

- Designed according to AASHTO LRFD Bridge Design Specifications.
- Multi-span units, with slab continuous over interior bents, may be formed with the details shown on this sheet and standard IGCS.
- See IGTS standard for Thickened Slab End details and quantity adjustments.
- See PCP and PCP-FAB for panel details not shown.
- See PCP(0) and PCP(0)-FAB for precast overhang panel details if this option is used.
- See IGMS standard for miscellaneous details.
- See applicable rail details for rail anchorage in slab.
- See PMDF standard for details and quantity adjustments if this option is used.
- This standard does not support the use of transition bents.

Cover dimensions are clear dimensions, unless noted otherwise.

**MATERIAL NOTES:**

- Provide Class S concrete ( $f'_c = 4,000$  psi).
- Provide Class S (HPC) concrete if shown elsewhere in the plans.
- Provide Grade 60 reinforcing steel.
- Provide bar laps, where required, as follows:
  - Uncoated ~ #4 = 1'-7"
  - Epoxy coated ~ #4 = 2'-5"
- Deformed Welded Wire Reinforcement (WWR) (ASTM A1064) of equal size and spacing may be substituted for Bars A, D, OA, P or T unless noted otherwise.

HL93 LOADING

SHEET 2 OF 2

 <b>Texas Department of Transportation</b>	<b>Bridge Division Standard</b>			
<b>PRESTRESSED CONCRETE I-GIRDER SPANS (TYPE Tx62) 40' ROADWAY</b>				
<b>SIG-62-40</b>				
FILE: sig53sts-19.dgn	DN: JMH	CK: ASB	DW: JTR	CK: TAR
©TxDOT August 2017	CONT	SECT	JOB	HIGHWAY
REVISIONS				
10-19: Increased "X" and "Y" Values				
	DIST	COUNTY		SHEET NO.