

DISCLAIMER: The use of this standard is governed by the "Texas Engineering Practice Act". No warranty of any kind is made by TxDOT for any purpose whatsoever. TxDOT assumes no responsibility for the conversion of this standard to other formats or for incorrect results or damages resulting from its use.

CONTINUOUS CONCRETE OR STEEL BARRIER

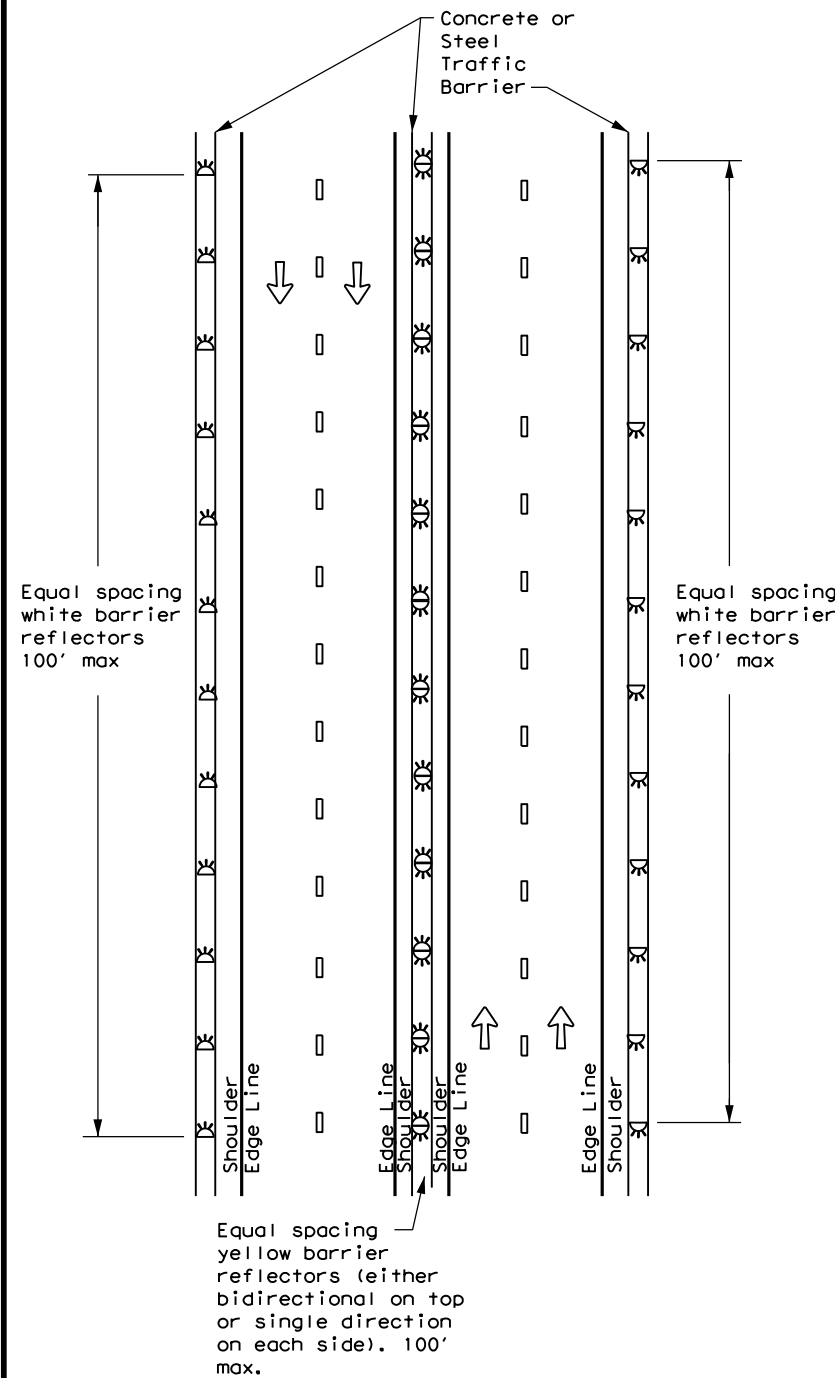

MULTI-LANE UNDIVIDED, TWO-WAY ROADWAY WITH METAL BEAM GUARD FENCE (MBGF)

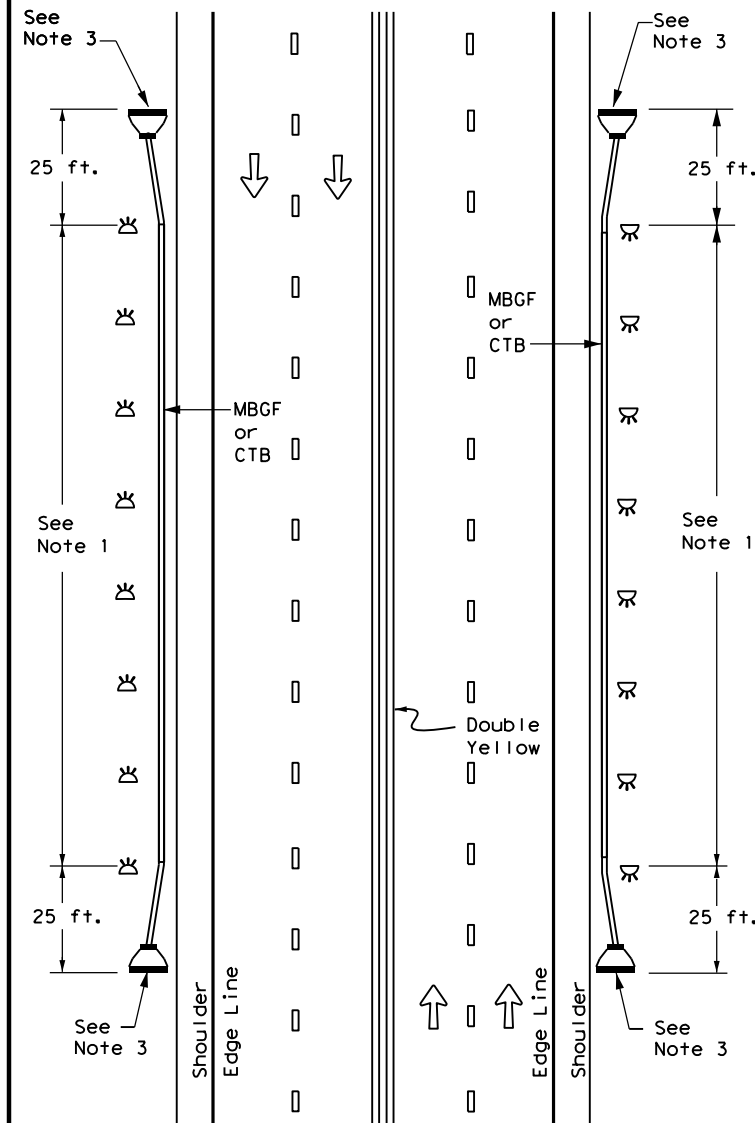

DIVIDED ROADWAY WITH METAL BEAM GUARD FENCE (MBGF)

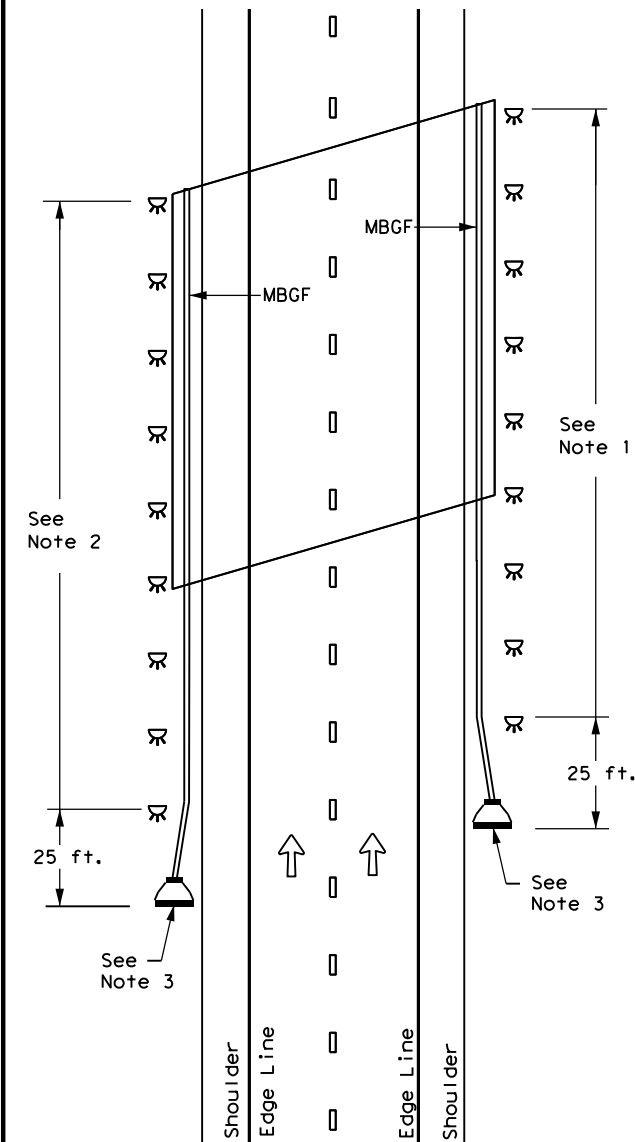

EMERGENCY CROSSOVER

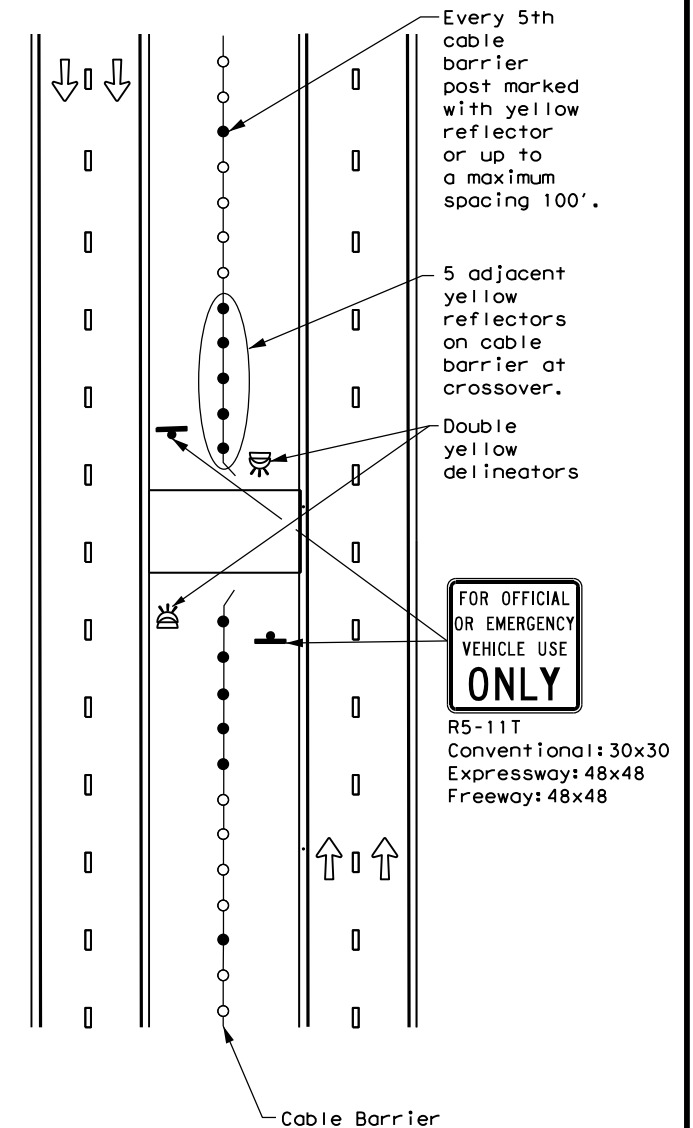

NOTES

1. Equal spacing (100' max), but not less than 3 single directional white barrier reflectors or delineators. On Continuous Barrier, equal spacing (100' max.)
2. Equal spacing (100' max), but not less than 3 single directional yellow barrier reflectors or delineators.
3. Terminal ends require reflective sheeting provided by manufacturer per D & OM (VIA) or a Type 3 Object Marker (OM-3) in front of the terminal end.

LEGEND

	Bidirectional Delineator
	Delineator
	OM-3
	OM-2
	Terminal End
	Traffic Flow



DELINEATOR & OBJECT MARKER PLACEMENT DETAILS

D & OM(6)-20

FILE: dom6-20.dgn	DN: TxDOT	CK: TxDOT	DW: TxDOT	CK: TxDOT
©TxDOT August 2015	CONT	SECT	JOB	HIGHWAY
7-20	REVISIONS		DIST	COUNTY
				SHEET NO.

DATE:
FILE: