

DISCLAIMER: The use of this standard is governed by the "Texas Engineering Practice Act". No warranty of any kind is made by TxDOT for any purpose whatsoever. TxDOT assumes no responsibility for the conversion of this standard to other formats or for incorrect results or damages resulting from its use.

WORK ZONE SHORT TERM PAVEMENT MARKINGS PATTERNS (TABS)

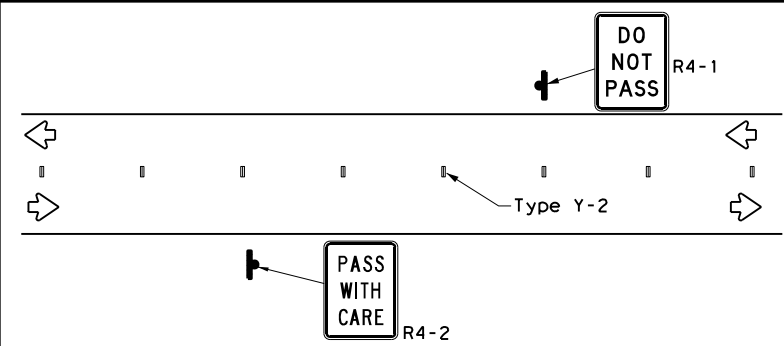

CENTER LINE & NO-PASSING ZONE BARRIER LINES FOR TWO LANE TWO-WAY HIGHWAYS

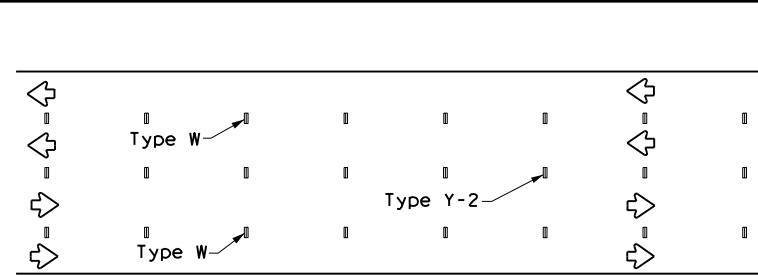

LANE & CENTER LINES FOR MULTILANE UNDIVIDED HIGHWAYS

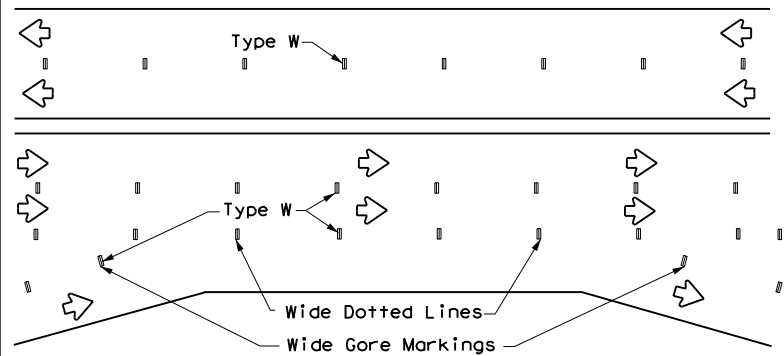

LANE LINES FOR DIVIDED HIGHWAY

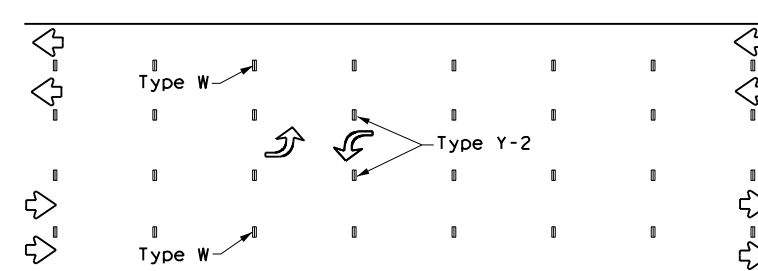

TWO-WAY LEFT TURN LANE

WORK ZONE SHORT TERM PAVEMENT MARKINGS DETAILS (TABS)

SOLID LINES	DOUBLE NO-PASSING LINE	
	SINGLE NO-PASSING LINE or CHANNELIZATION LINE	
	8" WIDE SOLID LINE	
BROKEN LINES (FOR CENTER LINE OR LANE LINE)		
WIDE DOTTED LINES (FOR LANE DROP LINES)		
WIDE GORE MARKINGS		

TABS ON CENTERLINES OF TWO-LANE TWO-WAY ROADS

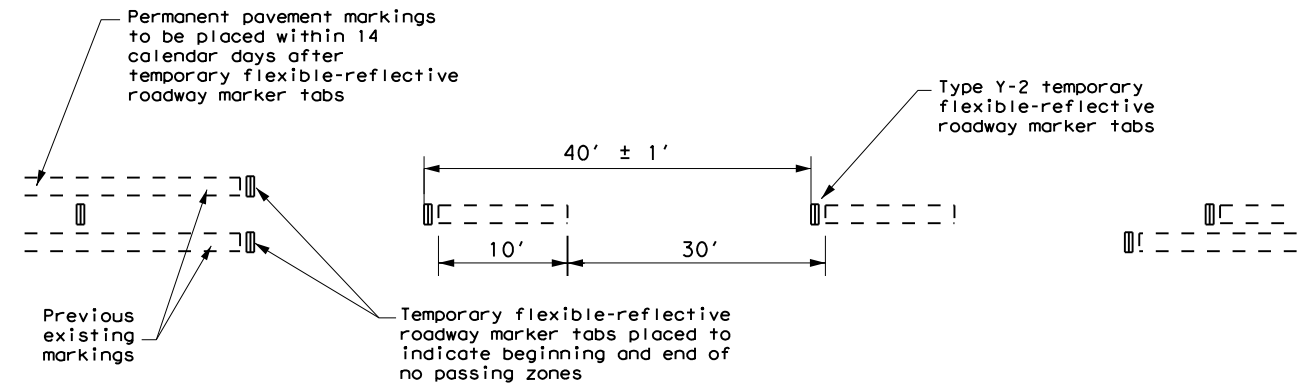

TEMPORARY FLEXIBLE-REFLECTIVE ROADWAY MARKER TABS

- Temporary markings for surfacing projects shall be Temporary Flexible-Reflective Roadway Marker Tabs with protective cover unless otherwise approved by the Engineer. Tabs are to be installed to provide true alignment for striping crews or as directed by the Engineer. Tabs will be placed at the spacing indicated. Tabs should be applied to the pavement no more than two days before the surfacing is applied. After the surfacing is rolled and swept, the protective cover over the reflective strip shall be removed.
- Temporary Flexible-Reflective Roadway Marker Tabs detailed on this sheet will be designated Type Y-2 (two amber reflective surfaces with a yellow body); Type Y (one amber reflective surface with yellow body); and Type W (one white or silver reflective surface with white body). Additional details may be found on BC(11).
- Temporary Flexible-Reflective Roadway Marker Tabs will require normal maintenance replacement when used on roadways with an Average Daily Traffic (ADT) per lane of up to 7500 vehicles with no more than 10% truck mix. When roadway volumes exceed these values, additional maintenance replacement of these devices should be planned for.
- When dry, tabs shall be visible for a minimum distance of 200 feet during normal daylight hours and when illuminated by automobile low-beam head light at night, unless sight distance is restricted by roadway geometrics.
- No two consecutive tabs nor four tabs per 1000 feet of line shall be missing or fail to meet the visual performance requirements of Note 4.
- Tabs shall meet requirements of Departmental Material Specification DMS-8242.
- Tabs shall NOT be used to simulate edge lines.

NOTES:

- The Contractor will be responsible for maintaining short term pavement markings until permanent pavement markings are in place. When the Contractor is responsible for placement of permanent pavement markings, no segment of roadway shall remain without permanent pavement markings for a period greater than 14 calendar days unless weather conditions prohibit placement. Permanent pavement markings shall be placed as soon as weather permits.
- For exit gores where a lane is being dropped, place wide gore markings or retroreflective channelizing devices to guide motorist through the exit. If channelizing devices are to be used it should be noted elsewhere in the plans. One piece cones are NOT acceptable.
- Dimensions indicated on this sheet are typical and approximate. Variations in size and height may occur between markers or devices made by manufacturers, by as much as 1/4 inch, unless otherwise noted.

DEPARTMENTAL MATERIAL SPECIFICATIONS (DMS) & MATERIAL PRODUCER LISTS (MPL)

- DMSs referenced above may be found along with embedded links to their respective MPLs at the following website: <http://www.txdot.gov>

SHEET 7 OF 8

TEMPORARY FLEXIBLE-REFLECTIVE ROADWAY MARKER TABS

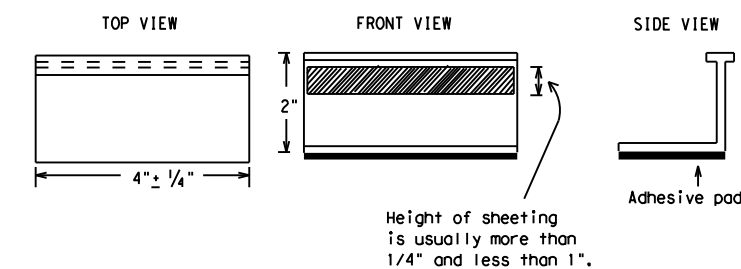

TEMPORARY PAVEMENT MARKINGS FOR SEAL COAT OPERATIONS

TCP (SC-7) -22

FILE:	tcpsc-7-22.dgn	DN:	TxDOT	CK:	TxDOT	DW:	TxDOT	CK:	TxDOT
©TxDOT	October 2022	CONT	SECT	JOB	HIGHWAY				
REVISIONS		DIST		COUNTY		SHEET NO.			
4-21	10-22								

DATE:
FILE: