

941 EXCHANGE

SOUTHWESTERN BELL TELEPHONE COMPANY
 ENGINEERING Not for Release Outside
 Except Under Written Agreement

SECTION 1" = 104.8'
 MARKET AREA DALLAS/FT. WORTH
 NPA/NABO 514431
 EXCHANGES HAMILTON
 GEO. LOCALITY/481
 TAX DISTRICTS 58009



Adjacent Maps
 N 705-625-14
 S 705-625-12
 E 705-625-23
 W 697-625-83
 Map Type PLR
 Map
 705-625-13
 Update: 11/05/2009

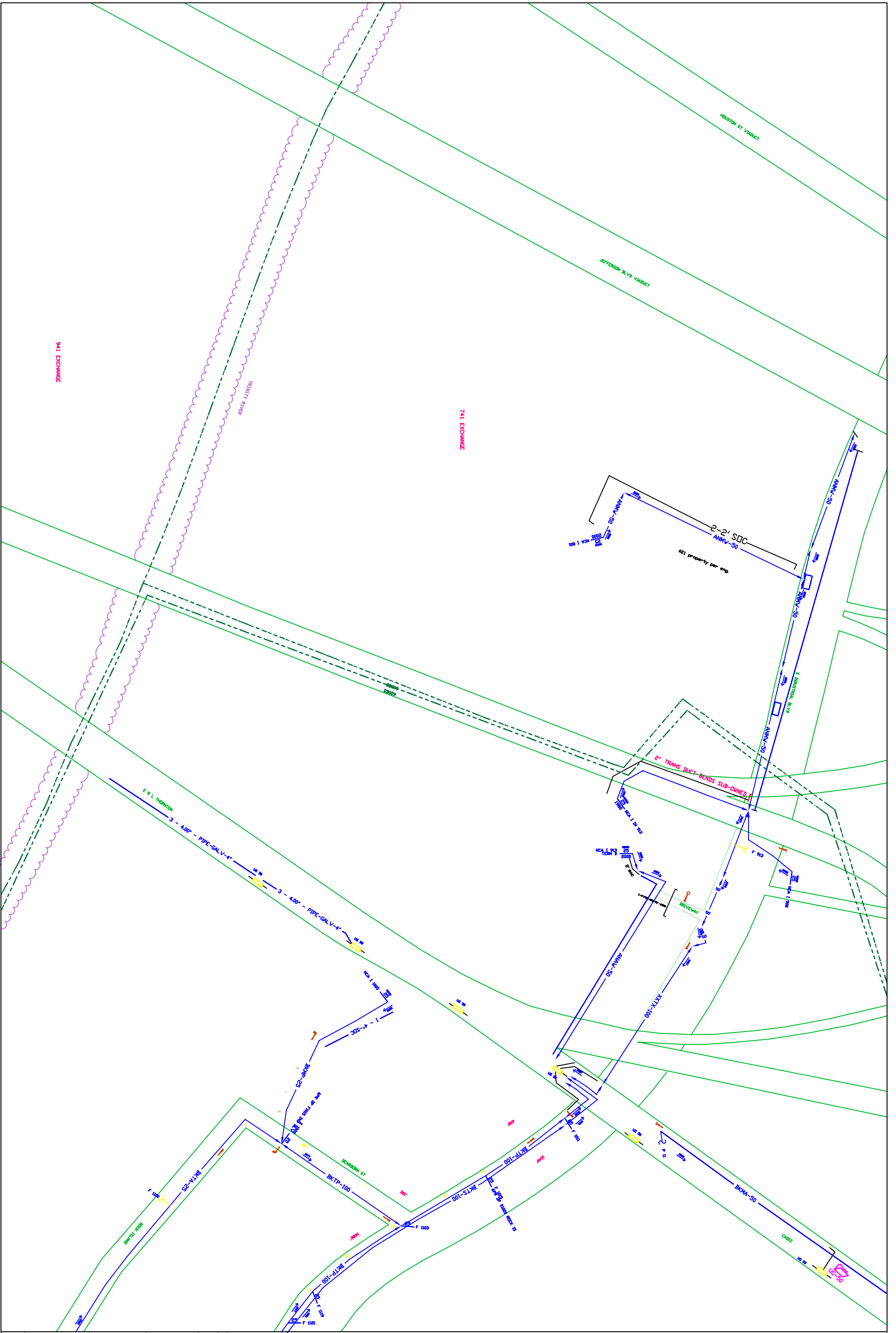

941 EXCHANGE

741 EXCHANGE

TRINITY RIVER

HOUSTON ST VARICT

JEFFERSON BLVD VARICT

E.R.L. THORNTON

6\"/>

DRIVEWAY

JEFFERSON ST

CHART

<p>SOUTHWESTERN BELL TELEPHONE COMPANY PROJECT/STAFF NO'S ARE DISCLOSED & OUTSIDE EXCEPT UNDER WRITTEN AGREEMENTS</p>	
<p>SECTION 1" = 50' AS 2" MARKET AREA DALLAS/FT. WORTH NPA/NAO 814431 EXCHANGE HAMILTON GEN. LOC. 17/431 TAX DISTRICT 38009</p>	
<p>ADJACENT MAPS: N 705-625-15 S 705-625-13 E 705-625-24 W 697-625-24 MAP TYPE P.L.R. MAP: 705-625-14 UPDATED: 11/09/2011</p>	

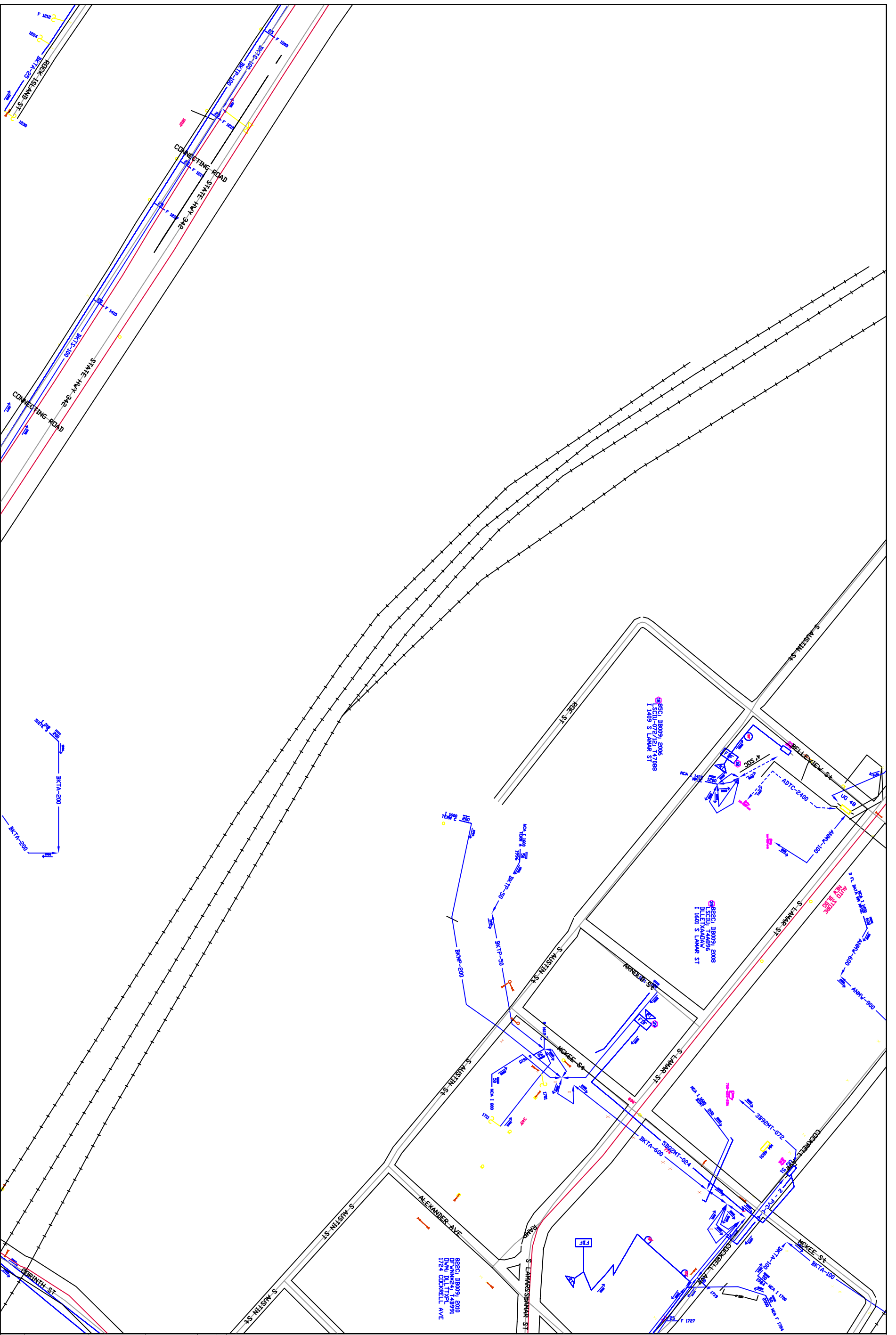

SOUTHWESTERN BELL TELEPHONE COMPANY
 ENGINEERING Not for Disclosure Outside
 DWM/BLT/PL/291
 1724 CORKRELL AVE

SECTION: 1" = 104.8'
 MARKET AREA: DALLAS/FT. WORTH
 NPA/NABO: 514451
 EXCHANGE: HAMILTON
 AREA LOCALITY: 481
 TAX DISTRICT: 88009

Adjacent Maps:
 N 705-625-23
 S 705-625-23
 E 705-625-34
 W 705-625-14
 Map Type: PLS
 Map:
 705-625-24
 Update: 11/08/2011

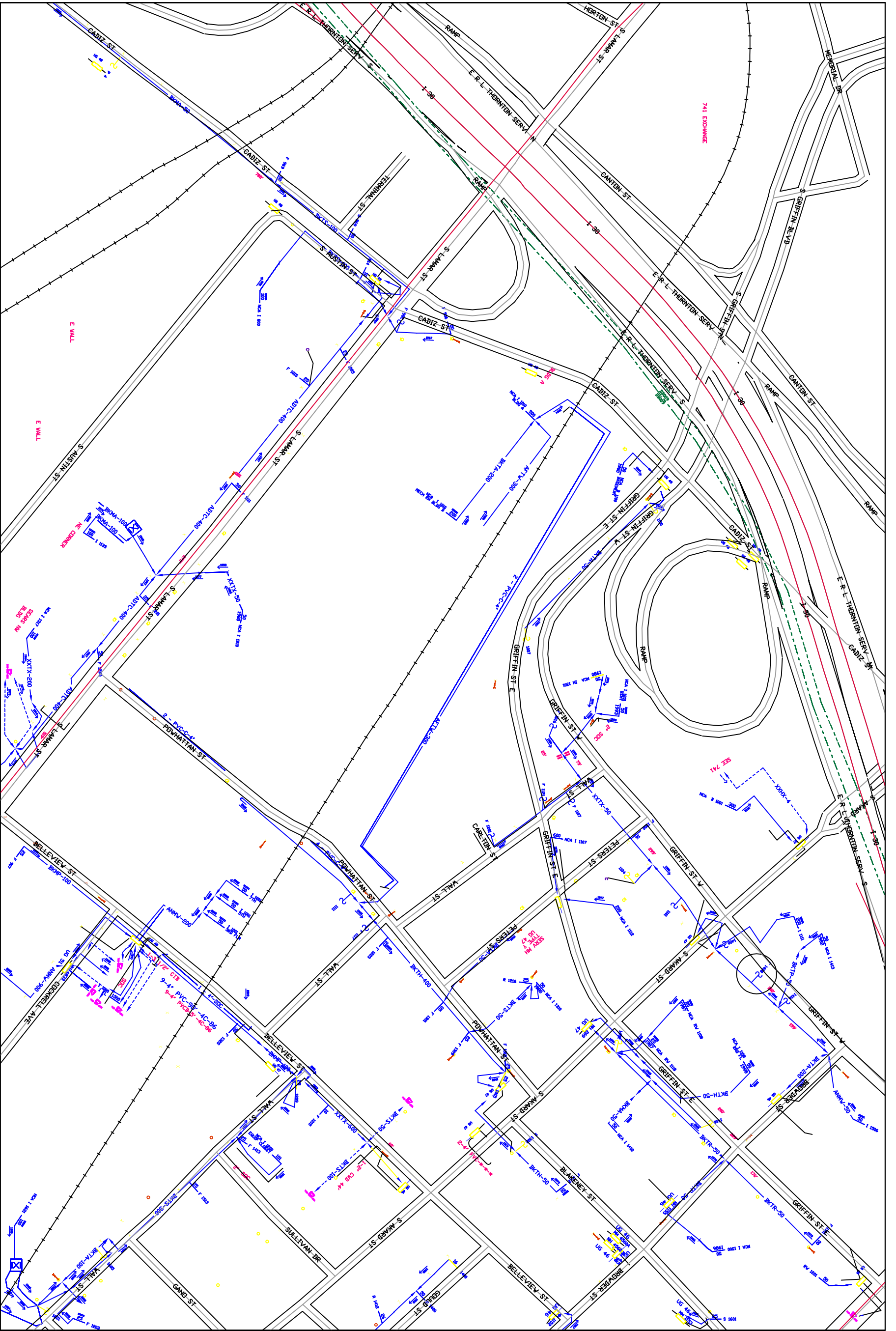

SOUTHWESTERN BELL TELEPHONE COMPANY
 PROJECT: 104-27
 SHEET: 104-27-1
 DATE: 11/20/2011

PROVIDER: 104-27-104-27-1
 SHEET: 104-27-1
 DATE: 11/20/2011

EXCHANGER: 104-27-104-27-1
 SHEET: 104-27-1
 DATE: 11/20/2011

TAX DISTRICT: 104-27-104-27-1
 SHEET: 104-27-1
 DATE: 11/20/2011

ADJACENT MAPS:
 104-27-104-27-1
 104-27-104-27-2
 104-27-104-27-3
 104-27-104-27-4

Map Type: PLR
 Map Date: 11/20/2011

Scale:
 1" = 1000'

North Arrow:
 (Symbol pointing North)

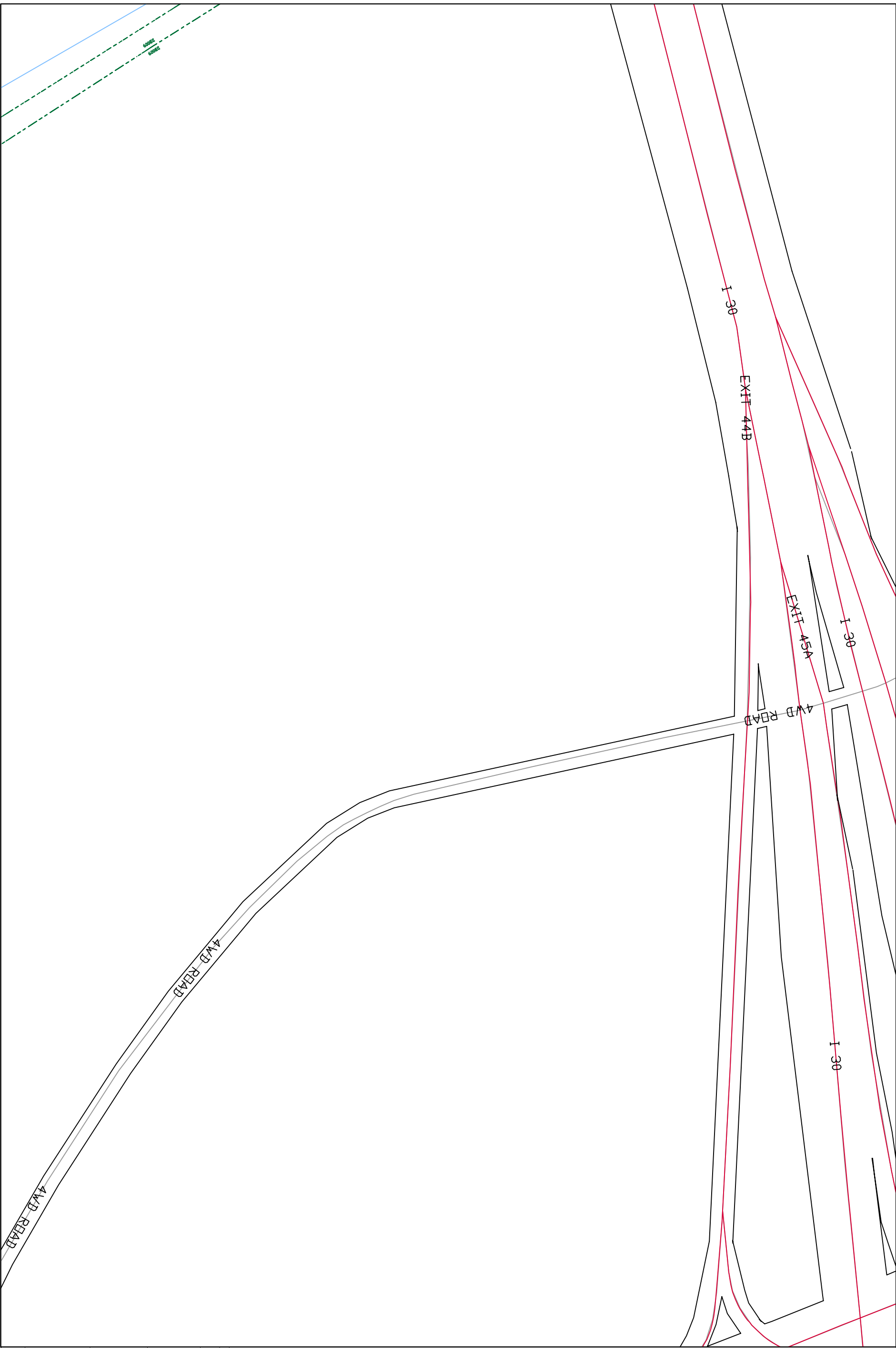

SOUTHWESTERN BELL TELEPHONE COMPANY
 PROHIBITIVE NOT FOR REPRODUCTION
 Except Under Written Agreement



SECTION 1" = 500'
 1" = 500'

Market Area DALLAS/FT. WORTH
 NPA/NAB 817/41
 Exchange RIVERSIDE
 Geo. Loc. TH9741
 Tax Districts 38009

Adjacent Maps:
 N 697-425-85-4
 S 697-425-84-4
 E 705-425-15-1
 W 697-425-85-1

Map Type PLR
 Map:
 697-425-85-3
 Update: 06/21/2000

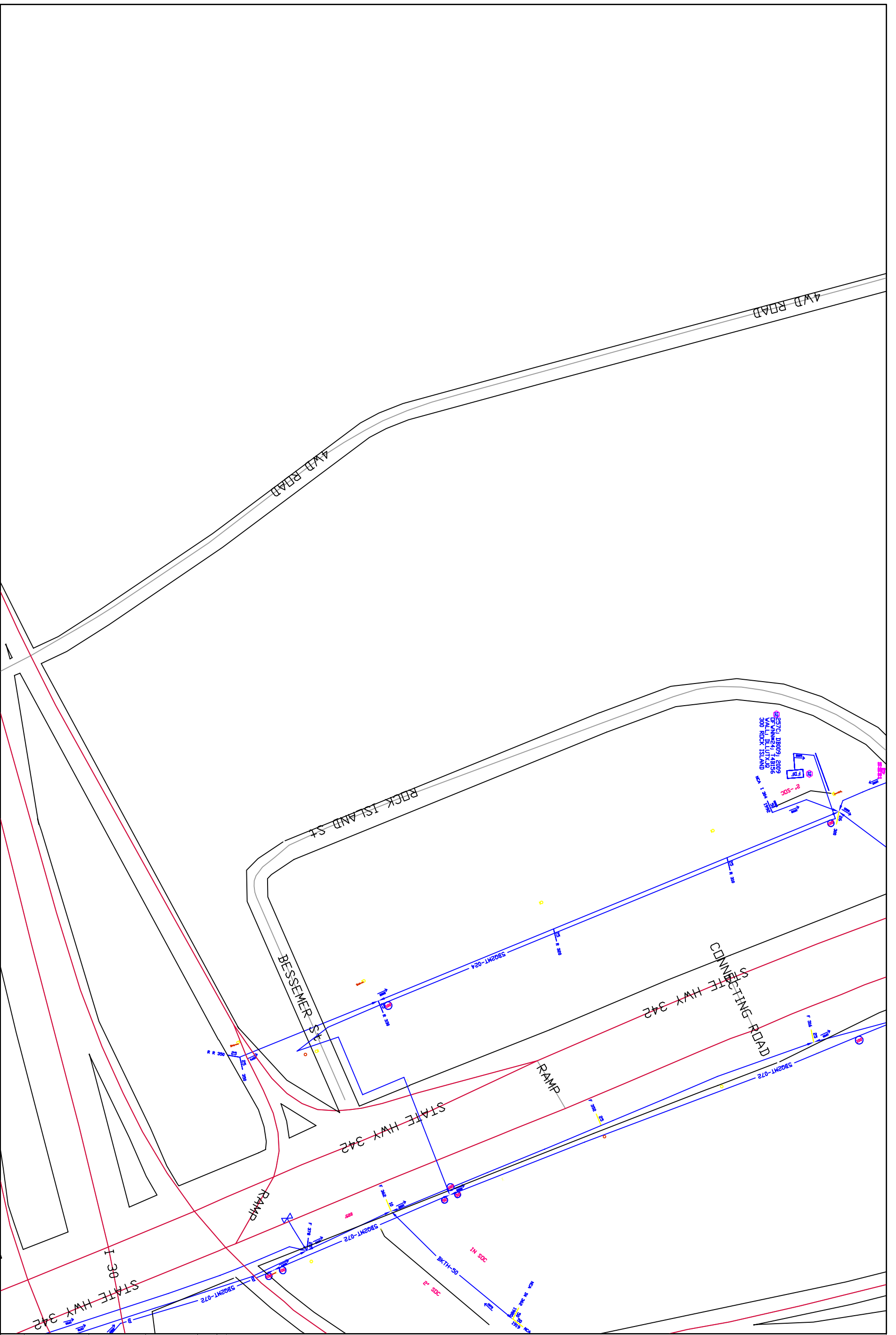

48577-C, DB009, 2009
 OF PLAN 24, 1, 2, 3, 5, 6
 300 ROCK ISLAND
 300 ROCK ISLAND
 1st - SDC
 TR

SOUTHWESTERN BELL TELEPHONE COMPANY
 ENGINEERING Not For Disclosure Outside
 Except Under Written Agreement

SECTION 1" = 50.0'
 MARKET AREA DALLAS/FT. WORTH
 NPA/NABO 514741
 EXCHANGE RIVERSIDE
 GEO. LOCAL 179741
 TAX DISTRICT DB009

Adjacent Maps
 N 697-425-86-3
 S 697-425-85-3
 E 705-425-15-2
 W 697-425-85-2
 Map Type P.L.R.
 Mapped
 697-425-85-4
 Updated 11/07/2011

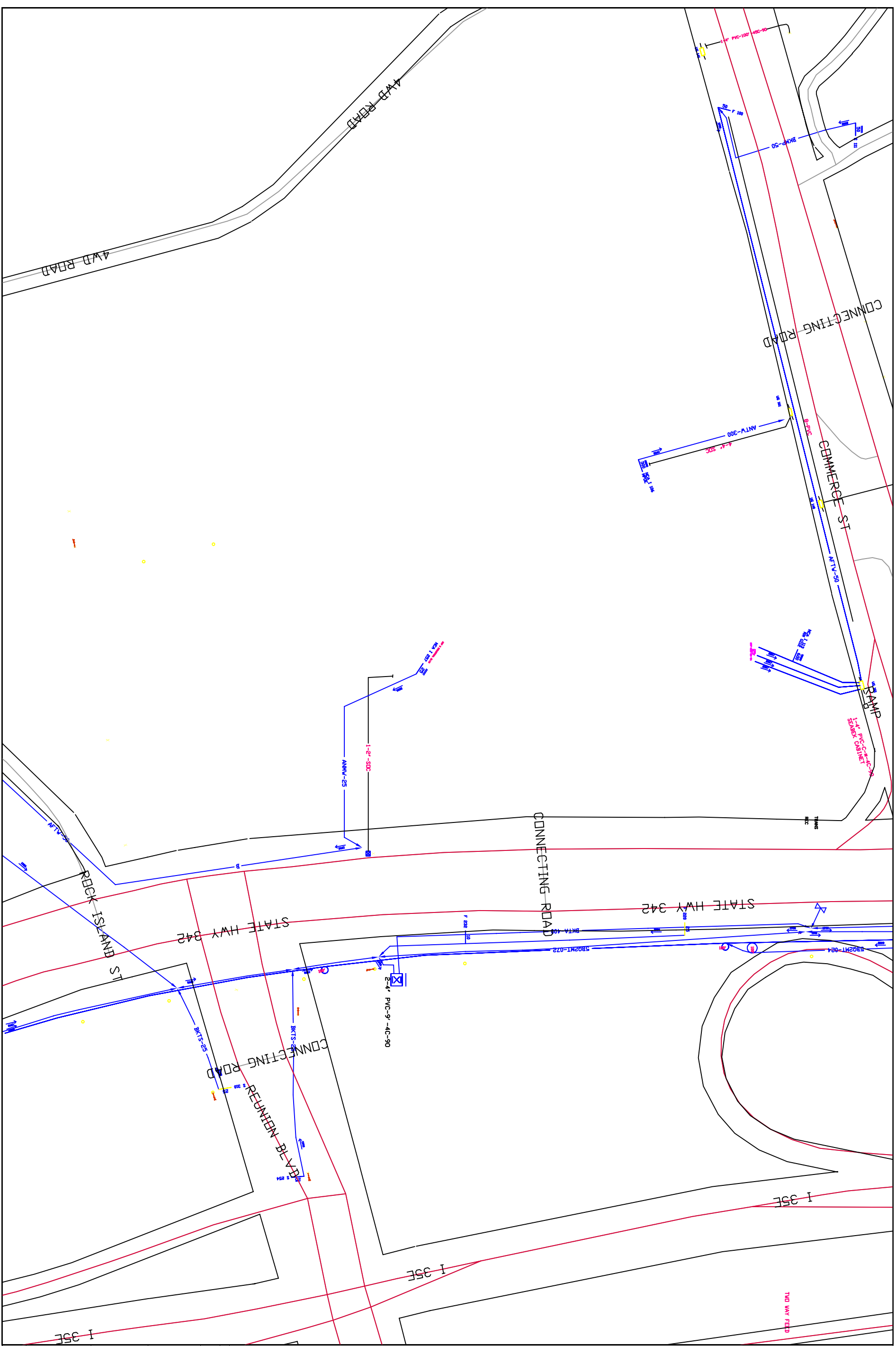

SECTION 1" = 500'
 MARKET AREA DALLAS/FT. WORTH
 NPA/NAB 214741
 EXCHANGE RIVERSIDE
 GEN. LOCAL 119741
 TAX DISTRICT 28009

SOUTHWESTERN BELL TELEPHONE COMPANY
 ENGINEERING Not for Construction Outside
 Except Under Written Agreement
 697-425-86-3
 697-425-86-4
 697-425-86-1
 697-425-86-1
 Map Type PLR
 Update: 11/07/2011

Adjacent Maps
 697-425-86-4
 697-425-86-4
 705-425-16-1
 697-425-86-1
 Map Type PLR
 Update: 11/07/2011

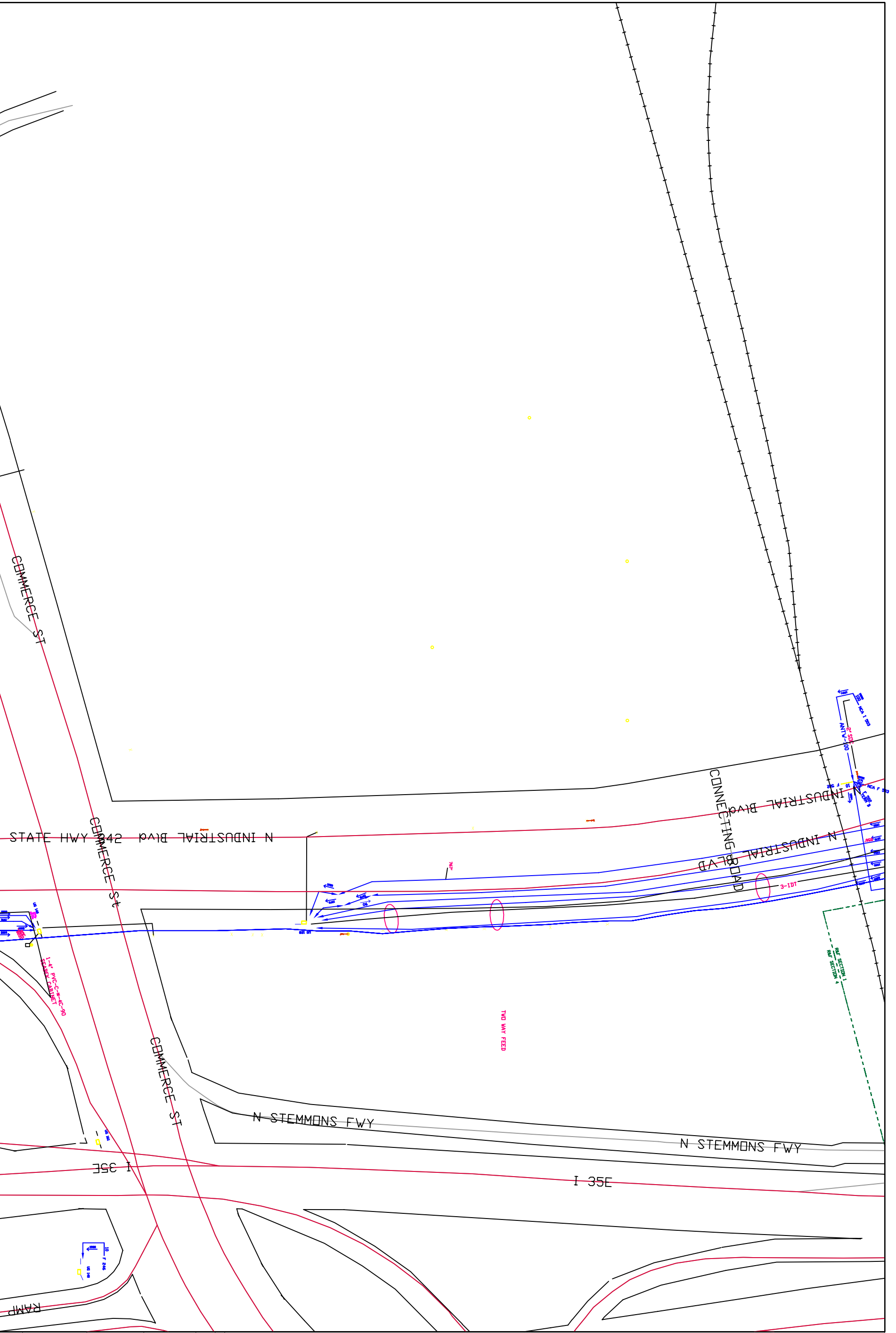

SOUTHWESTERN BELL TELEPHONE COMPANY
 ENGINEERING No. 497, Division 4, Outside
 Service Unit, Utilities Department

Approx. 1" = 500'
 Scale: 1" = 500'

Market Area: DALLAS/FT. WORTH
 MAP/NO: 41741
 Exchange: RIVERSIDE
 Geo. Loc: TH3741
 Tax District: 38009

Adjacent Maps:
 N: 697-429-87-3
 S: 697-429-86-3
 E: 705-429-16-2
 W: 697-429-86-2

Map Type: P.L.R.
 Date: 6/27/81
 Update: 11/07/81

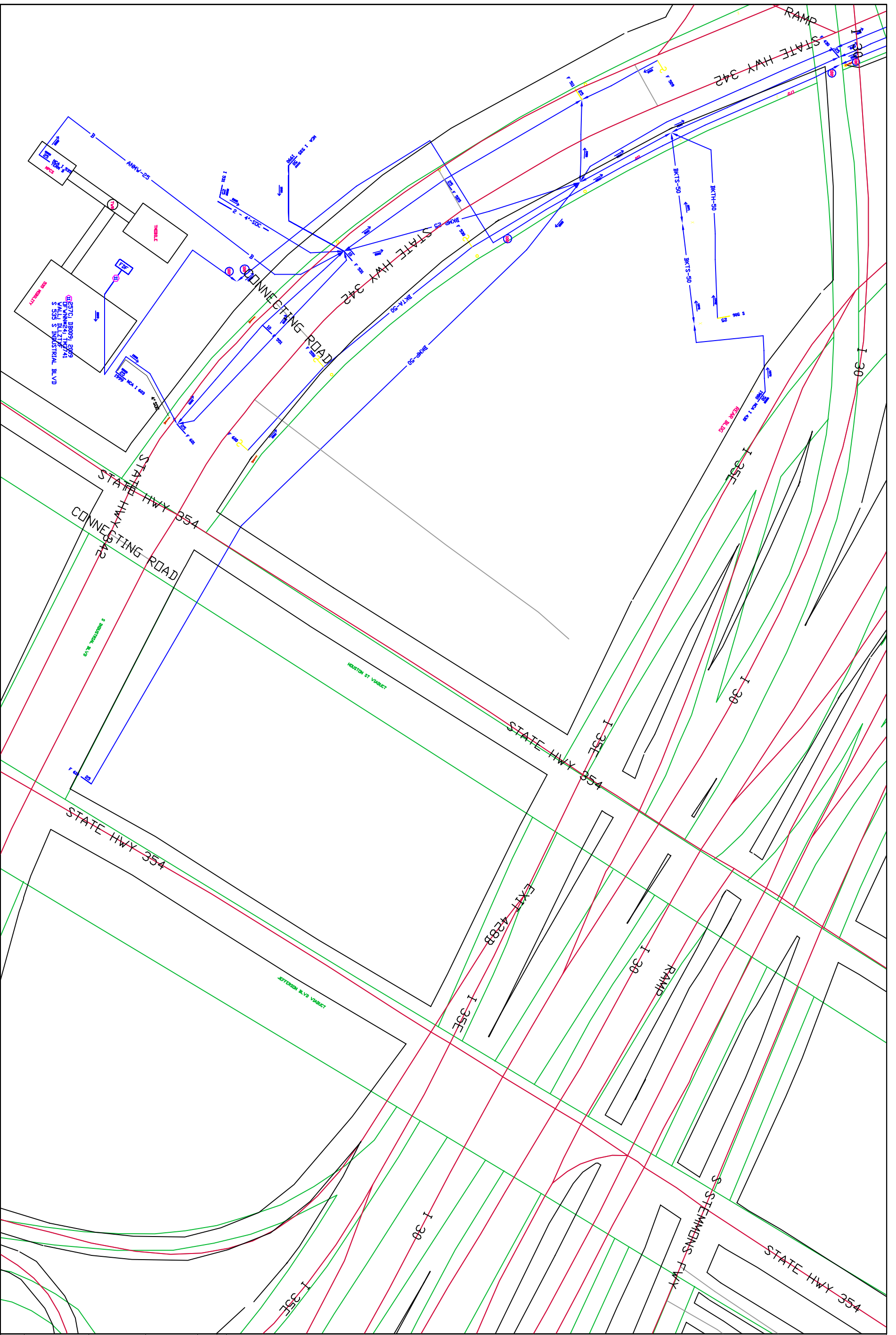

SOUTHWESTERN BELL TELEPHONE COMPANY
 ENGINEERING Not for Disclosure Outside
 Except Under Written Agreement

SECTION 1" = 500'
 MARKET AREA DALLAS/FT. WORTH
 NPA/NO. 214741
 EXCHANGE RIVERSIDE
 GEO. LOCAL 119741
 TAX DISTRICT 30099

ADJACENT MAPS
 N 705-653-15-2
 S 705-653-14-2
 E 705-653-15-3
 W 697-625-05-3
 MAP TYPE PLR
 MAP
 705-653-15-1
 UPDATE 11/07/2011

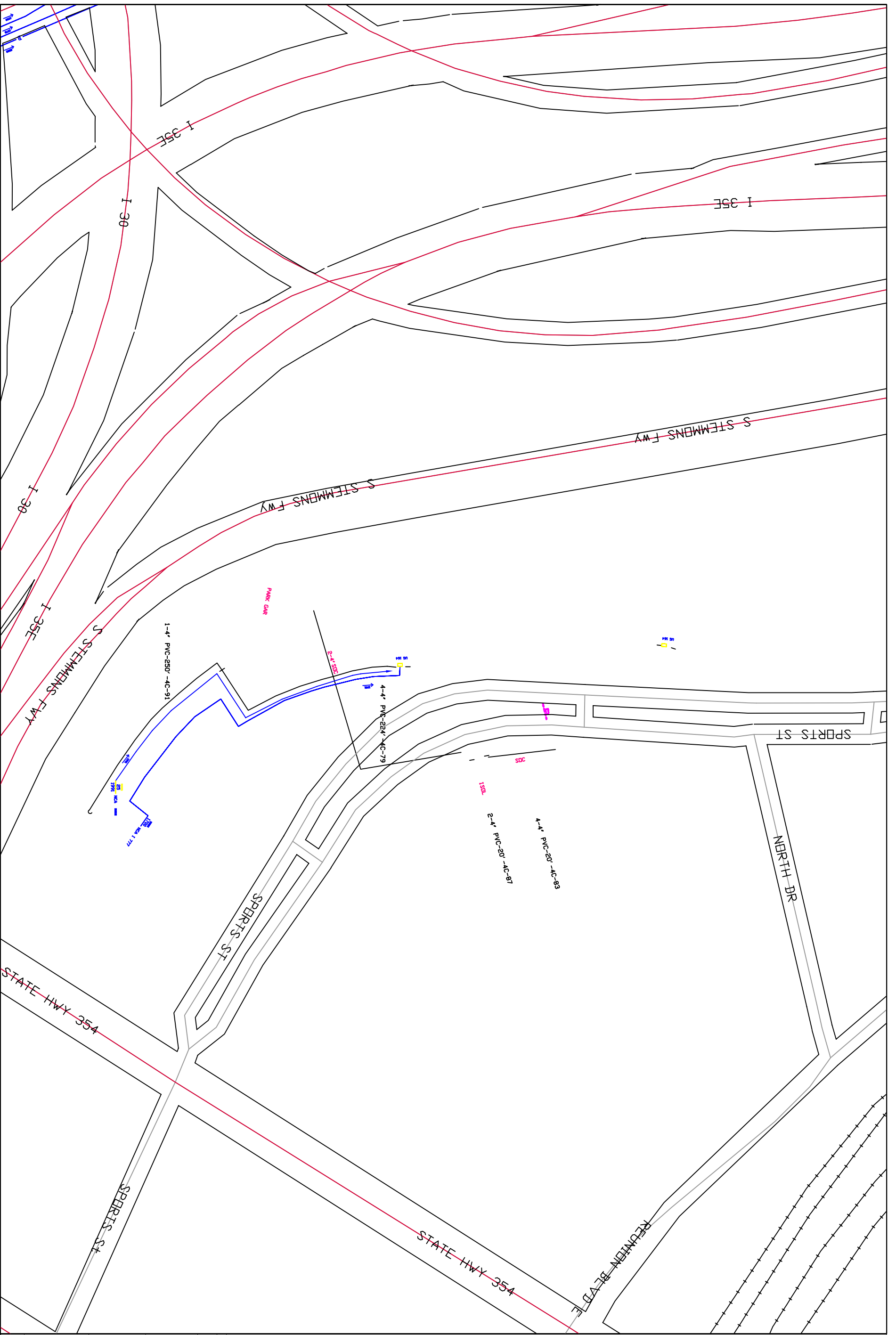

SOUTHWESTERN BELL TELEPHONE COMPANY
 ENGINEERING Not for Bidding, Outside
 Except Under Written Agreement
 Update: 11/07/2011

SECTION: 1" = 50.0'
 SCALE: 1" = 50.0'

Market Area: DALLAS/FT. WORTH
 NPA/NAO: 214/741
 Exchange: RIVERSIDE
 Geo. Loc: 178741
 Tax District: 28009

Adjacent Maps:
 N: 705-625-16-1
 S: 705-625-15-1
 E: 705-625-15-4
 W: 697-625-25-4

Map:
 705-625-15-2
 Update: 11/07/2011

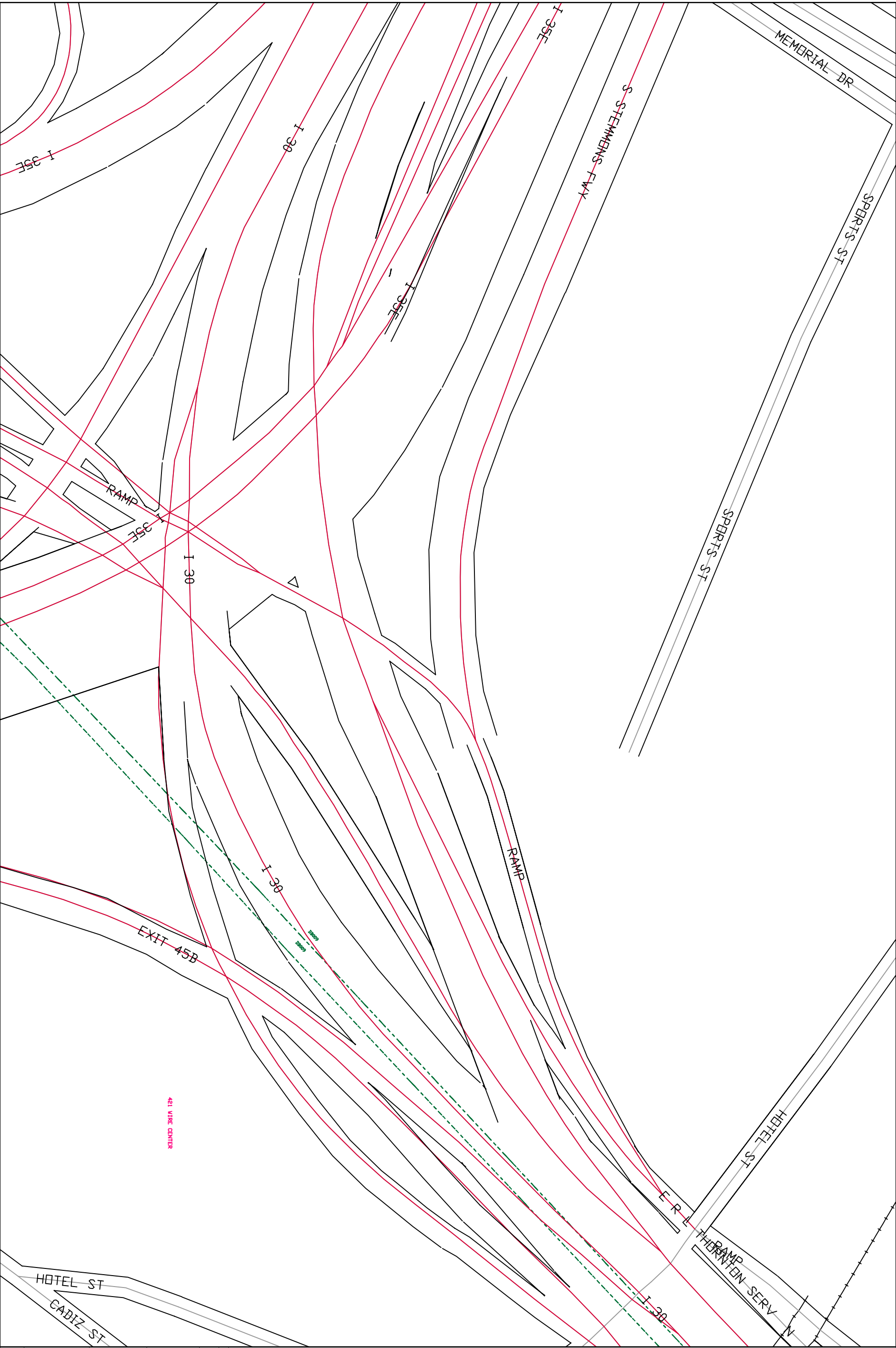

SOUTHWESTERN BELL TELEPHONE COMPANY
 ENGINEERING Not for Disclosure Outside
 Service Area Except Under Written Agreement





SECTION 1" = 500'
 1" = 500'

Market Area DALLAS/FT. WORTH
 NPA/NAO 214/741
 Exchange RIVERSIDE
 Gen. Loc. 1H3741
 Tax Service 28009

Adjacent Maps
 N 705-623-15-4
 S 705-623-14-4
 E 705-623-23-1
 W 705-623-15-1

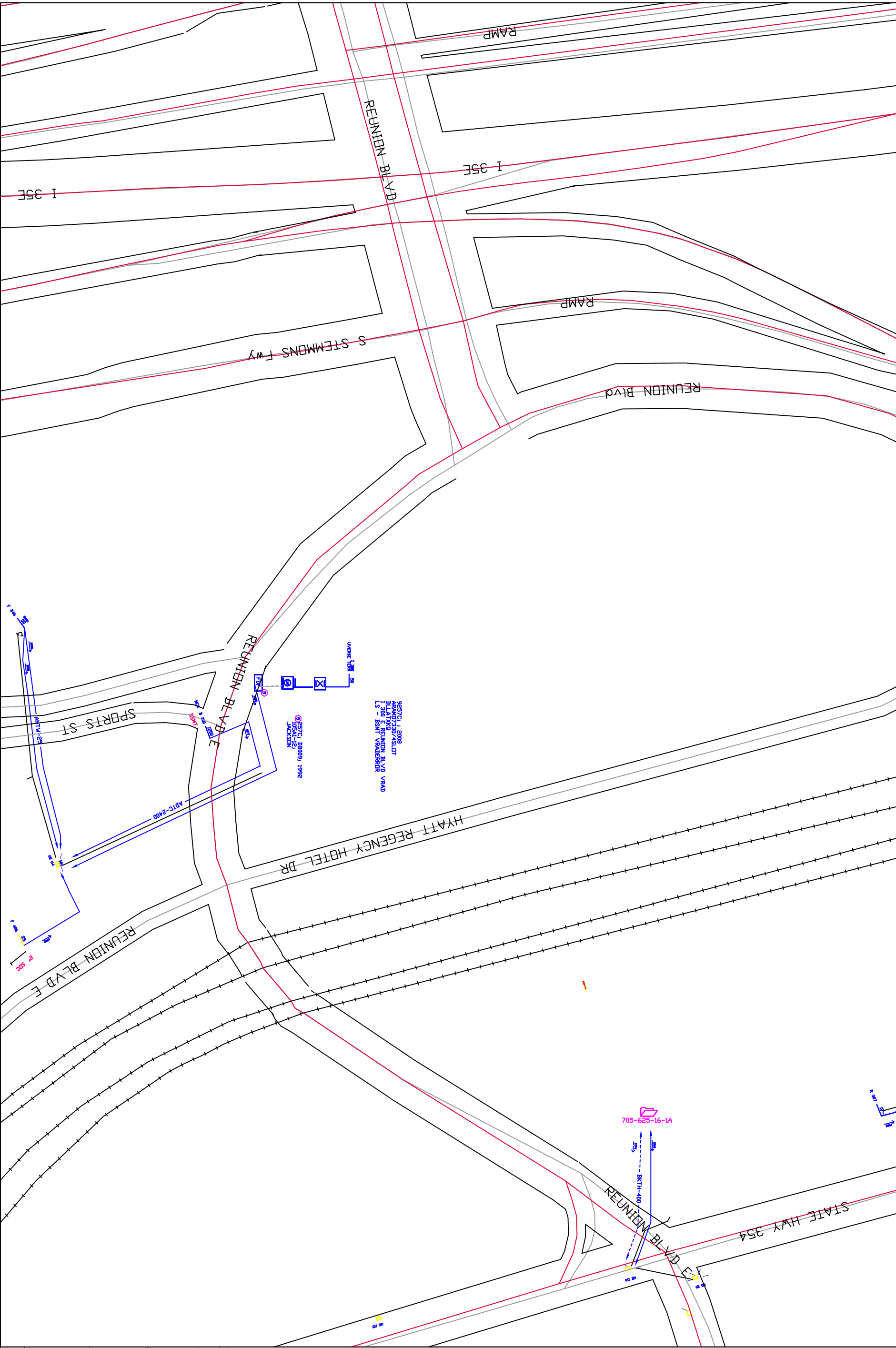
Map Type PLR
 Map
 705-623-15-3
 Update 02/11/2011



 SOUTHWESTERN BELL TELEPHONE COMPANY
 ENGINEERING Not for Disclosure Outside
 Except Under Written Agreement

SECTION 1' = 50.0' MARKET AREA DALLAS/FT. WORTH NPA/NAB 214741 EXCHANGE RIVERSIDE GEO. LOCAL 119741 TAX DISTRICTS 38009	ADJACENT MAPS N 705-625-16-2 S 705-625-15-2 E 705-625-16-3 W 697-625-86-3	MAP TYPE P.L.R. MAP 705-625-16-1 Update: 11/07/2011	
--	---	--	--

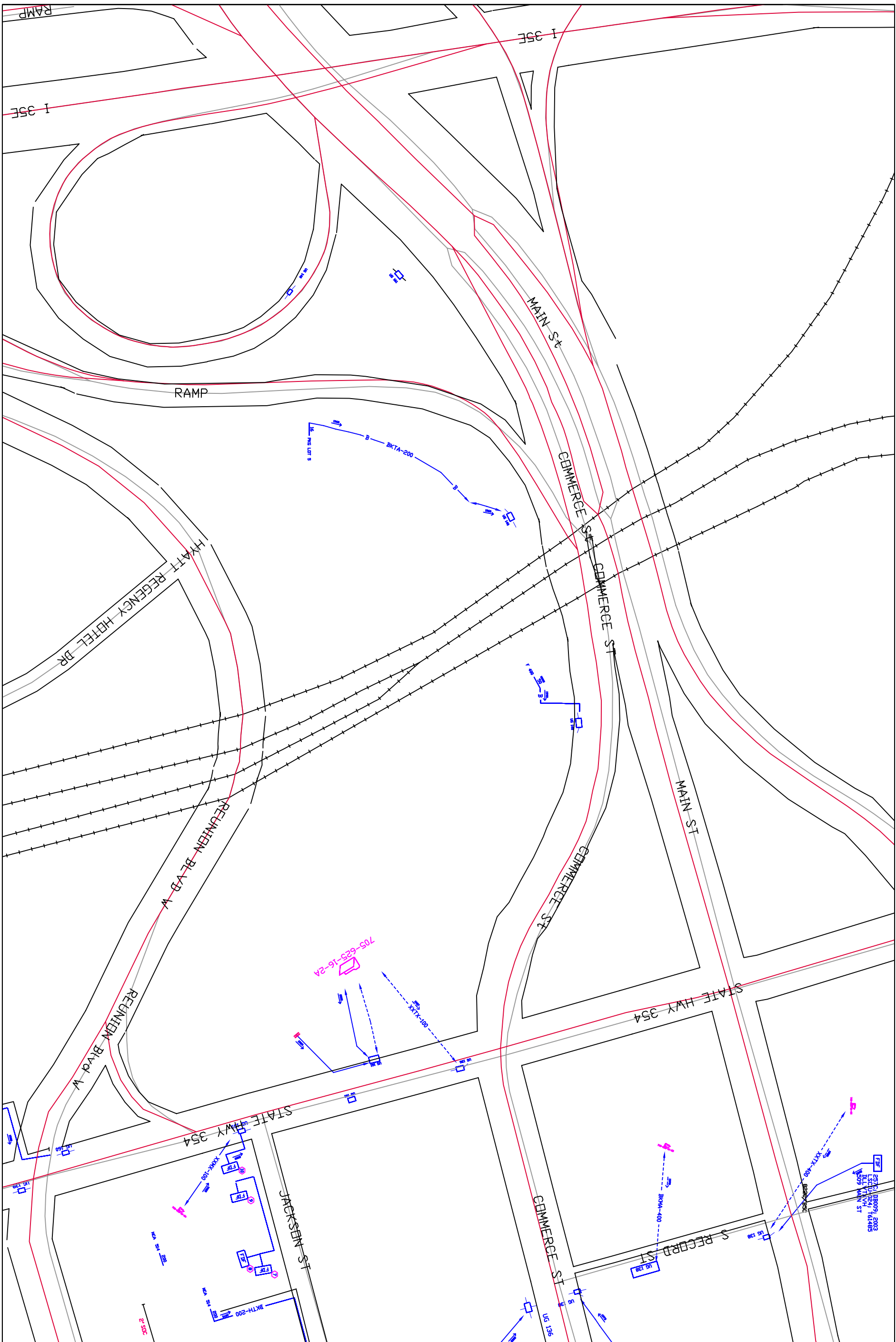

- ④456CJ, DB009, 2009
FVYVWME24, TN3741
SITE 3 HOUSTON ROOFTOP CELL SITE
- ④456CJ, DB009, 2009
FVYVWME24
SITE 3 HOUSTON MOBILITY HUT
- ④456CJ, DB009, 2009
FVYVWME24, TN3741
SITE 3 HOUSTON
- ④585CJ, DB009, 2009
FVYVWME24, TN3741
SITE 3 HOUSTON BSMT

2" = 50'
 Scale: 1" = 50'
 Project: 705-625-16-24
 Location: DALLAS/FT. WORTH
 705-625-16-24
 705-625-16-1
 705-625-16-4
 697-625-86-4
 Map Type: NLS
 Update: 1/17/2011

SOUTHWESTERN BELL TELEPHONE COMPANY
 REGISTRATION: Not for Reseller's Use
 Records from this registration are property
 of the company.

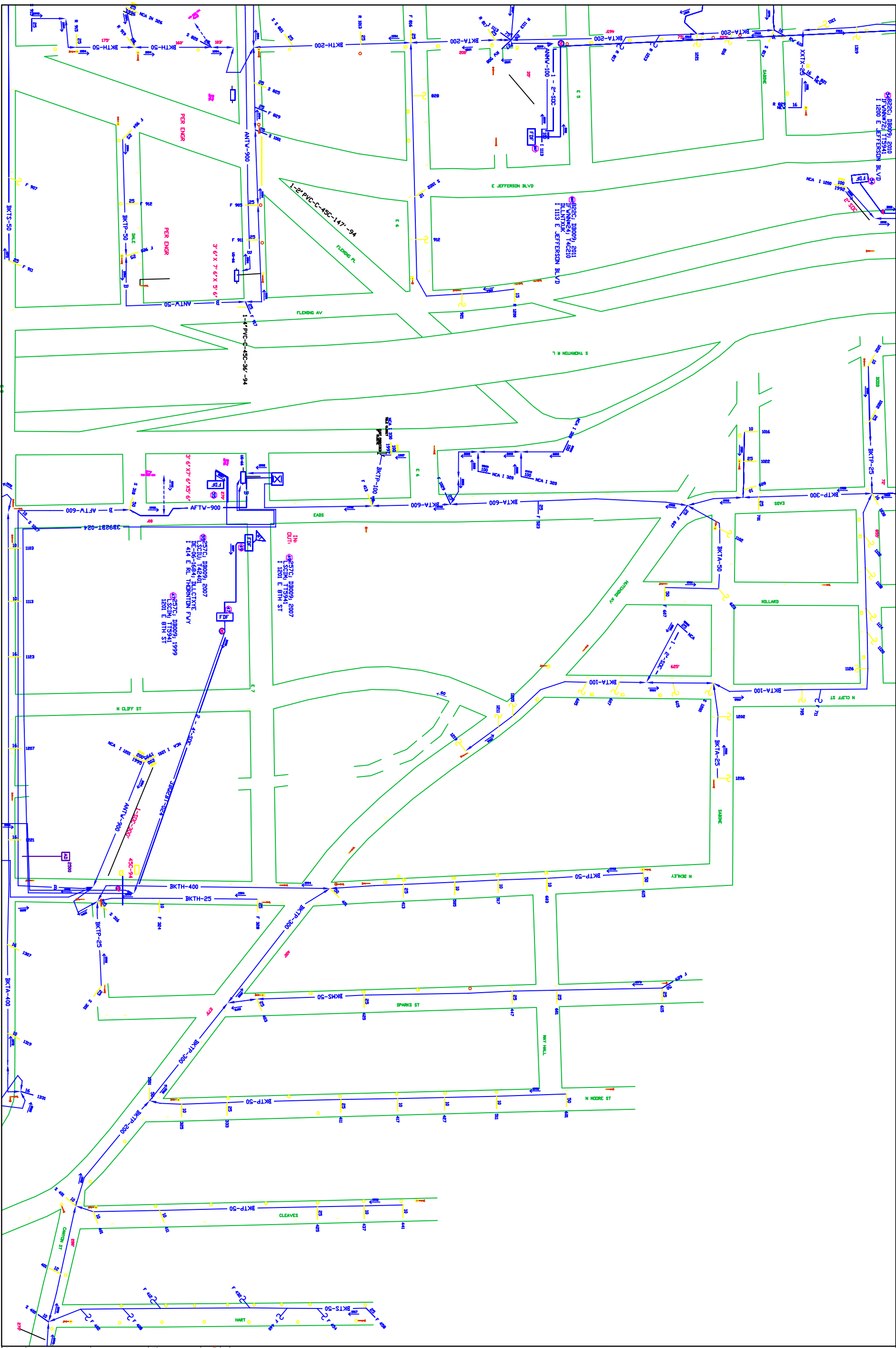

SOUTHWESTERN BELL TELEPHONE COMPANY
 PROTECTIVE WORKS AND ENGINEERING, DALLAS
 PROJECT: 705-625-11
 DATE: 10/26/2011

Section 1" = 104.8'
 Scale 1" = 104.8'
 Survey Area: DALLAS/FT. WORTH
 Network: 814941
 Exchange: WHITWALL
 Gen. Loc: T1994
 Tax District: 28099

Adjacent Maps:
 N 705-625-13
 S 705-625-11
 E 705-625-22
 W 697-625-82-3

Map Type: PLR
 Date: 10/26/2011

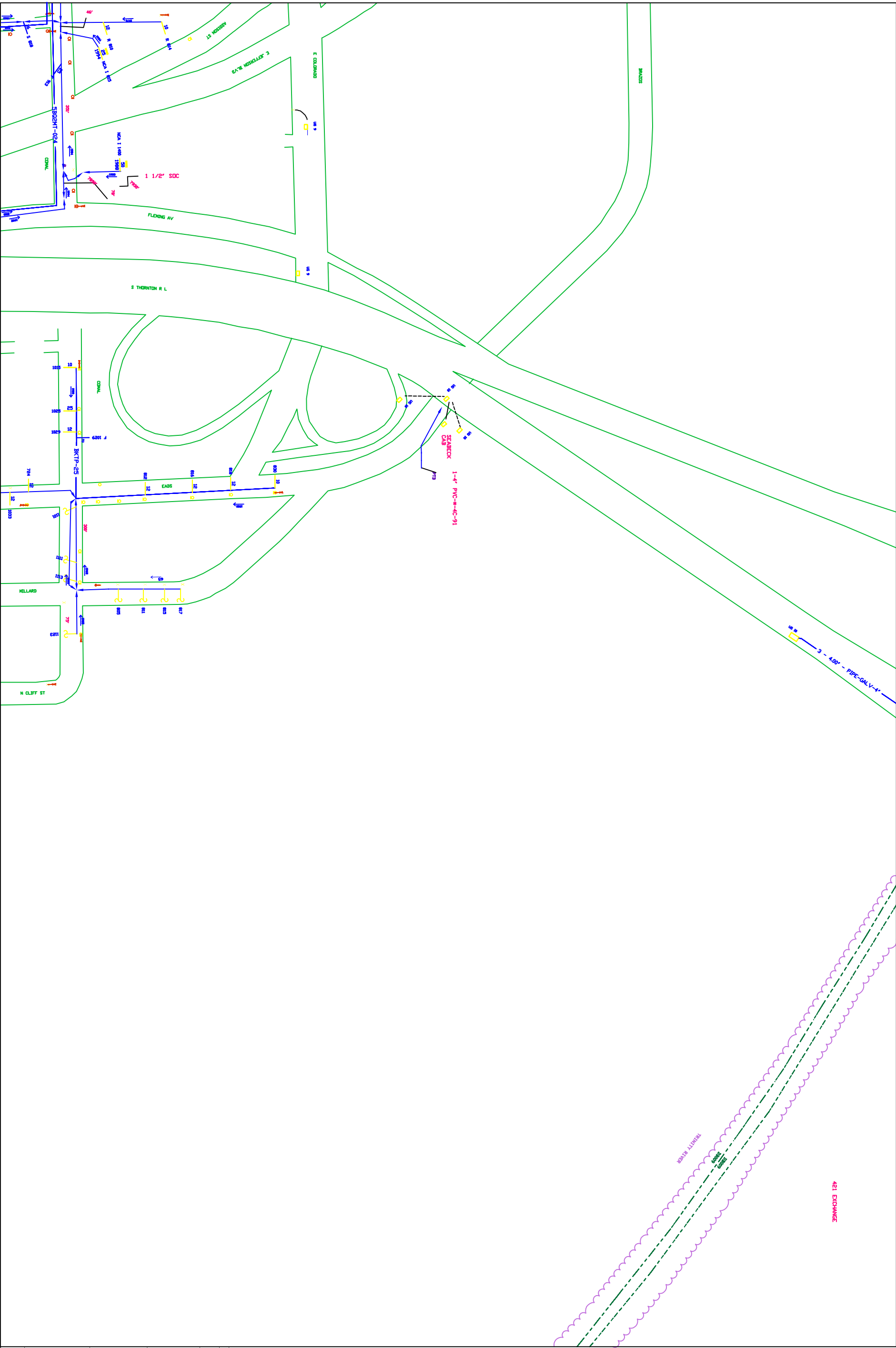

421 EXCHANGE

TRINITY RIVER

SOUTHWESTERN BELL TELEPHONE COMPANY
 PROJECTIONS ARE NOT TO BE DISCLOSED OUTSIDE
 EXCEPT UNDER WRITTEN AGREEMENT



SECTION 1" = 104.8'
 1" = 104.8'

Market Area DALLAS/FT. WORTH
 NPA/NXX 214/941
 Exchange VINTHILL
 Geo. Loc. T79941
 Tax Districts 38009

Adjacent Maps
 N 705-625-14
 S 705-625-12
 E 705-625-23
 W 697-625-83
 Map Type P.L.R.

Map
 705-625-13
 Update: 10/26/2011

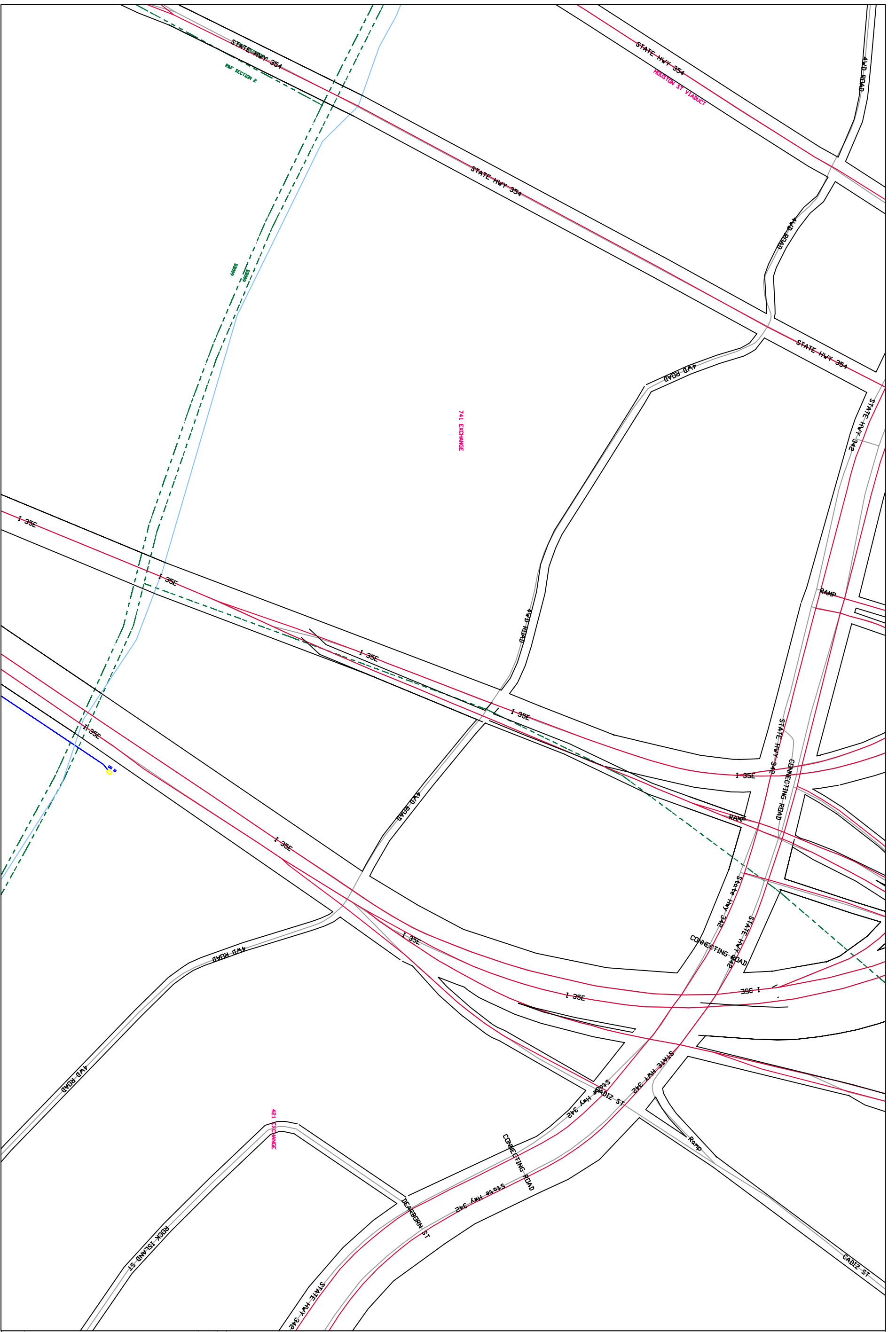

SOUTHWESTERN BELL TELEPHONE COMPANY
 PROJECT AREA NOT A BELLWORKS OUTSIDE
 EXCEPT UNDER WRITTEN AGREEMENT

SECTION 1" = 500'
 1" = 500'
 1" = 1000'

Market Area DALLAS/FT. WORTH
 WPA/MSO 81941
 Exchange VINTHILL
 Gen. Loc. T10941
 Tax District 38009

Adjacent Maps
N 705-625-15
S 705-625-13
E 705-625-14
W 697-625-14
Map Type PLR
Map 705-625-14
Updated 10/26/2011