

I-20 / BRYANT IRVIN BRIDGE CLOSURE

Start Time: November 21 8:00 p.m.
 End Time: November 22 5:00 a.m.

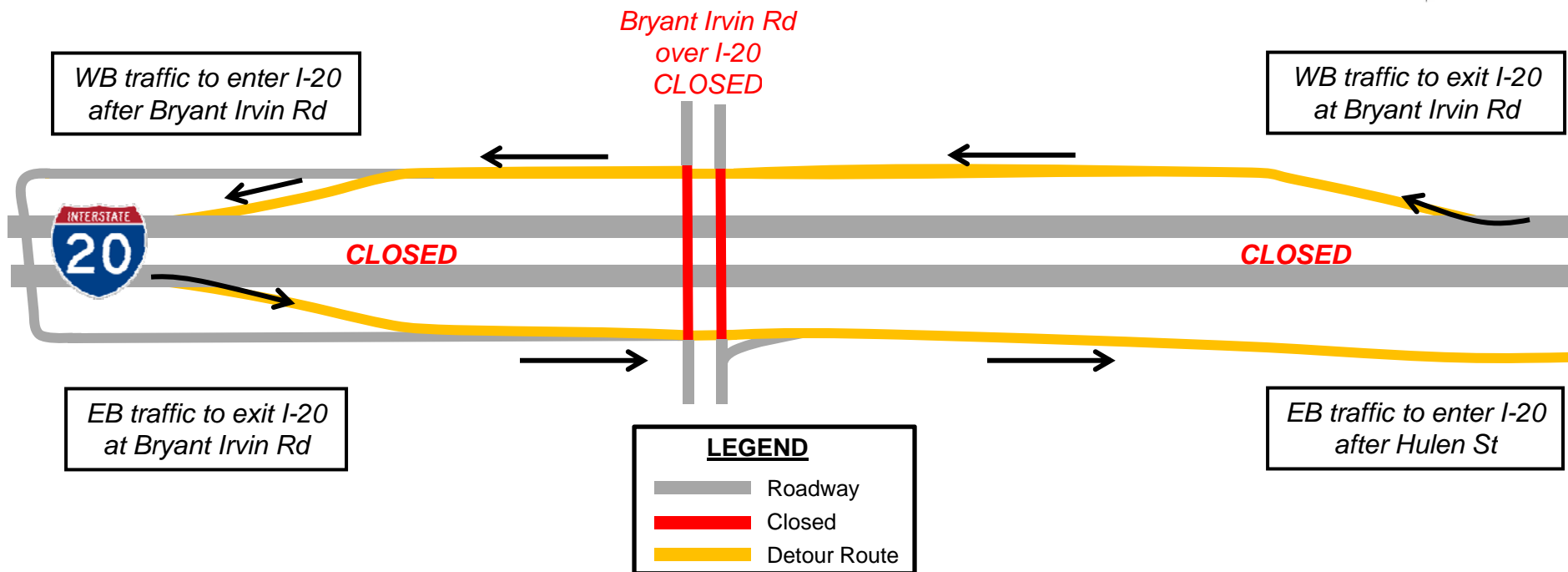

WHY: To pour concrete for the new Bryant Irvin turnaround bridge deck

WHAT: I-20 main lanes will be closed in advance of Bryant Irvin and the Bryant Irvin bridge will be closed overnight to thru traffic over I-20.

Information provided by:
 Project Mobility Coordinator
 (817) 462-0525

Prepared November 16, 2010

