





# CHISHOLM TRAIL PARKWAY

## I-20 Westbound Frontage Road Traffic Shift

Wednesday, September 28, 2011

	Existing
	Open new pavement
	Traffic shifts to the left on the frontage road
	Temporary closure during traffic switch (open in November)

For more information:  
 Scott Cooner, P.E.  
 Mobility Coordinator  
 Chisholm Trail 3A  
 (817) 462-0525  
[s-cooner@tamu.edu](mailto:s-cooner@tamu.edu)

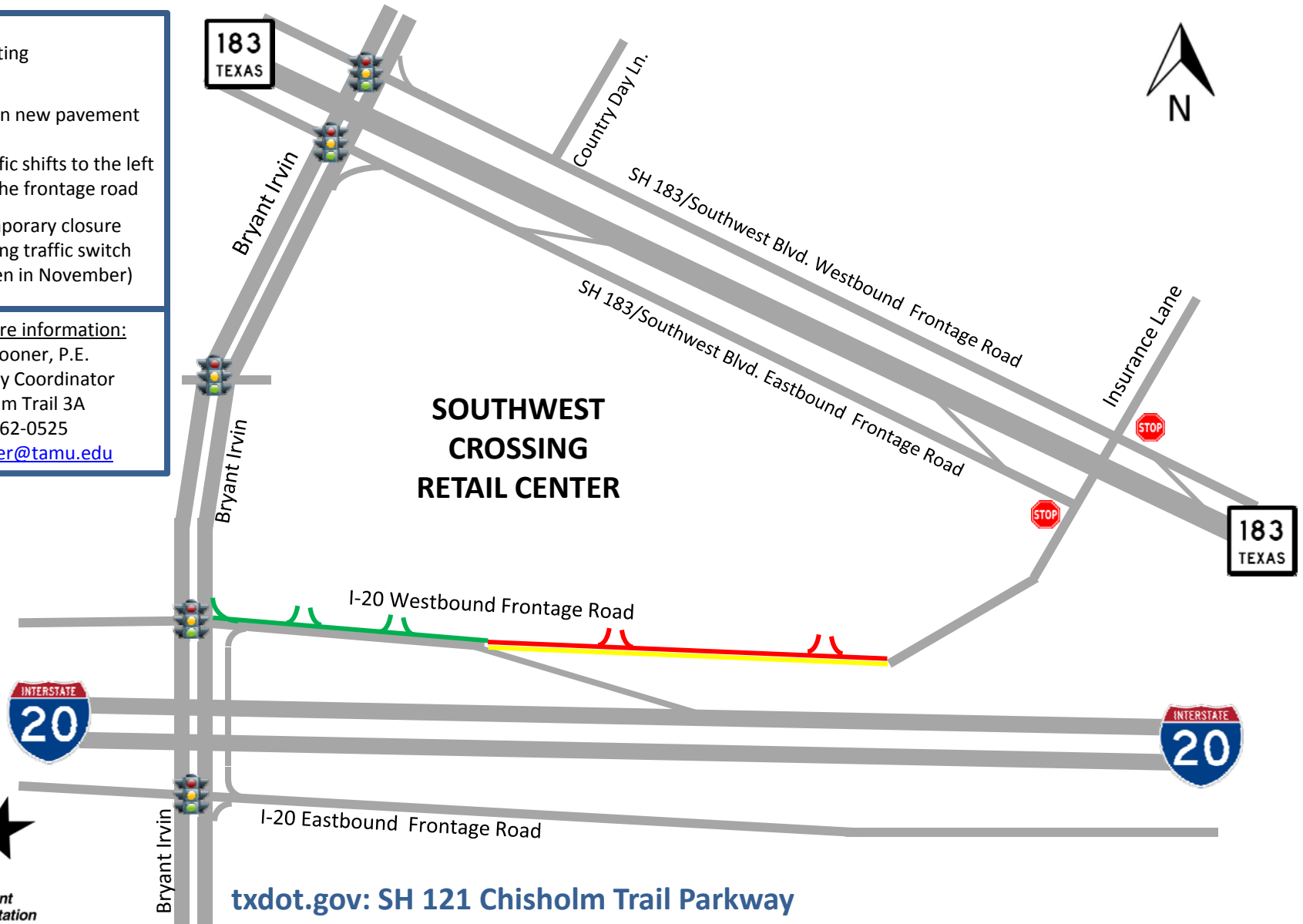

[txdot.gov](http://txdot.gov): SH 121 Chisholm Trail Parkway