



CHISHOLM TRAIL PARKWAY: SECTION 3A

SH 183 Eastbound Bridge Beam Placement

Bryant Irvin Road Detour

From: Thursday, March 14th at 8:00pm
 To: Friday, March 15th at 5:00am

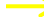
For more information:
 Scott Cooner, P.E.
 Mobility Coordinator
 Chisholm Trail 3A
 (817) 462-0525
s-cooner@tamu.edu

-  Northbound Bryant Irvin Detours
-  Southbound Bryant Irvin Detour
-  Bryant Irvin **CLOSED** under SH 183
-  Future Chisholm Trail Parkway

183
TEXAS



Crews will be placing new concrete beams for the eastbound SH 183 main lane bridge over Bryant Irvin Road. One main lane in each direction on SH 183 will remain open over Bryant Irvin Road. All traffic on Bryant Irvin Road at SH 183 will be detoured during the beam placement.

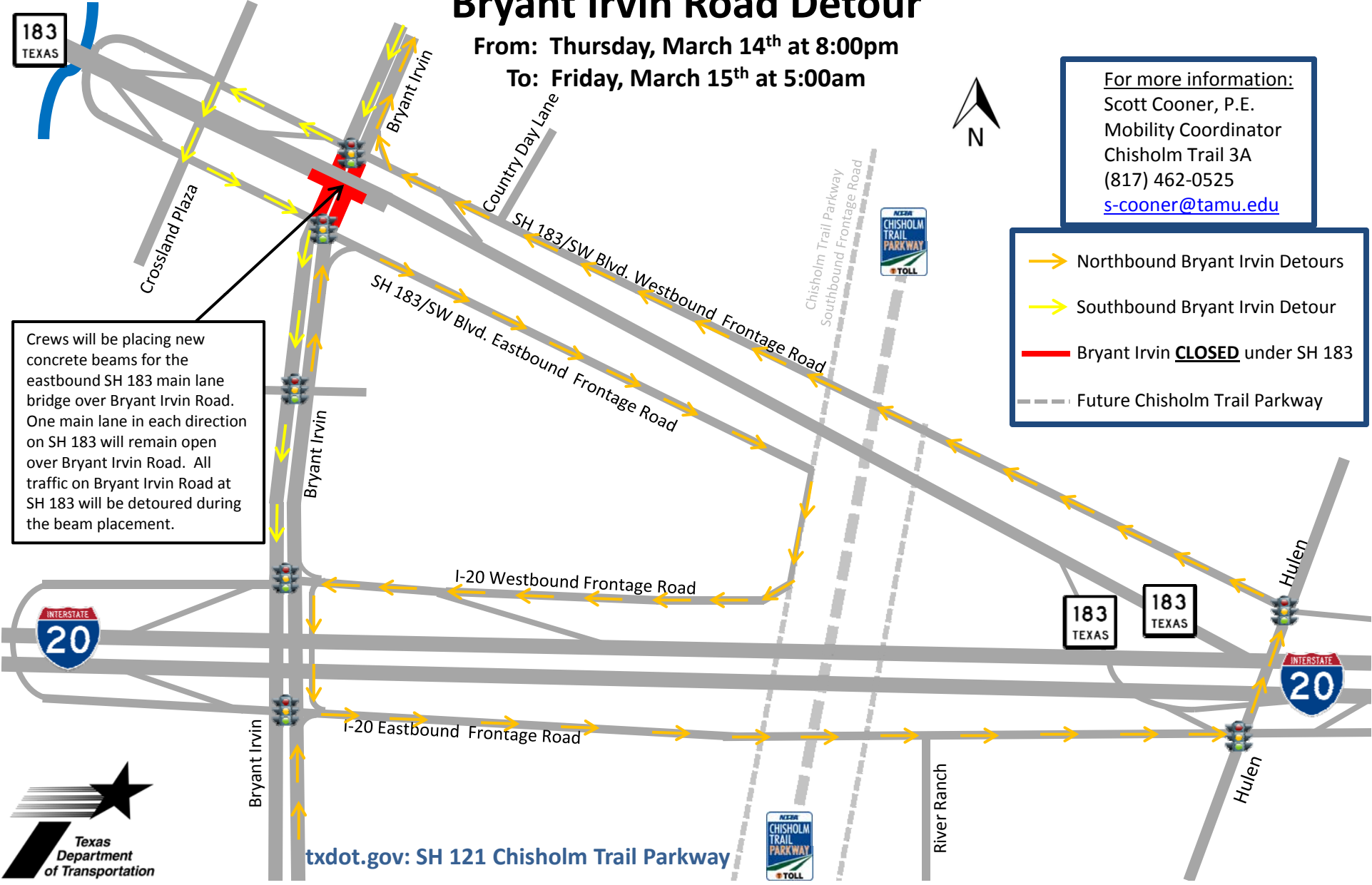

txdot.gov: SH 121 Chisholm Trail Parkway



183
TEXAS

183
TEXAS

INTERSTATE
20

River Ranch

Hulen

Hulen

Bryant Irvin

Bryant Irvin

SH 183/SW Blvd. Eastbound Frontage Road

I-20 Westbound Frontage Road

I-20 Eastbound Frontage Road

Country Day Lane

Chisholm Trail Parkway
Southbound Frontage Road

Crossland Plaza

Bryant Irvin