

DISCLAIMER: The use of this standard is governed by the "Texas Engineering Practice Act". No warranty of any kind is made by TxDOT for any purpose whatsoever. TxDOT assumes no responsibility for the conversion of this standard to other formats or for incorrect results or damages resulting from its use.

https://www.dot.state.tx.us/ftw/spec/info/standard.htm csddf.w.dgn

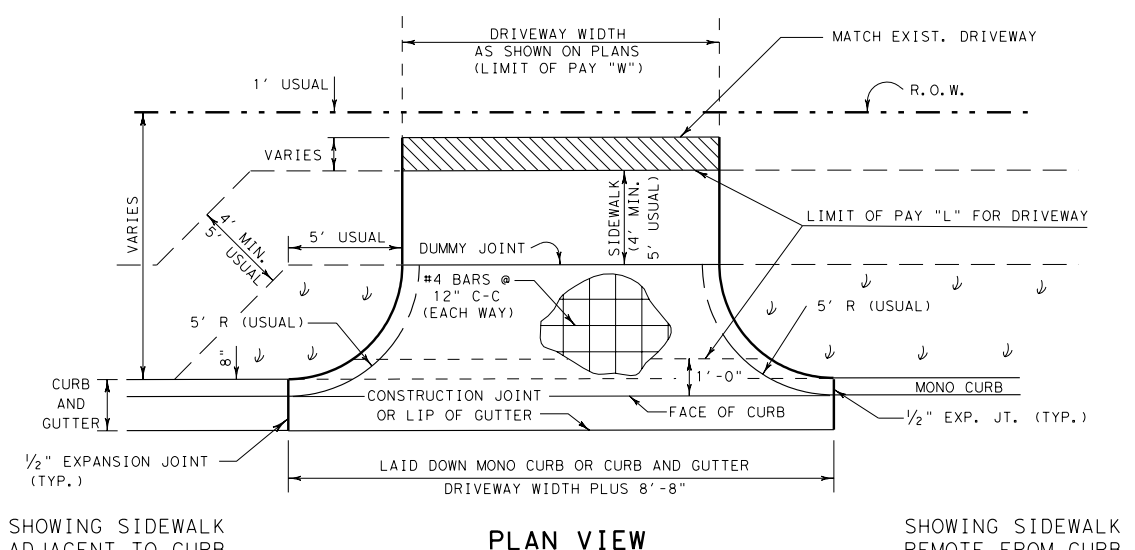

PAY AREA FOR DRIVEWAY SHALL BE THE PRODUCT OF "L" x "W"

S. Y. NON-PAY CONCRETE IN DRIVEWAY RADIUS	
2-90° RADII (FT)	S. Y. NON-PAY CONC.
5	0.42
10	3.04
20	15.36
30	37.19

↓ SEEDING OR OTHER SURFACE NOT SUITABLE AS PEDESTRIAN WALKWAY.

NOTE: AREA ADJACENT TO DRIVEWAY CURB SHALL NOT BE PAVED, BUT SHALL BE SEEDED OR LANDSCAPED.

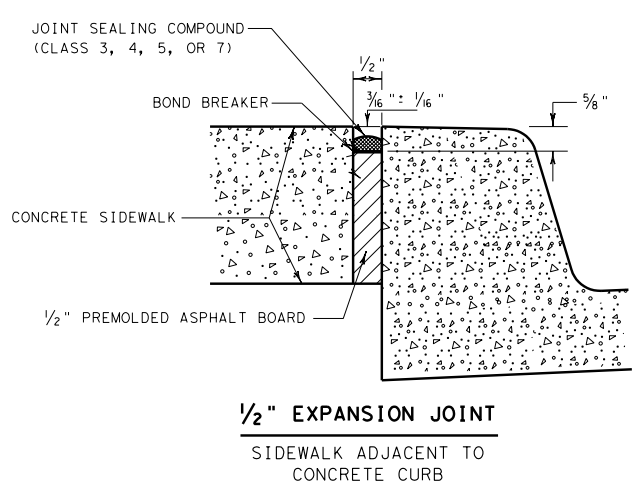
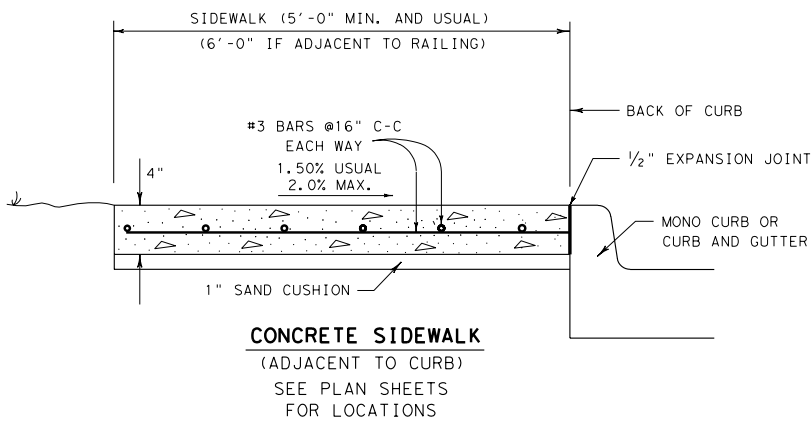
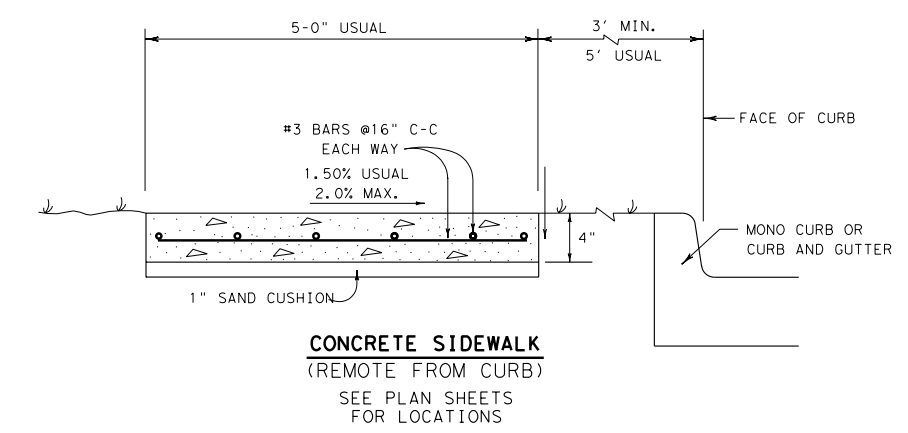
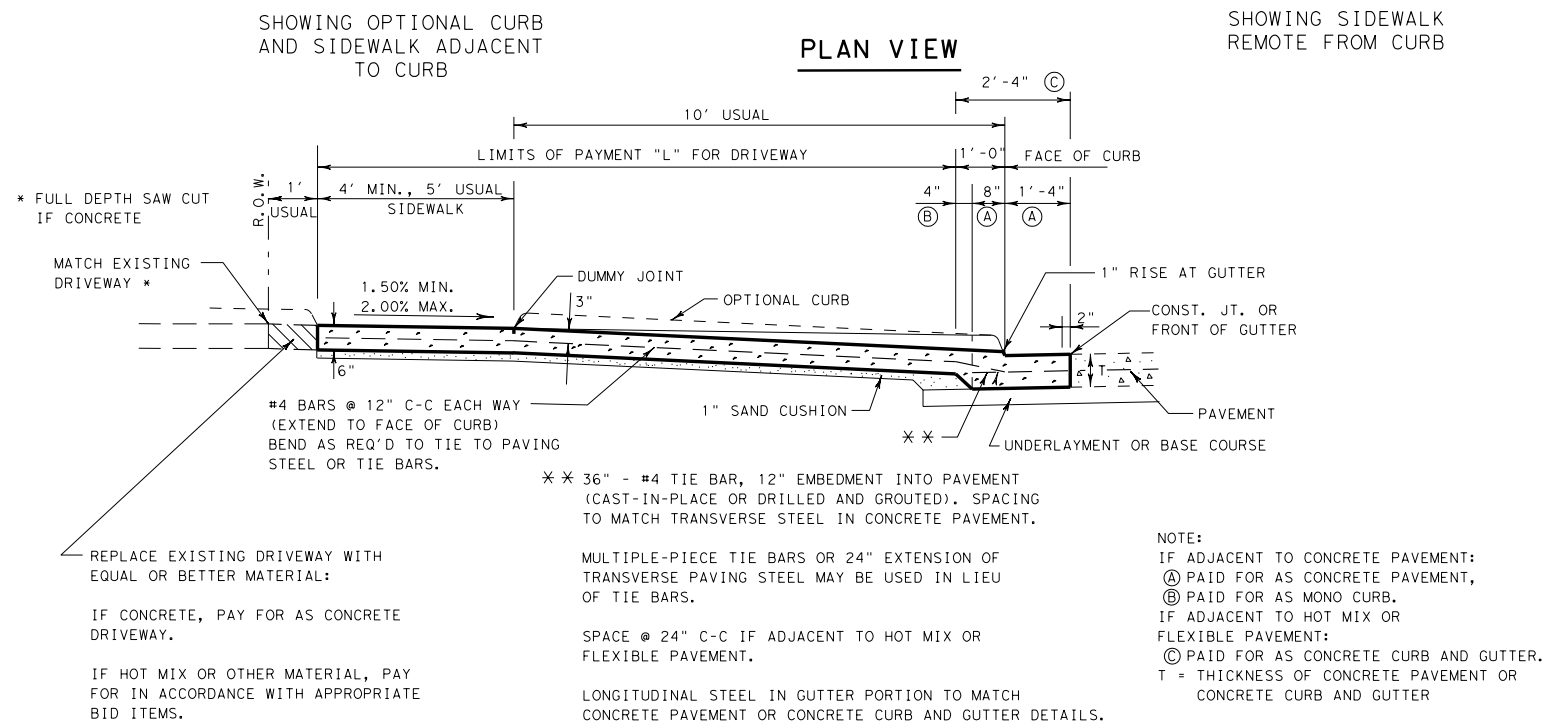
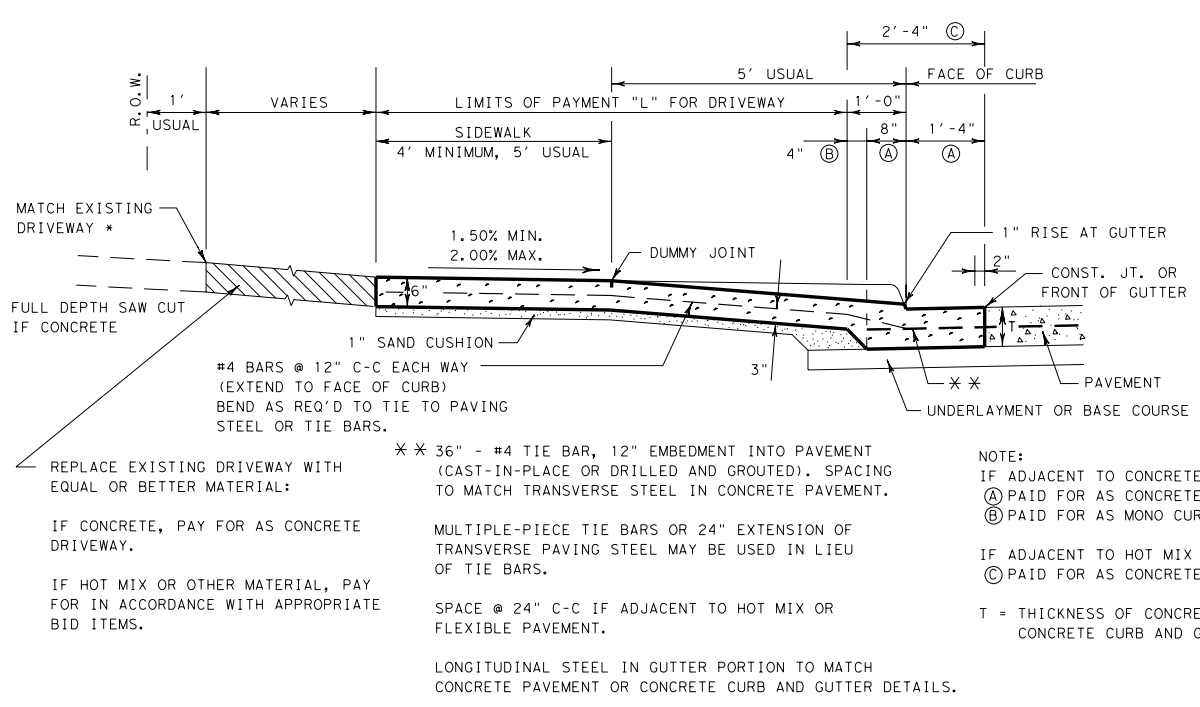
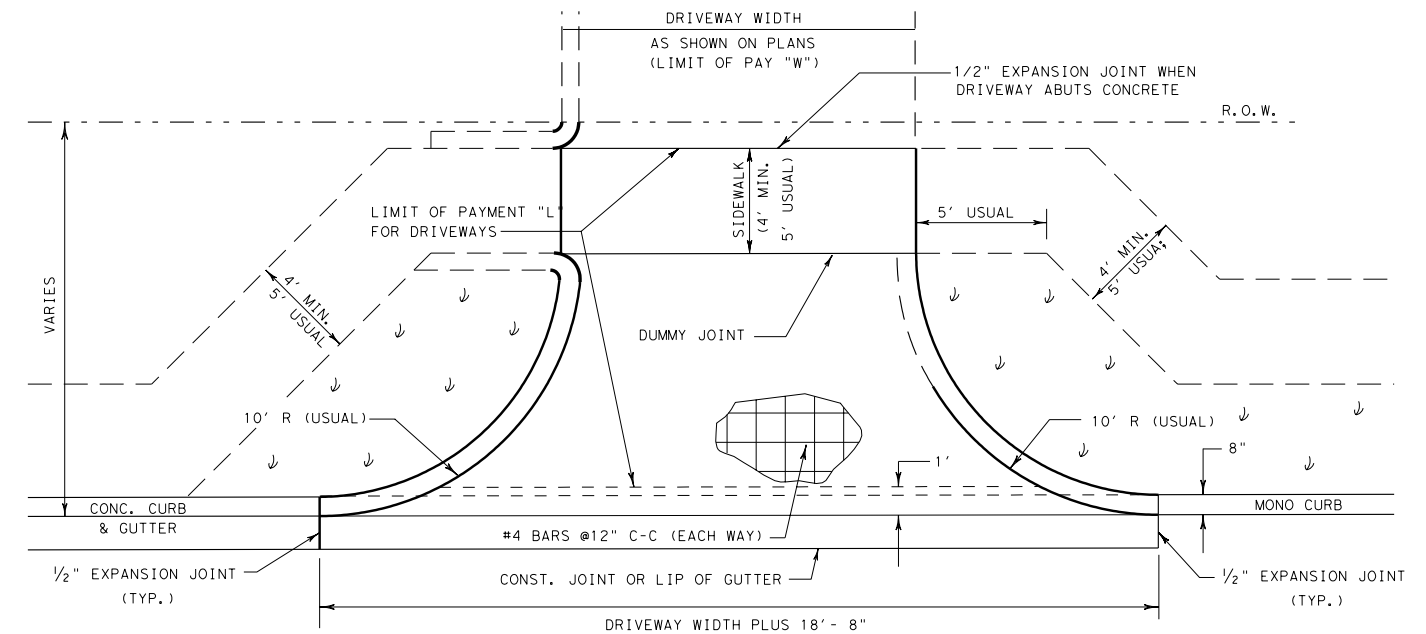

**CONCRETE SIDEWALK DETAILS**



**CONCRETE SIDEWALK AND DRIVEWAY DETAILS**  
CSDD-00 (FW)

ORIGINAL DRAWING	FED. RD. DIV. NO.	PROJECT NO.	SHEET NO.
JUNE 2000	6		
REVISIONS:	STATE	DIST.	COUNTY
7/2003 - Clarify driveway joint at pavement as tied.	TEXAS		
4/2005 - Corrected sidewalk reinf.	CONT.	SECT.	JOB HIGHWAY NO.

© 2003 by Texas Department of Transportation; all rights reserved.