

**NOTES:**

1. EDGE BEAM SHALL BE STRAIGHT, OR FORM A SMOOTH CURVE, SO AS TO COMPLEMENT THE ALIGNMENT OF PAVING STONES.
2. SIDES OF EDGE BEAM SHALL BE VERTICAL.

1 CONC. EDGE & PAVER DETAIL  
(SECTION A-A)

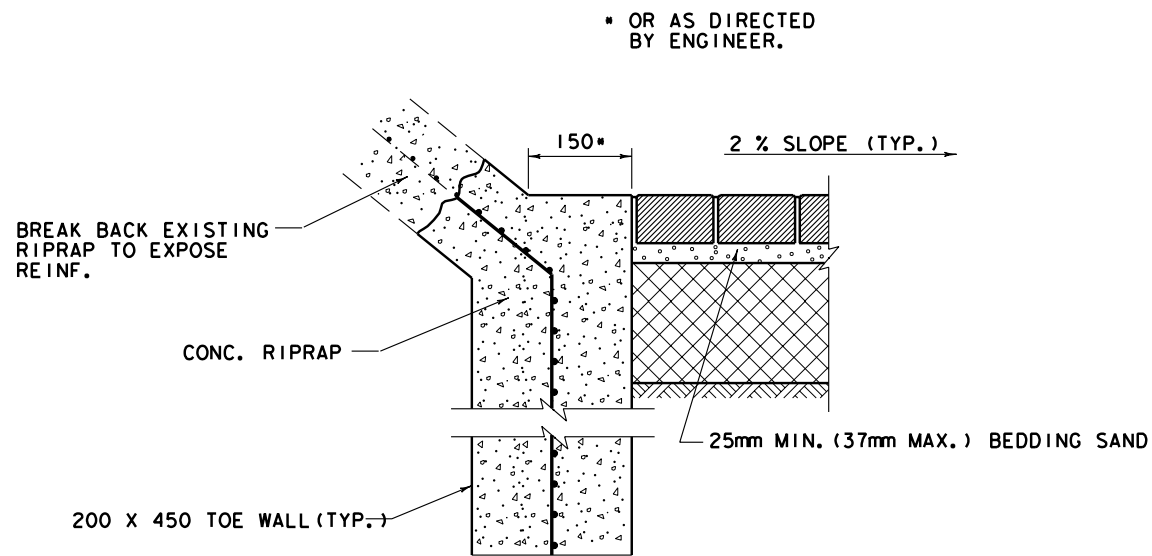

4 PAVER DETAIL AT RIPRAP SLOPE

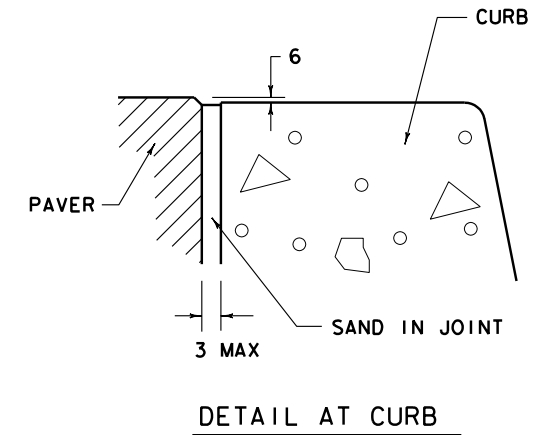

DETAIL AT CURB

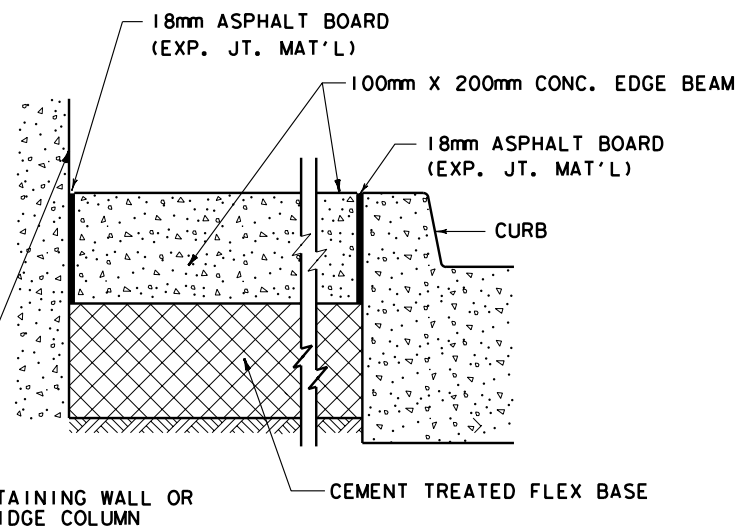

2 CONC. EDGE BEAM EXPANSION JOINT  
AT CURB, BRIDGE COLUMN OR RETAINING WALL  
(SECTION B-B)

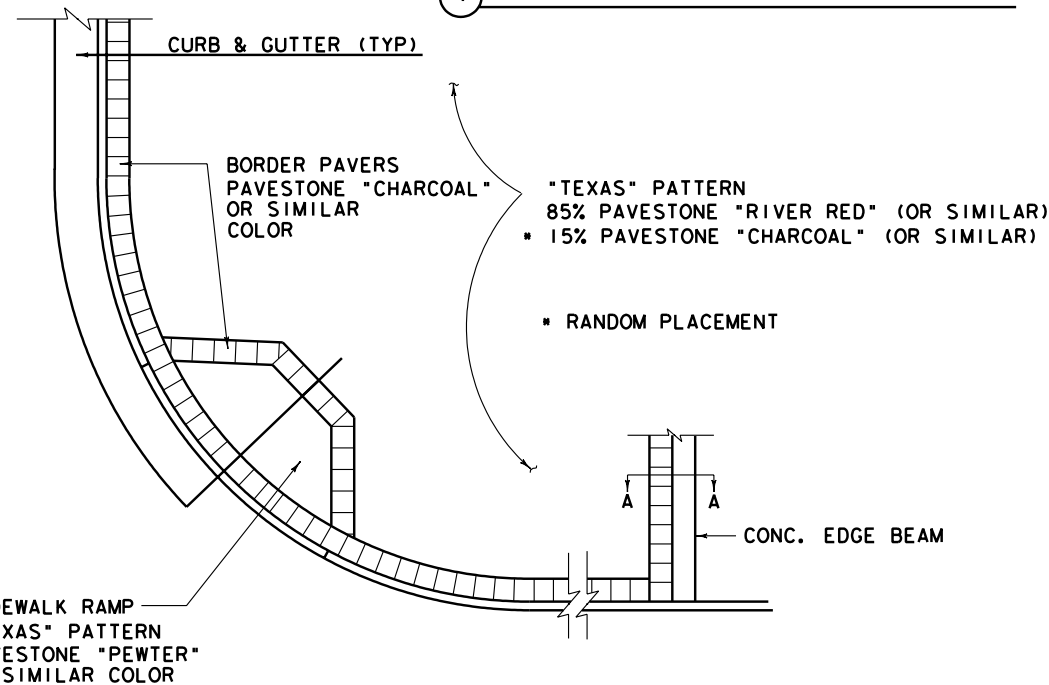

3 TYPICAL PAVER LAYOUT  
NOT TO SCALE

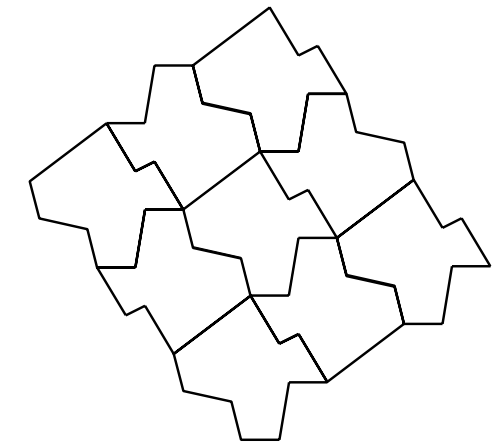

TYPICAL "TEXAS" PATTERN  
NOT TO SCALE

NOTE:  
Paver shape is for illustration only. Exact Paver shape and dimensions may differ by manufacturer.

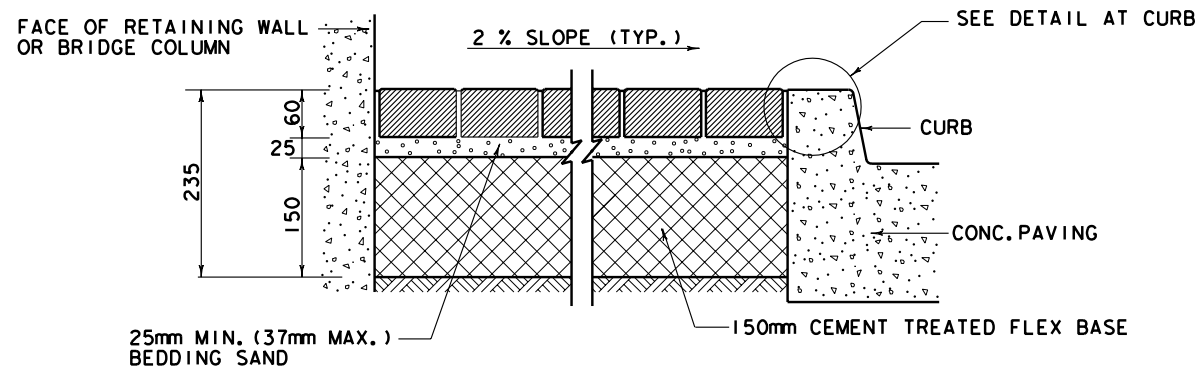

3 PAVER DETAIL AT CURB & AT BRIDGE COLUMN  
OR RETAINING WALL

**NOTES:**

1. Prior to placement of Flex Base, the area to be paved shall be rough graded, and clean of all trash, rocks, plants, roots etc. Materials removed shall be disposed of as directed by the Engineer.
2. Unless otherwise indicated, pavers shall be an interlocking "Texas" shape, of a size approved by the Engineer, with a maximum dimension of less than 12".
3. Border pavers shall be rectangular in shape. The dimensions shall be as approved by the Engineer.
4. Ramps shall conform to a Type 3 Ramp, as shown on Standard Detail Sheet SRD-FW.
5. Density requirements for Flex Base may be waived, if approved by the engineer.
6. Ty IP Cement shall be added to the Flex Base in accordance with Item 275 or 276 at a rate of 4% by weight. No strength is specified.
7. Furnishing and installation of Flex Base, Cement, Bedding Sand, Expansion Joint Material, Joint Sand, and all other materials or labor necessary to complete the work will not be paid for directly, but will be considered subsidiary to Landscape Pavers.
8. All dimensions are in millimeters (mm), unless otherwise indicated.

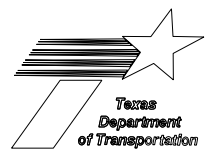

LANDSCAPE PAVER  
DETAILS

LP-98 (FW) (M)

FED. RD. DIV. NO.	FEDERAL AID PROJECT NO.	SHEET NO.
6		
STATE	DIST.	COUNTY
TEXAS		
CONT.	SECT.	JOB HIGHWAY NO.