

DISCLAIMER: THIS STANDARD IS COVERED BY THE "TEXAS ENGINEERING PRACTICE ACT". NO WARRANTY OF ANY KIND IS MADE BY TxDOT FOR ANY PURPOSE WHATSOEVER. TxDOT ASSUMES NO RESPONSIBILITY FOR THE CONVERSION OF THIS STANDARD TO OTHER FORMATS OR FOR INCORRECT RESULTS OR DAMAGES RESULTING FROM ITS USE.

https://www.dot.state.tx.us/ftw/specinfo/standard.htm  
 11/10/2020 10:20:48 AM  
 P:\PROJECTS\TXDOT\16121\5 FTW Standards Revision\CADD\Modifications in Progress\csab-ftw.dgn

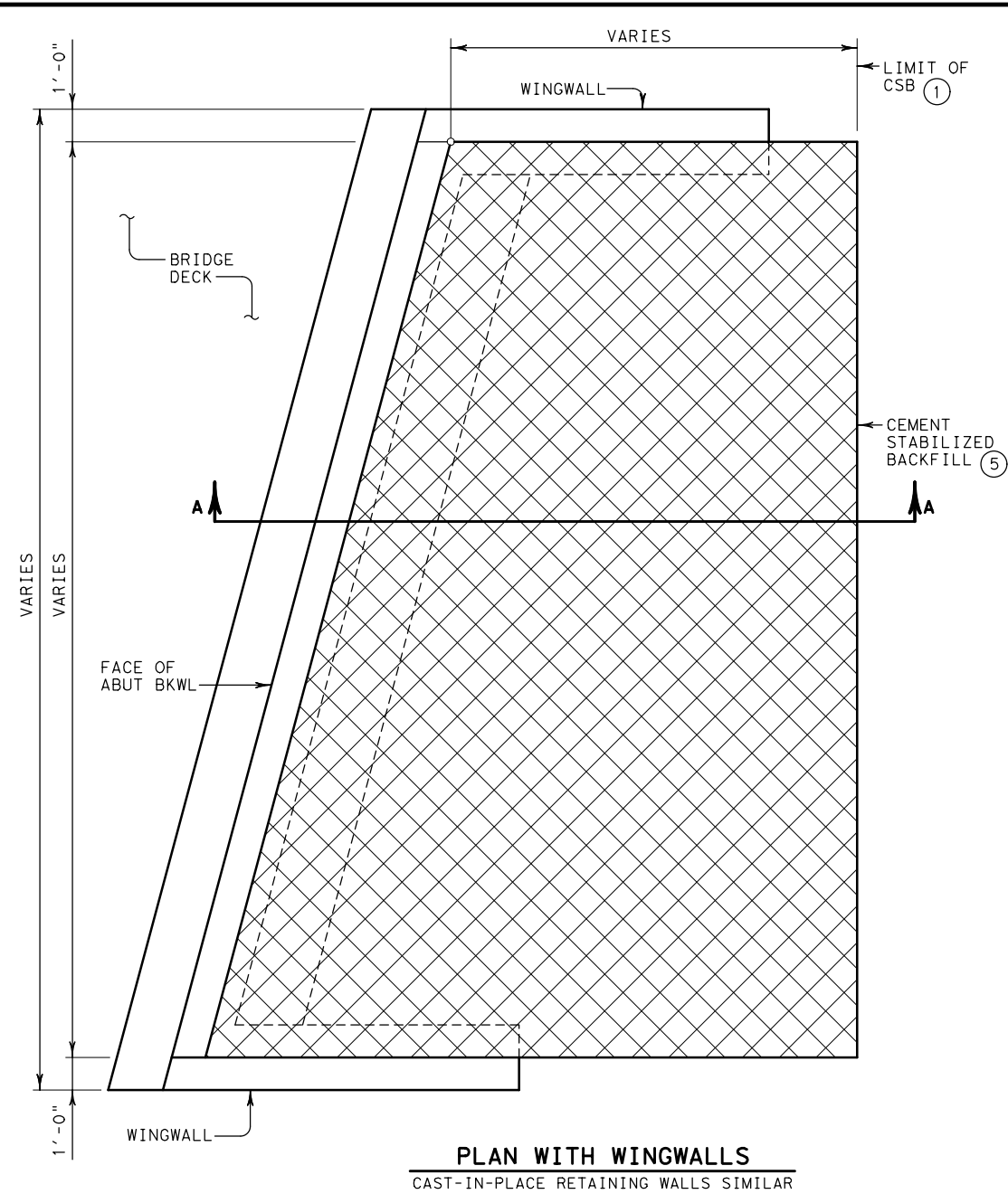

**PLAN WITH WINGWALLS**  
 CAST-IN-PLACE RETAINING WALLS SIMILAR

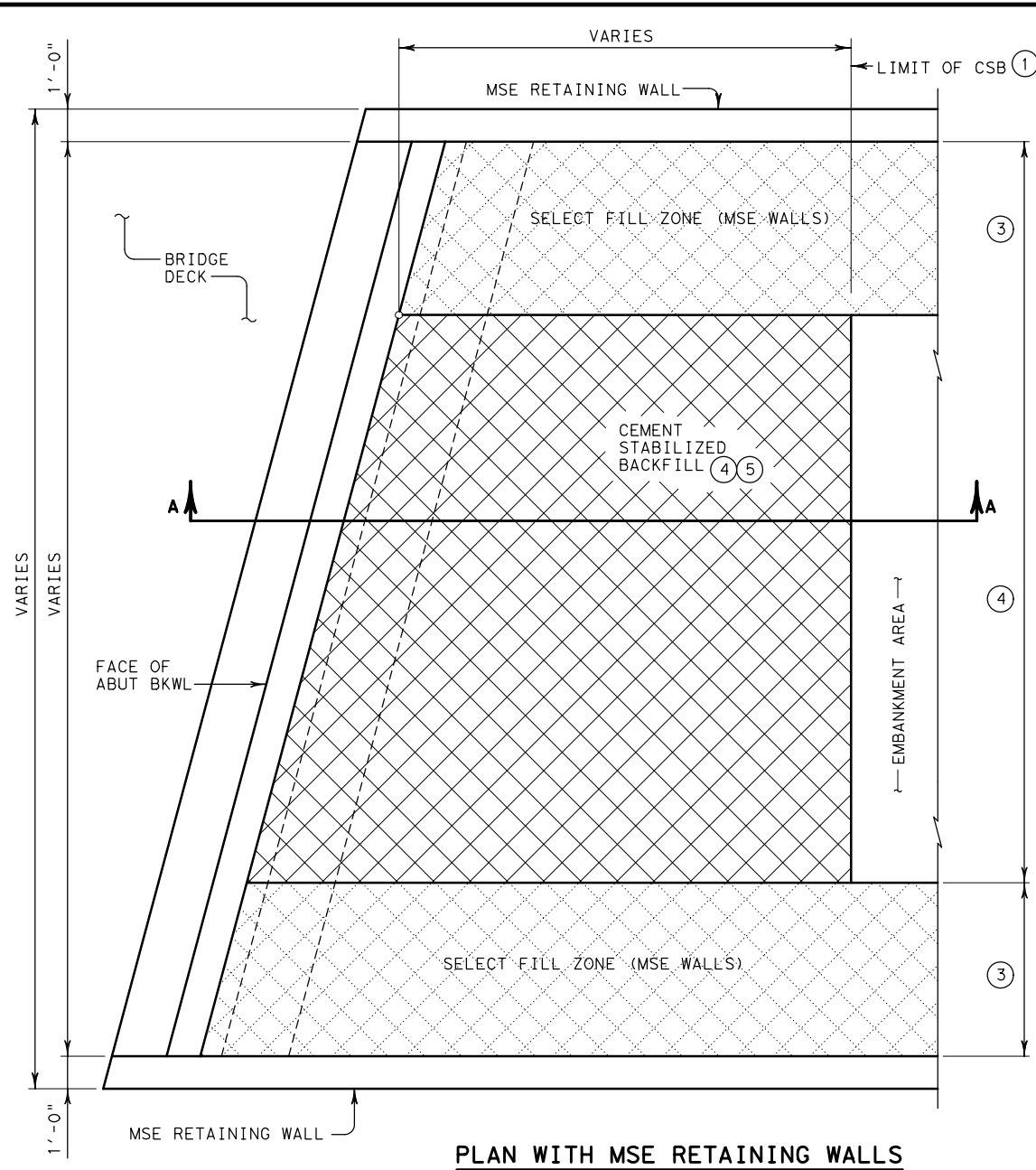

**PLAN WITH MSE RETAINING WALLS**

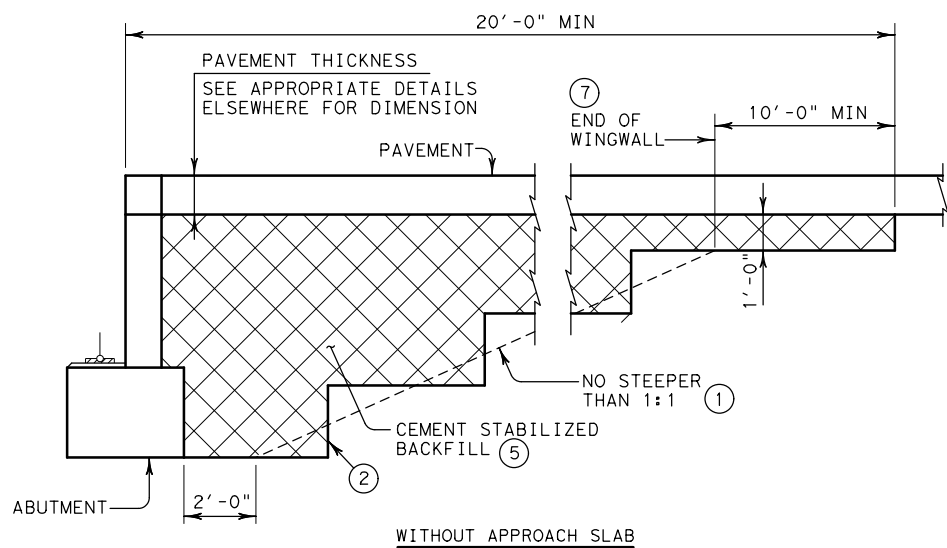

**WITHOUT APPROACH SLAB**

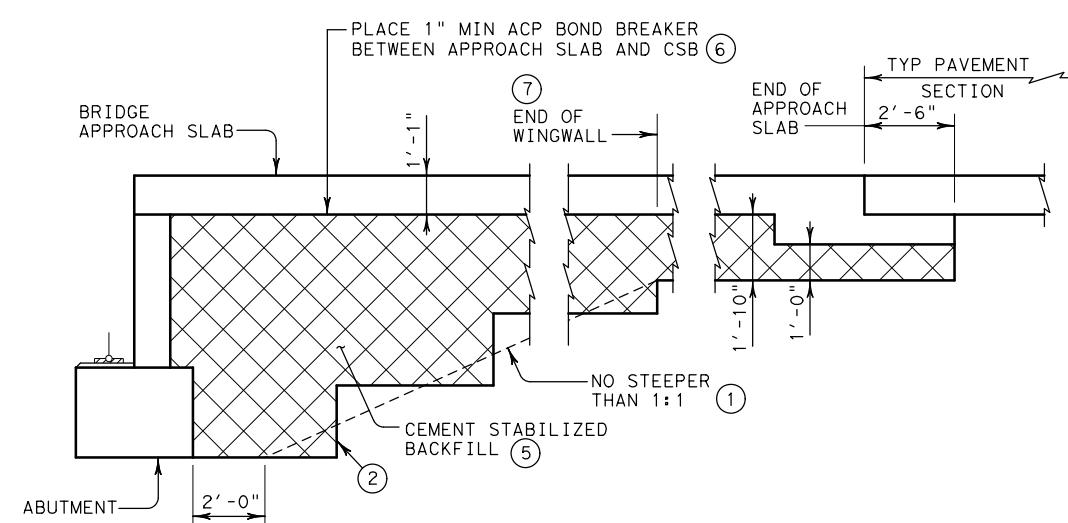

**WITH APPROACH SLAB**  
 (SHOWING BAS-C, BAS-A SIMILAR)

**SECTION A-A**

**GENERAL NOTES**

1. PROVIDE CEMENT STABILIZED BACKFILL (CSB) MEETING THE REQUIREMENTS OF ITEM 400, "EXCAVATION AND BACKFILL FOR STRUCTURES", TO THE LIMITS SHOWN AT BRIDGE ABUTMENTS. PLACE CSB IN ACCORDANCE WITH ITEM 400.
2. DETAILS ARE DRAWN SHOWING LEFT FORWARD SKEW. SEE BRIDGE LAYOUT FOR ACTUAL SKEW.
3. THESE DETAILS DO NOT APPLY WHEN CONCRETE BLOCK RETAINING WALLS ARE USED IN LIEU OF WINGWALLS. CONTACT THE BRIDGE DIVISION FOR MORE INFORMATION.
- ① USUAL LIMIT OF CEMENT STABILIZED BACKFILL IS AT 20' FROM BACK OF ABUTMENT BACKWALL, IF NO APPROACH SLAB, OR AT END OF SUPPORT SLAB IF APPROACH SLAB IS USED.
- ② BENCH BACKFILL AS SHOWN WITH 12" (APPROXIMATE) BENCH DEPTHS.
- ③ WHERE MSE RETAINING WALLS ARE PRESENT, ADJUST CSB LIMITS TO ACCOMMODATE THE SELECT FILL ZONE. SEE RETAINING WALL DETAILS FOR ADDITIONAL INFORMATION.
- ④ WHEN DISTANCE BETWEEN SELECT FILL ZONES IS LESS THAN 5'-0", MSE SELECT FILL MAY BE SUBSTITUTED FOR CEMENT STABILIZED BACKFILL WITH APPROVAL FROM THE ENGINEER.
- ⑤ IF APPROVED BY THE ENGINEER, "NON-EXCAVATABLE" FLOWABLE BACKFILL, AS DEFINED BY ITEM 401, TABLE 2, MAY BE USED AS A SUBSTITUTE FOR CEMENT STABILIZED BACKFILL, WITH THE FOLLOWING CONSTRAINTS:
  - a. IF FLOWABLE BACKFILL IS TO BE PLACED OVER MSE BACKFILL, PLACE A FILTER FABRIC OVER THE MSE BACKFILL; AND
  - b. PLACE FLOWABLE FILL IN LIFTS NOT EXCEEDING 2 FEET IN DEPTH; PLACE EACH SUCCESSIVE LIFT WHEN THE PREVIOUS LIFT HAS STIFFENED/HARDENED (HAS LOST ITS FLOWABILITY).
  - c. NO ADJUSTMENT IN PAYMENT WILL BE MADE FOR SUBSTITUTION OF FLOWABLE FILL IN LIEU OF CEMENT STABILIZED BACKFILL.
- ⑥ OTHER MATERIALS MAY BE USED AS A BOND BREAKER IF PERMITTED BY THE ENGINEER. 2 LAYERS OF 30 LB ROOFING FELT OR 2 LAYERS OF HEAVY MIL POLYETHYLENE SHEETING ARE EXAMPLES. BOND BREAKER WILL NOT BE PAID FOR DIRECTLY, BUT WILL BE SUBSIDIARY TO THE VARIOUS BID ITEMS.
- ⑦ 10'-0" FROM BACK OF ABUTMENT BACKWALL, IF NO WINGWALLS.

		<b>Fort Worth District Standard</b>	
<h2>CEMENT STABILIZED ABUTMENT BACKFILL BRIDGE ABUTMENT CSAB (FTW)</h2>			
ORIGINAL DRAWING: 05/2019	csab-ftw.dgn	PROJECT NO.	SHEET NO.
DATE	REVISIONS	STATE	STATE DIST. NO.
05/2019	NEW STANDARD	TEXAS	FTW
11/2020	REVISE NOTES; ELIMINATE SKEWED END.	COUNTY	
		CONT.	SECT. JOB HIGHWAY NO.