

LONGITUDINAL DOWEL JOINT DETAILS

LOCATE WHERE SHOWN IN THE PLANS OR AS APPROVED. CONTRACTOR MAY USE EITHER METHOD

SINGLE STEEL MAT

DOUBLE STEEL MAT

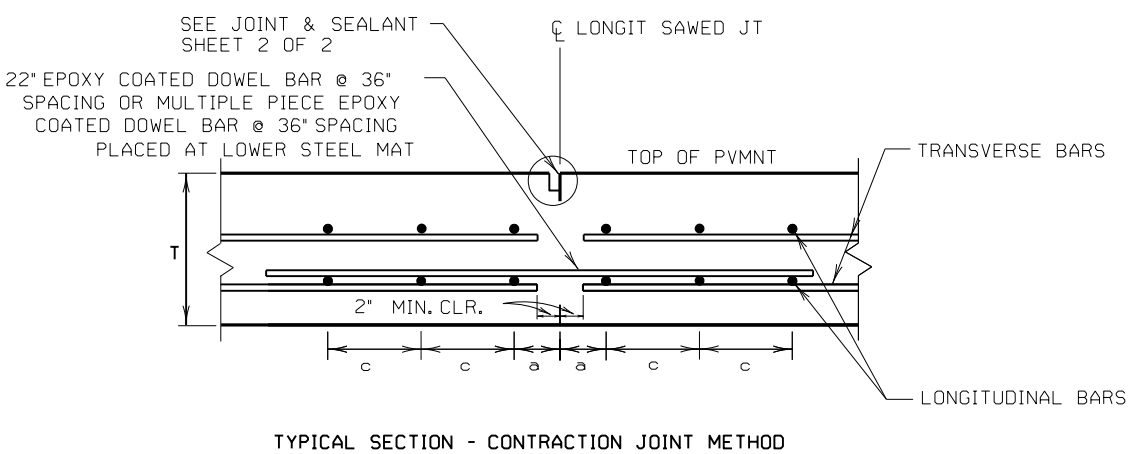
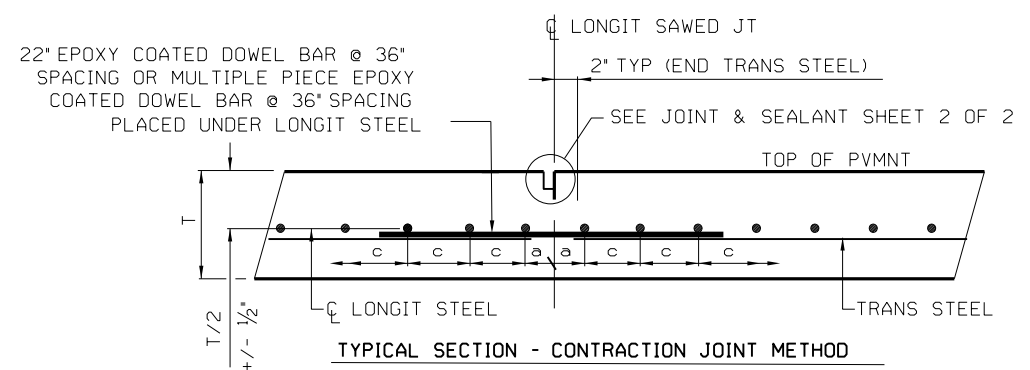
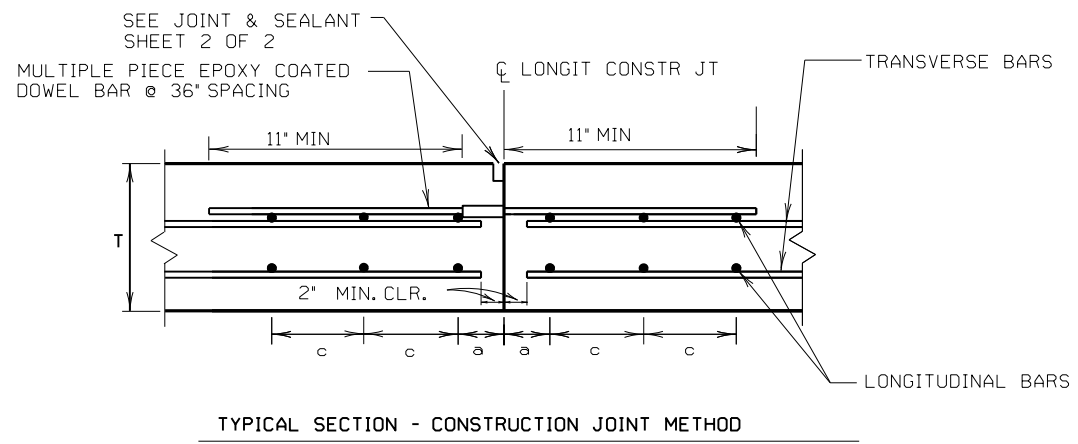
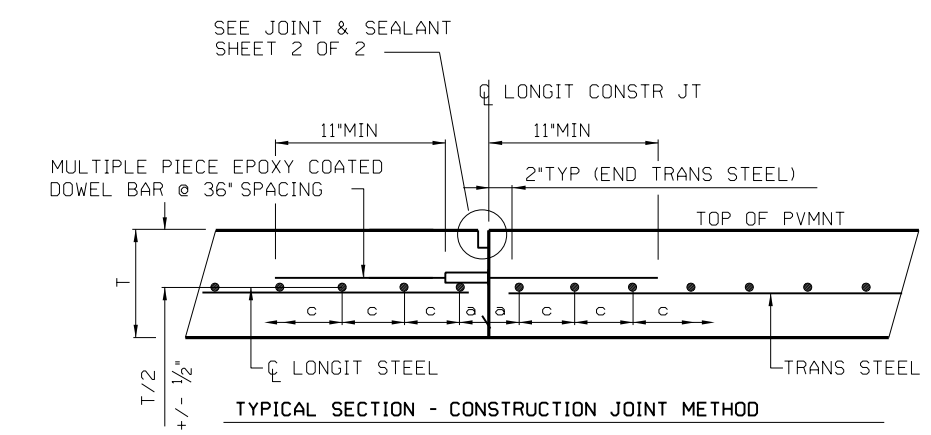

GENERAL NOTES

1. DETAILS FOR 7.0 IN. TO 13.0 IN. THICK CONCRETE PAVEMENT ARE SHOWN ON STANDARD CRCP(1)-17. DETAILS FOR 14 IN. TO 15 IN. THICK CONCRETE PAVEMENT ARE SHOWN ON STANDARD CRCP(2)-17.
2. DOWELS AND TIE BARS - DOWELS ARE ONE INCH MINIMUM DIAMETER. ENSURE DOWELS ARE FREE OF GREASE AND ARE EPOXY COATED. DO NOT SHEAR CUT DOWELS DURING FABRICATION. PROVIDE TIE BARS PER ITEM 360. FURNISH MULTI PIECE TIE BARS AND DOWELS WITH STOP COUPLINGS AND WITH THREADS ON THE BARS.
3. USE CHAIRS OF SUFFICIENT STRUCTURAL QUALITY AND NUMBER TO SUPPORT THE MAT TO THE VERTICAL TOLERANCES. CHAIRS WILL BE APPROVED BY THE ENGINEER AND DO NOT REQUIRE GALVANIZING.
4. MECHANICALLY PLACING REINFORCING STEEL IS NOT ALLOWED. NO BARS, DOWELS OR TIE BARS MAY BE VIBRATED INTO POSITION.
5. WHERE DIFFERENT THICKNESS PAVEMENTS MEET, TRANSITION THE THINNER SECTION TO THE THICKER SECTION OVER A DISTANCE OF 20 FT. PLACE REINFORCING STEEL WITHIN THE TRANSITION THE SAME AS IN THE THICKER PAVEMENT.
6. PERFORM WELDING PER ITEM 448. FURNISH WELDABLE REBAR PER ITEM 440.

Texas Department of Transportation
Houston District

**CONTINUOUSLY REINFORCED
CONCRETE PAVEMENT
HOUSTON SUPPLEMENT
CRCP-HS**

© TxDOT APR. 2012	Dist -	Ck -	Dir -	Ck -	PROJECT NO.	SHEET
REVISIONS 4/12 CHANGED CTE FROM 6.0 TO 5.0 8/14 UPDATE TO REFERENCE CRCP-13 STD. 2/15 REVISED GENERAL NOTES, MINOR CORRECTIONS. 4/17 REVISED NOTE #3 OF GENERAL NOTES, MINOR CORRECTIONS.	DISTRICT HOU		COUNTY		CONTROL SECTION	JOB HIGHWAY