

**TYPICAL ROADWAY LAYOUT
CONCRETE MEDIAN AND SHOULDERS
(AT BRIDGES)**

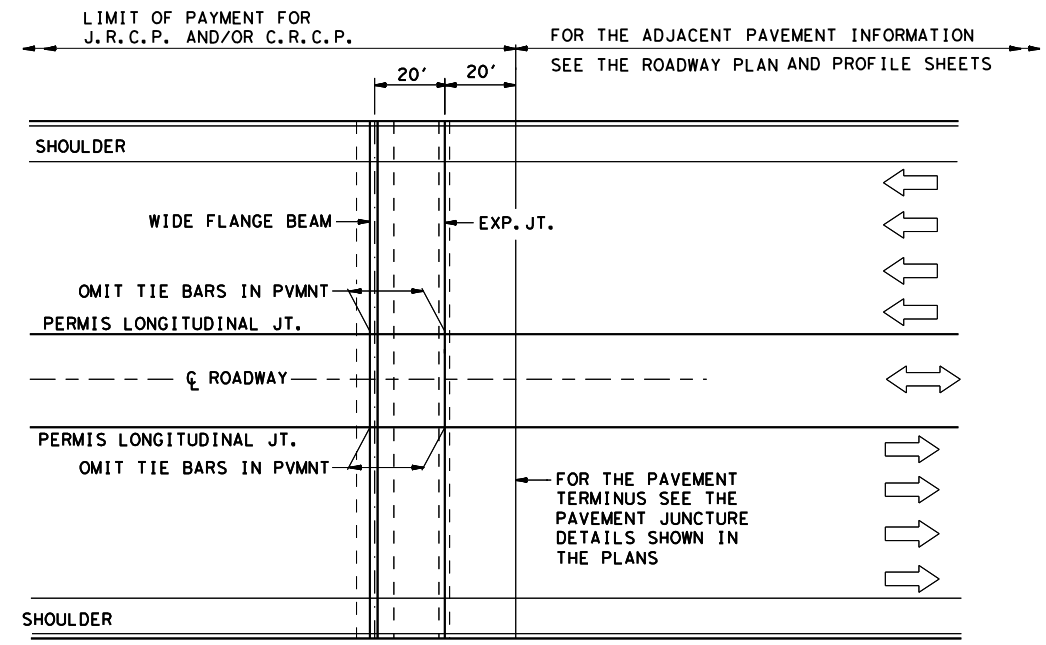

**TYPICAL ROADWAY LAYOUT
CONCRETE MEDIAN AND SHOULDERS**

- NOTES**
1. BLOCK-OUT REQUIRED AT EACH END OF WIDE FLANGE BEAM ADJACENT TO 3/8 INCH END PLATE WHERE BLOCK-OUT IS PLACED ABUTTING CONCRETE PAVEMENT, RIPRAP OR STABILIZED BASE. THE BLOCKED OUT AREA WILL BE FILLED WITH POLYETHYLENE FOAM (6 POUND DENSITY). SEE SHEET 3 OF 3 FOR BLOCK-OUT DETAIL.
 2. FOR ADDITIONAL DETAILS ON REINFORCEMENT MEMBER QUANTITIES AND THE WIDE FLANGE BEAM SEE SHEET 2 OF 3.
 3. REPLACE 6 INCH LIME TREATMENT AND 6 INCH CEMENT TREATMENT WITH CEMENT STABILIZED BACK-FILL AT STRUCTURES WITH CEMENT STABILIZED BACKFILL EMBANKMENT. SEE "CEMENT STABILIZED BACKFILL EMBANKMENT" STANDARD SHEET FOR DETAILS.
 4. 12 INCH CEMENT STABILIZED BACKFILL MAY BE SUBSTITUTED FOR 12 INCH CTB, AT CONTRACTOR'S OPTION, ON APPLICABLE STRUCTURES WITH CEMENT STABILIZED BACKFILL EMBANKMENT.
- CTB - CEMENT TREATED BASE
LTS - LIME TREATED SUBGRADE
CRCP - CONTINUOUSLY REINFORCED CONCRETE PAVEMENT
JRCP - JOINTED REINFORCED CONCRETE PAVEMENT
ASB - ASPHALT STABILIZED BASE
T - PAVEMENT THICKNESS

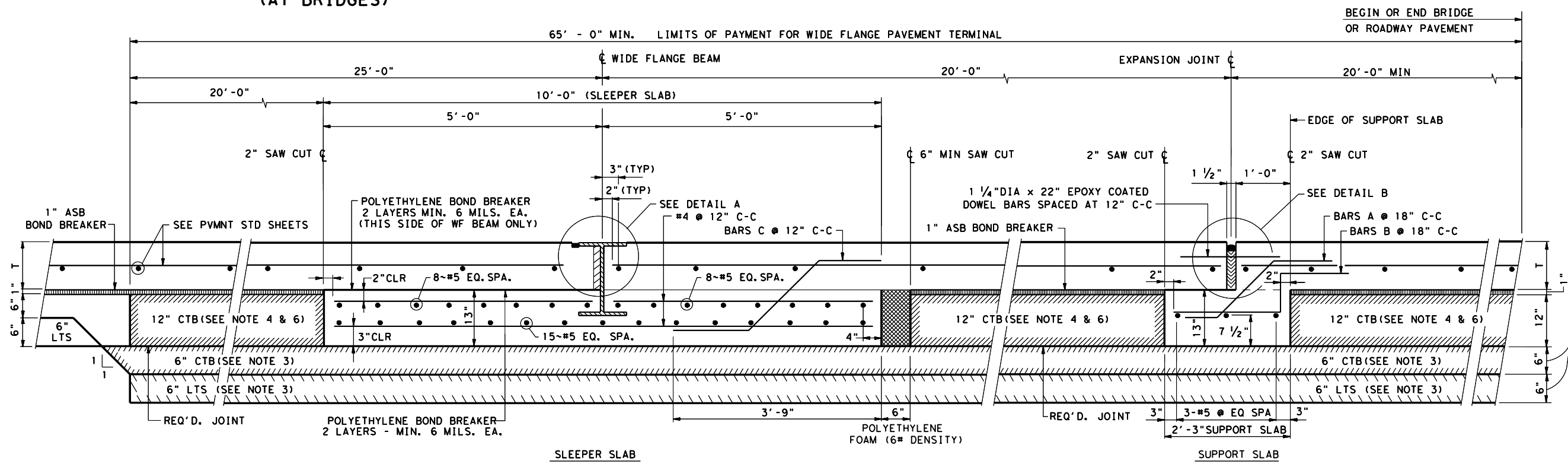

TYPICAL SECTION THRU TERMINAL ANCHORAGE @ SLEEPER SLAB & SUPPORT SLAB

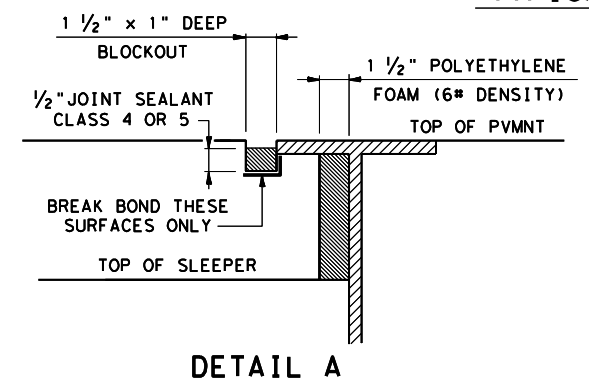

DETAIL A

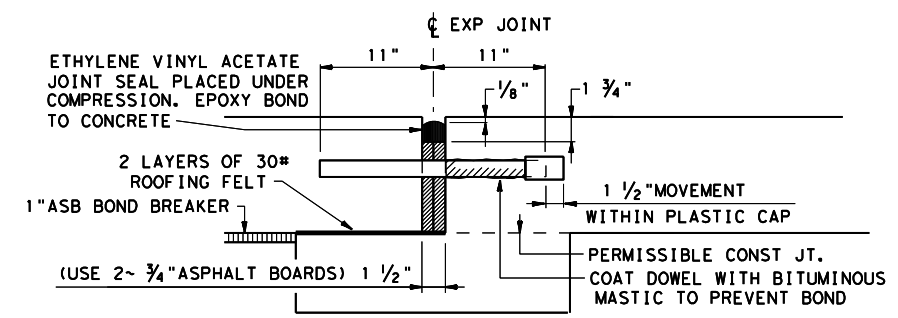

DETAIL B

FOR MORE DETAILS AND LIMITS OF PAY FOR CTB & LTS SEE ABUTMENT BACKFILL DIAGRAM DETAIL ON SHEET 2 OF 3 OR THE PAVEMENT JUNCTURE DETAILS AS SHOWN IN PLANS.

Texas Department of Transportation
Houston District

WIDE FLANGE PAVEMENT TERMINALS

FOR CONTINUOUSLY & JOINTED REINFORCED CONCRETE PAVEMENT DETAILS (FOR USE AT BRIDGE END OR PAVEMENT TERMINUS)

WFPT

FILE#	STDB-3.DGN	DN: TxDOT	CK: TxDOT	DW: TxDOT	CK: TxDOT
© TxDOT	2014	DISTRICT	FED REG	PROJECT NO.	SHEET
REVISIONS		HOU	6		
02/15 2014 SPECS		COUNTY	CONTROL	SECT	JOB
					HIGHWAY