

DISCLAIMER: The use of this standard is governed by the "Texas Engineering Practice Act". No warranty of any kind is made by TxDOT for any purpose whatsoever. TxDOT assumes no responsibility for the conversion of this standard to other formats or for incorrect results or damages resulting from its use.

DATE:
FILE:

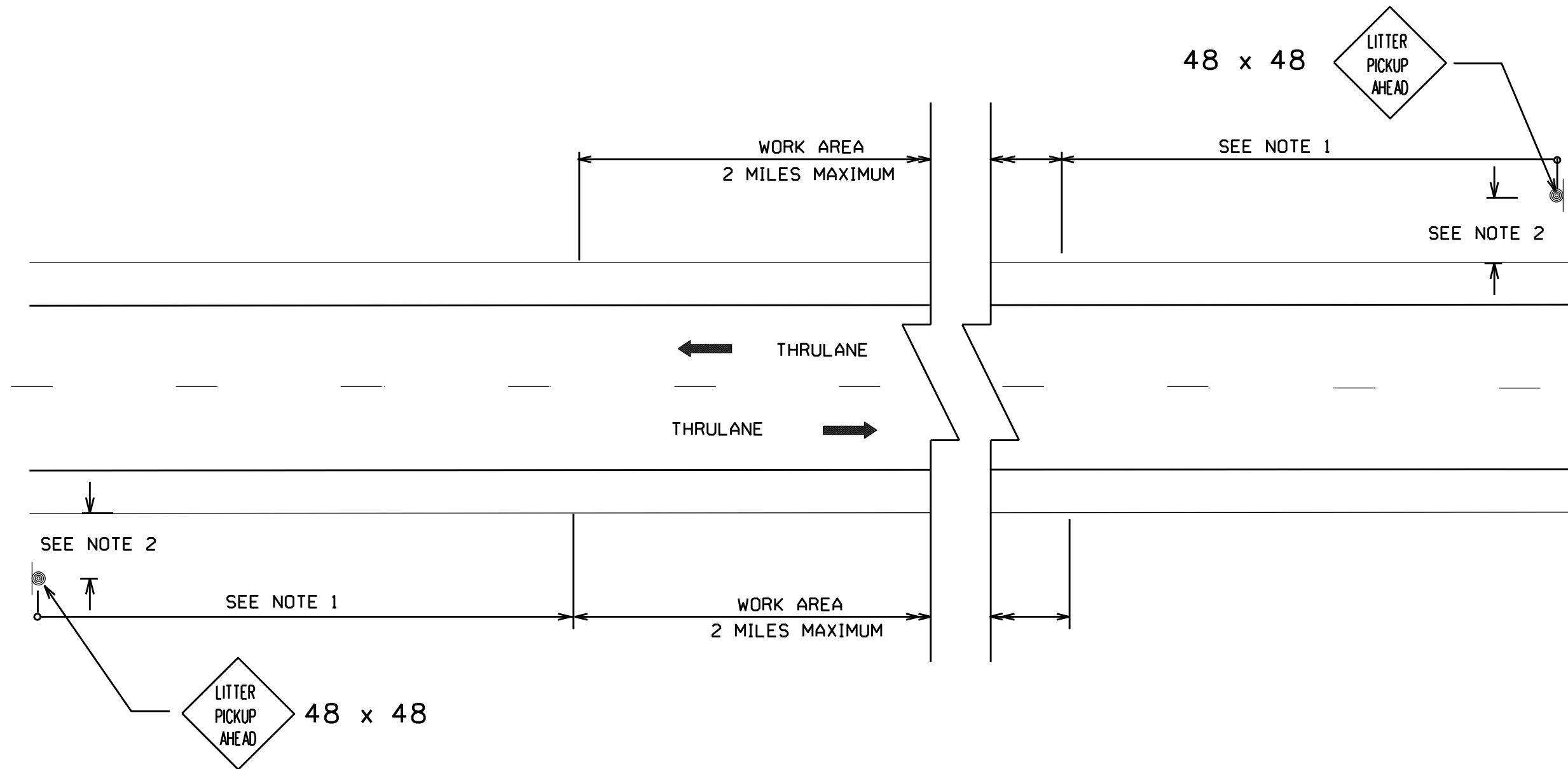

NOTES:

- 1) SEE BC(2),PROJECT LIMIT "TYPICAL CONSTRUCTION WARNING SIGN SIZE AND SPACING", FOR SIGN SPACING.
- 2) SEE BC(4),TEMPORARY SIGN NOTES, FOR MINIMUM CLEARANCES.

N.T.S.



**TRAFFIC CONTROL PLAN
SIGNING ARRANGEMENT
LITTER PICKUP
(TWO-LANE HIGHWAY)
TC(LP)-25 (HOU)**

FILE: TC(LP)-25 (HOU).dgn	DN: TXDOT	CK: TXDOT	DW: TXDOT	CK: TXDOT
© TXDOT February 2025	CONT	SECT	JOB	HIGHWAY
REVISIONS				
02-25-2024 Spec Updates	DIST	COUNTY	SHEET NO.	

DISCLAIMER: The use of this standard is governed by the "Texas Engineering Practice Act". No warranty of any kind is made by TxDOT for any purpose whatsoever. TxDOT assumes no responsibility for the conversion of this standard to other formats or for incorrect results or damages resulting from its use.

DATE:
FILE:

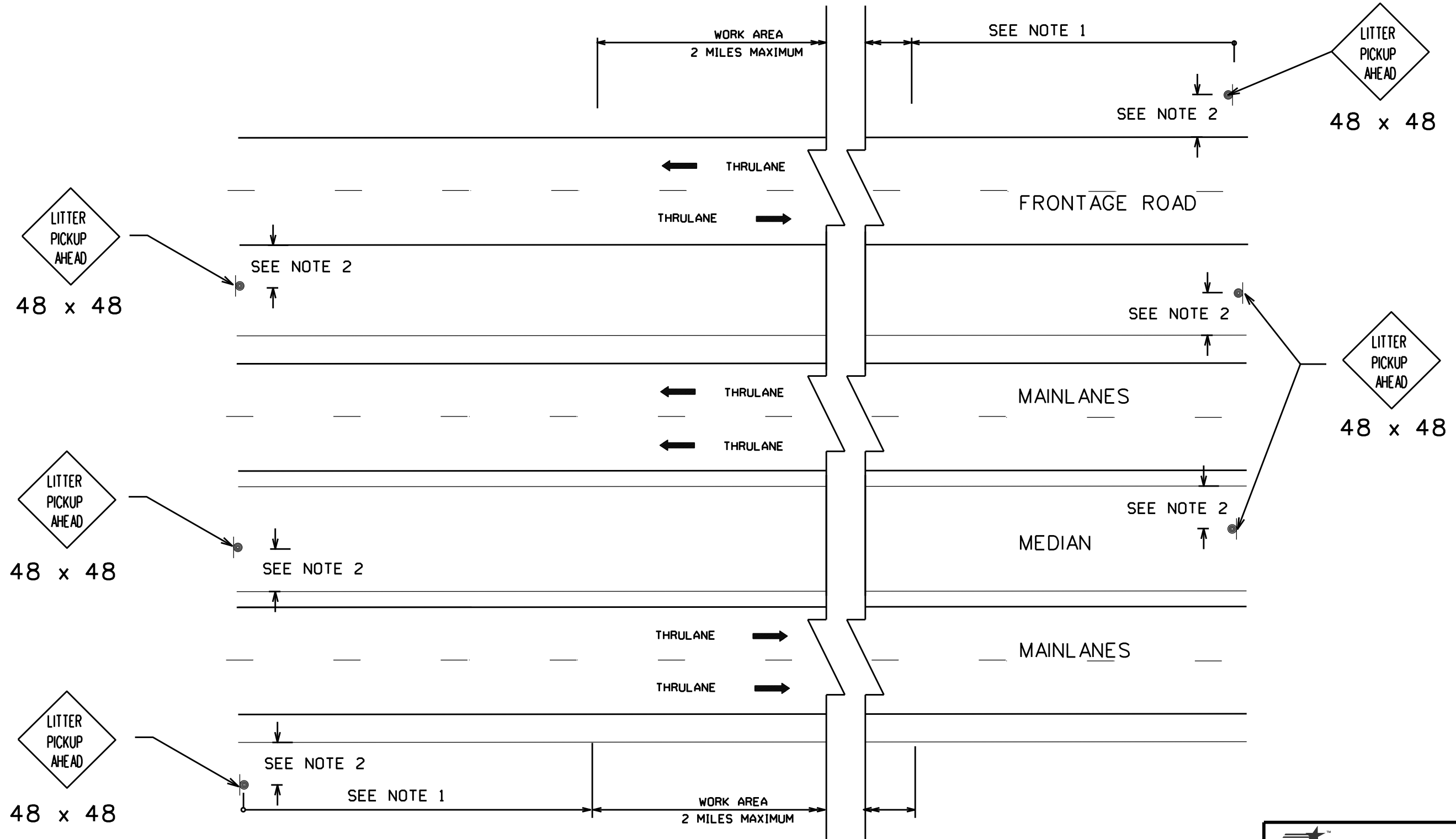

NOTES:

1) SEE BC(2),PROJECT LIMIT *TYPICAL CONSTRUCTION WARNING SIGN SIZE AND SPACING*, FOR SIGN SPACING.

2) SEE BC(4),TEMPORARY SIGN NOTES, FOR MINIMUM CLEARANCES.

N.T.S.



Houston District Standard

**TRAFFIC CONTROL PLAN
SIGNING ARRANGEMENT
LITTER PICKUP**

TC(LP)-25 (HOU)

FILE: TC(LP)-25 (HOU).dgn	DN: TXDOT	CK: TXDOT	DW: TXDOT	CK: TXDOT
© TXDOT February 2025	CONT	SECT	JOB	HIGHWAY
REVISIONS				
02-25-2024 Spec Updates	DIST	COUNTY	SHEET NO.	