

Texas Department of Transportation
BOOK 2 – TECHNICAL PROVISIONS
FOR
LOOP 375 - BORDER HIGHWAY WEST EXTENSION
PROJECT
Design-Build Project
ATTACHMENT 21-2
JOINTED CONCRETE PAVEMENT DESIGN USING GLASS-
REINFORCED POLYMER BARS STANDARD

August 22, 2014

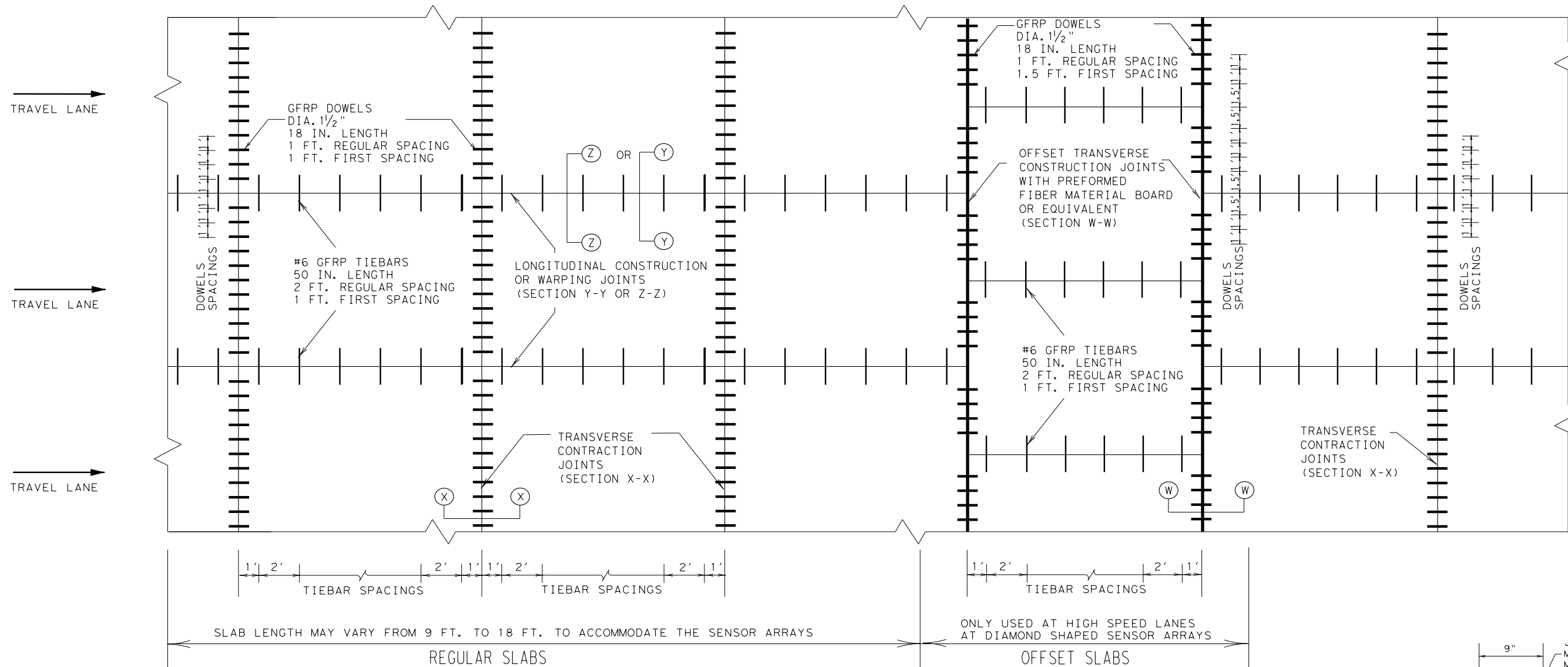

JOINTED PAVEMENT DETAIL LAYOUT
(NOT TO SCALE)

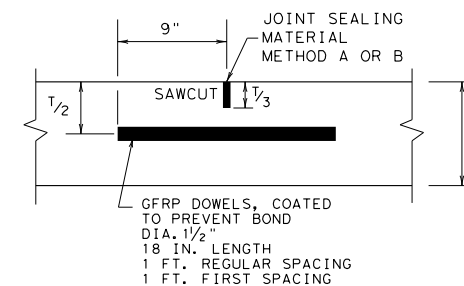

TRANSVERSE CONTRACTION JOINT SECTION X-X

GENERAL NOTES

1. THE TERMINAL ANCHOR SLAB DETAILS ARE AS SHOWN ELSEWHERE IN THE PLANS.
2. DETAILS AS TO PAVEMENT SLAB WIDTH, THICKNESS, AND CROWN CROSS-SLOPE SHALL BE AS SHOWN ELSEWHERE ON THE PLANS.
3. THE DETAIL FOR THE JOINT SEALANT AND RESERVOIR SHALL BE SHOWN IN CONCRETE PAVEMENT DETAIL, JOINT SEALS STANDARD (JS-94).
4. FOR FURTHER INFORMATION REGARDING THE PLACEMENT OF CONCRETE AND REINFORCEMENT, REFER TO THE GOVERNING SPECIFICATIONS FOR "CONCRETE PAVEMENT", AND "GFRP REINFORCEMENT."
5. PAVEMENT WIDTH OF MORE THAN 16' SHALL HAVE A LONGITUDINAL JOINT (SECTION Z-Z OR Y-Y). THESE JOINTS SHALL BE LOCATED WITHIN 6" OF THE LANE LINE UNLESS THE JOINT LOCATION IS SHOWN ELSEWHERE ON THE PLANS.
6. SAW CUT DEPTH FOR LONGITUDINAL AND TRANSVERSE CONTRACTION JOINTS MAY BE ONE FOURTH THE SLAB THICKNESS WHEN CRUSHED LIMESTONE IS USED AS THE COARSE AGGREGAE.
7. CONCRETE SLABS WIDER THAN 100' WITHOUT A FREE JOINT, ARE NOT COVERED BY THIS STANDARD.

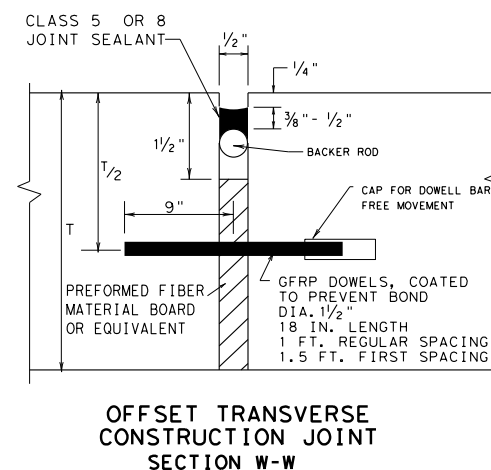
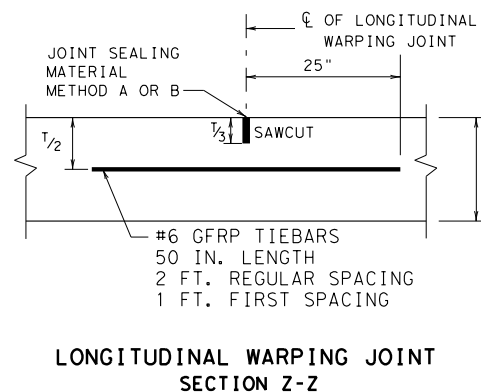
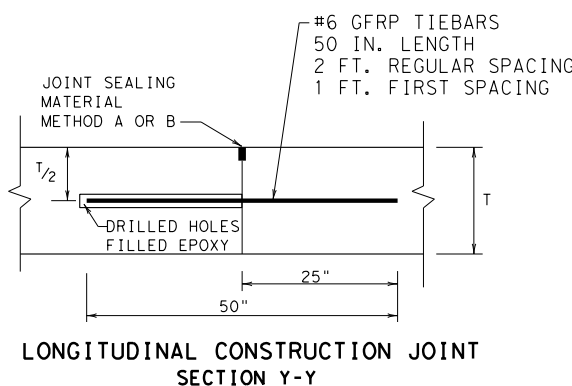

Texas Department of Transportation
Design Division (Pavement)

JOINTED CONCRETE PAVEMENT
USING GLASS FIBER REINFORCED POLYMER BARS
T-11 INCHES

JCPGFRPB-04 (TTA STANDARD)

© TXDOT JULY 2004	DR: MCW	CR: MCW	DR: HC	CR: HC	NEG NO.:
STATE DISTRICT	FEDERAL REGION		FEDERAL AID PROJECT		SHEET
AUS	6			212A	
COUNTY	CONTROL	SECTION	JOB	HIGHWAY	SH. 45 LOOP 1
WILLIAMSON	0683	06	027		

LEVELS DISPLAYED
1 3 4 15 16 17 18 19 10 11 21 31 41 51 6
17 18 19 20 21 22 24 25 26 27 28 29 30 31 32
33 34 35 36 37 38 39 40 41 42 43 44 45 46 47 48
FILE: <JCPGFRPB-04.DGN>