

INDEX ON SHEET 2

STATE OF TEXAS
DEPARTMENT OF TRANSPORTATION

PLANS OF PROPOSED
STATE HIGHWAY IMPROVEMENT
FM 133

CSJ 0237-01-018
ROADWAY = 6.712 MI
BRIDGE = 0.943 MI
TOTAL LENGTH = 6.755 MI

LA SALLE COUNTY

LIMITS: 250' WEST OF THE CENTER OF THE UNION PACIFIC RAILROAD
LINE ON FM 133 TO DIMMIT COUNTY LINE
FOR THE CONSTRUCTION OF THE RESTORATION OF AN EXISTING ROAD CONSISTING OF WIDENING,
ACP OVERLAY, STRUCTURES, PAVEMENT MARKINGS.

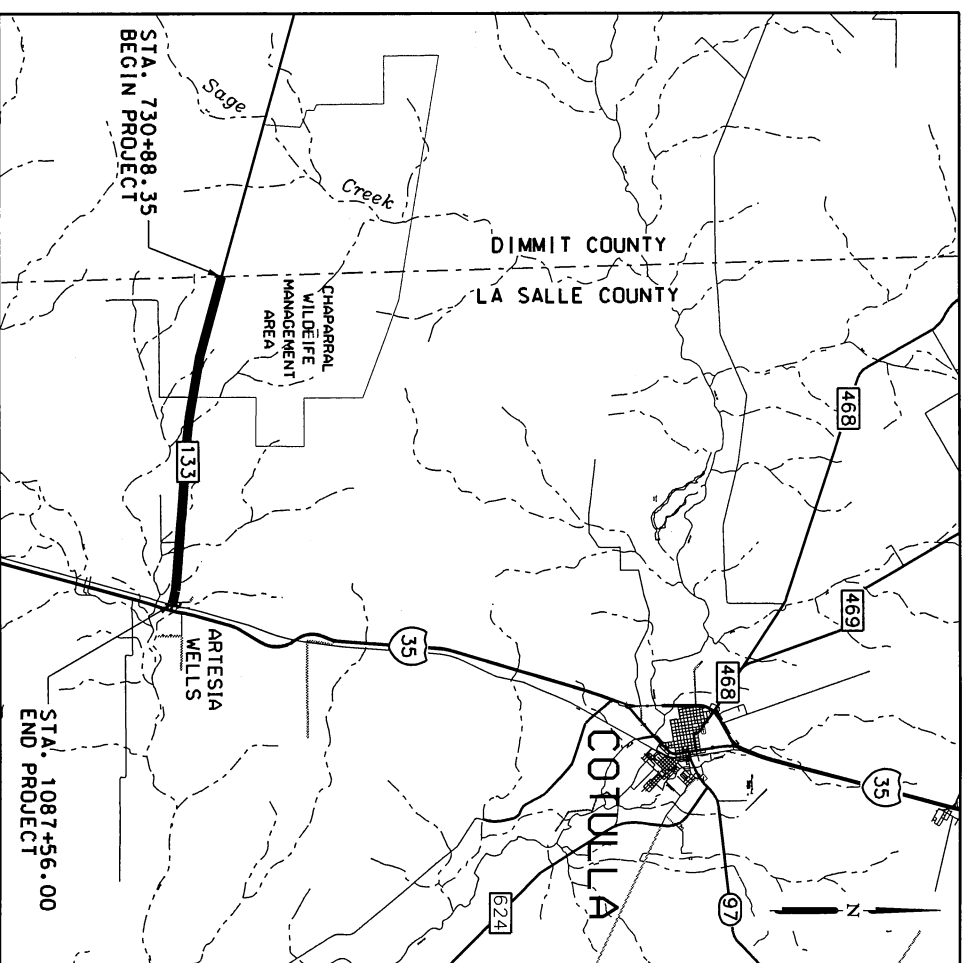

LOCATION MAP

N. T. S.
EXCEPTIONS: NONE
EQUATIONS: NONE
RAILROAD CROSSINGS: NONE

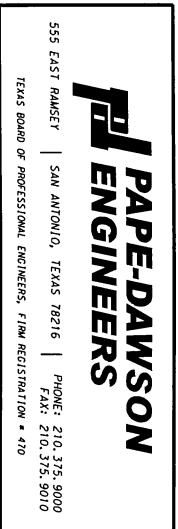

555 EAST BAKER | SAN ANTONIO, TEXAS 78216 | PHONE: 210.375.9000
TEXAS BOARD OF PROFESSIONAL ENGINEERS, FIRM REGISTRATION # 410 | FAX: 210.375.9010

SPECIFICATIONS ADOPTED BY THE TEXAS DEPARTMENT OF TRANSPORTATION,
JUNE 1, 2004 AND SPECIFICATION ITEMS LISTED AND DATED AS FOLLOWS:
SHALL GOVERN ON THIS PROJECT: SPECIAL LABOR PROVISIONS FOR STATE
PROJECTS (000--0071).

FED. AID PROJECT NO.	STATE	COUNTY	SHEET
0237	TEXAS	LA SALLE	1
01	LAREDO	LA SALLE	
018	008	FIRM NO.	
		FM 133	

DESIGN STANDARD: 3R
FUNCTIONAL CLASSIFICATION:
RURAL MAJOR COLLECTOR
DESIGN SPEED = 40 MPH
ADT = 3000 (2014)

TDLR INSPECTION
NOT REQUIRED

SUBMITTED FOR LETTING: _____ 20__

CONSTRUCTION PROJECT MANAGER _____

TEXAS DEPARTMENT OF TRANSPORTATION

RECOMMENDED FOR LETTING: _____ 20__

AREA ENGINEER _____

RECOMMENDED FOR LETTING: _____ 20__

DIRECTOR, TRANSPORTATION PLANNING AND DEVELOPMENT _____

RECOMMENDED FOR LETTING: _____ 20__

DIRECTOR, TRAFFIC OPERATIONS DIVISION _____

DIRECTOR, DESIGN DIVISION _____

DISTRICT ADMINISTRATOR _____

APPROVED FOR LETTING: _____

DIRECTOR, DESIGN DIVISION _____

SHEET NO. DESCRIPTION

GENERAL

1	TITLE SHEET
2	INDEX OF SHEETS
3-4	PROJECT LAYOUT
5-7	TYPICAL SECTIONS
8-10	SURVEY CONTROL SHEETS
11-12	GENERAL NOTES
13	TCP SUMMARY
14	ROADWAY SUMMARY
15	DRAINAGE SUMMARY
16	PAVEMENT MARKING SUMMARY
17	SWP SUMMARY
18	SIGNING SUMMARY SHEET
19	SUMMARY OF SMALL SIGNS
	TCP
20	TCP-GENERAL NOTES
21	TCP-SEQUENCE OF WORK
22	TCP-SECTIONS PHASE I
23	TCP-SECTIONS PHASE II
24-35	* BC(1-07) THRU BC(12-07) BARRICADE AND CONSTRUCTION STANDARDS
36	* TCP(2-1) -12 TRAFFIC CONTROL PLAN
37	* TCP(2-2) -12 TRAFFIC CONTROL PLAN
38	* TCP(3-1) -98 TRAFFIC CONTROL PLAN
39	* TCP(3-3) -98 TRAFFIC CONTROL PLAN
40	* WZ(STPM) -03 WORK ZONE PAVEMENT MARKINGS
	ROADWAY
41	EXISTING HORIZONTAL ALIGNMENT DATA
42	EXISTING VERTICAL ALIGNMENT DATA
43	METAL BEAM GUARD FENCE DETAILS
44	PAVEMENT REPLACEMENT PLAN AND PROFILE
45	DRIVEWAY DETAILS
46	T202 TRANSITION RETROFIT GUIDE
47	* BED-11 BRIDGE END DETAILS
48	* GF(31) -11 METAL BEAM GUARD FENCE
49	* GF(31) TR-11 METAL BEAM GUARD FENCE TRANSITION (THREE-BEAM TRANSITION)
50	* SGT(7) 31-11 SINGLE GUARDRAIL TERMINAL (ET-31)
51	* SGT(8) (31-11) SINGLE GUARDRAIL TERMINAL (SKT-31)
52	* GF(31) MS-11 METAL BEAM GUARD FENCE (MOW STRIP)
53	* CCCR-12 CONCRETE CURB AND GUTTER
54	* CRR CONCRETE RIPRAP AND SHOULDER DRAINS
	DRAINAGE
55	TABLE OF SMALL STRUCTURES
56-58	* SETP-CD-A SAFETY END TREATMENT
59-60	* SETP-CD SAFETY END TREATMENT
61	* SETP-PD SAFETY END TREATMENT
	TRAFFIC
62	PAVEMENT MARKING DETAILS NO-PASS ZONES
63	SMALL SIGN DETAILS
64	* D&OM(1) -10 DELINEATOR & OBJECT MARKER INSTALLATION AND MATERIAL DESCRIPTION
65	* D&OM(2) -04 TYPICAL DELINEATOR & OBJECT MARKER PLACEMENT DETAILS
66	* D&OM(3) -04 DELINEATOR & OBJECT MARKER PLACEMENT DETAILS
67	* D&OM(5) -04 DELINEATOR & OBJECT MARKER PLACEMENT DETAILS
68	* PM (1) -12 PAVEMENT MARKERS
69	* PM (2) -12 PAVEMENT MARKERS
70	* RCPM-09 RAILROAD CROSSING PAVEMENT MARKING TYPICAL DETAILS
71	* TSR(1) -08 TYPICAL SIGN REQUIREMENTS
72	* TSR(3) -08 TYPICAL SIGN REQUIREMENTS
73	* TSR(4) -08 TYPICAL SIGN REQUIREMENTS
74	* TSR(5) -08 TYPICAL SIGN REQUIREMENTS
75	* SMD(GEN) -08 SIGN MOUNTING DETAILS
76	* SMD(SLIP-1) -08 SIGN MOUNTING DETAILS
77	* SMD(SLIP-2) -08 SIGN MOUNTING DETAILS
78	* SMD(SLIP-3) -08 SIGN MOUNTING DETAILS
79	* SMD(2-1) -08 SIGN MOUNTING DETAILS
	SW3B
80	STORM WATER POLLUTION PREVENTION PLAN DETAILS
81	STORM WATER POLLUTION PREVENTION PLAN NARRATIVE
82	ENVIRONMENTAL PERMITS, ISSUES AND COMMITMENTS
83	* EC(1) -09 TEMP EROSION, SEDIMENT AND WATER POLLUTION CONTROL MEASURES
84	* EC(2) -93 TEMP EROSION, SEDIMENT AND WATER POLLUTION CONTROL MEASURES
85	* EC(3) -93 TEMP EROSION, SEDIMENT AND WATER POLLUTION CONTROL MEASURES
86-87	* REVEGETATION NOTES AND SPECIFICATIONS
	CROSS SECTIONS
88-122	CROSS SECTIONS

* THE STANDARD SHEETS SPECIFICALLY IDENTIFIED HAVE BEEN SELECTED BY ME OR UNDER MY RESPONSIBLE SUPERVISION AS BEING APPLICABLE TO THIS PROJECT.

JAMES A. LUTZ
 84722
 5/31/2013
 DATE

Pape-Dawson
ENGINEERS

555 EAST PASSEY | SAN ANTONIO, TEXAS 78216 | PHONE: 210.375.9000
 TEXAS BOARD OF PROFESSIONAL ENGINEERS, FIRM REGISTRATION # 410 | FAX: 210.375.9010

FM 133
 INDEX
 OF SHEETS

DATE	REV.	BY	CHKD.	APP.	DESCRIPTION			
01/18/13	01	LAREDO	LA SALLE	0237	01	018	018	2

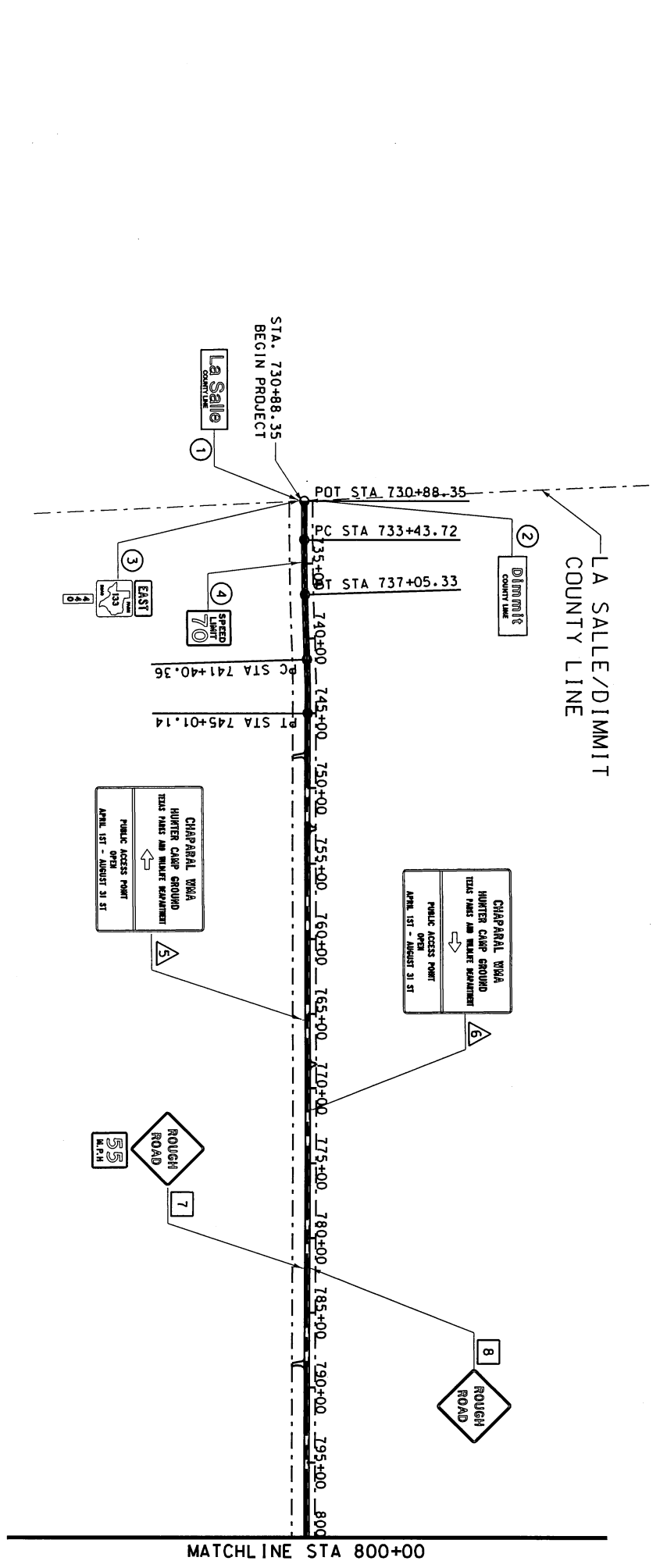

- LEGEND**
- (X) SMALL ROAD SIGN DESIGNATION TO BE REPLACED
 - (X) SMALL ROAD SIGN DESIGNATION TO BE REMOVED
 - (X) SMALL ROAD SIGN DESIGNATION TO BE RELOCATED
 - (X) SMALL ROAD SIGN DESIGNATION NEW SIGN

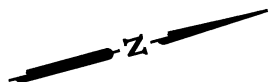
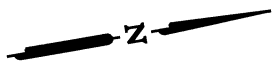
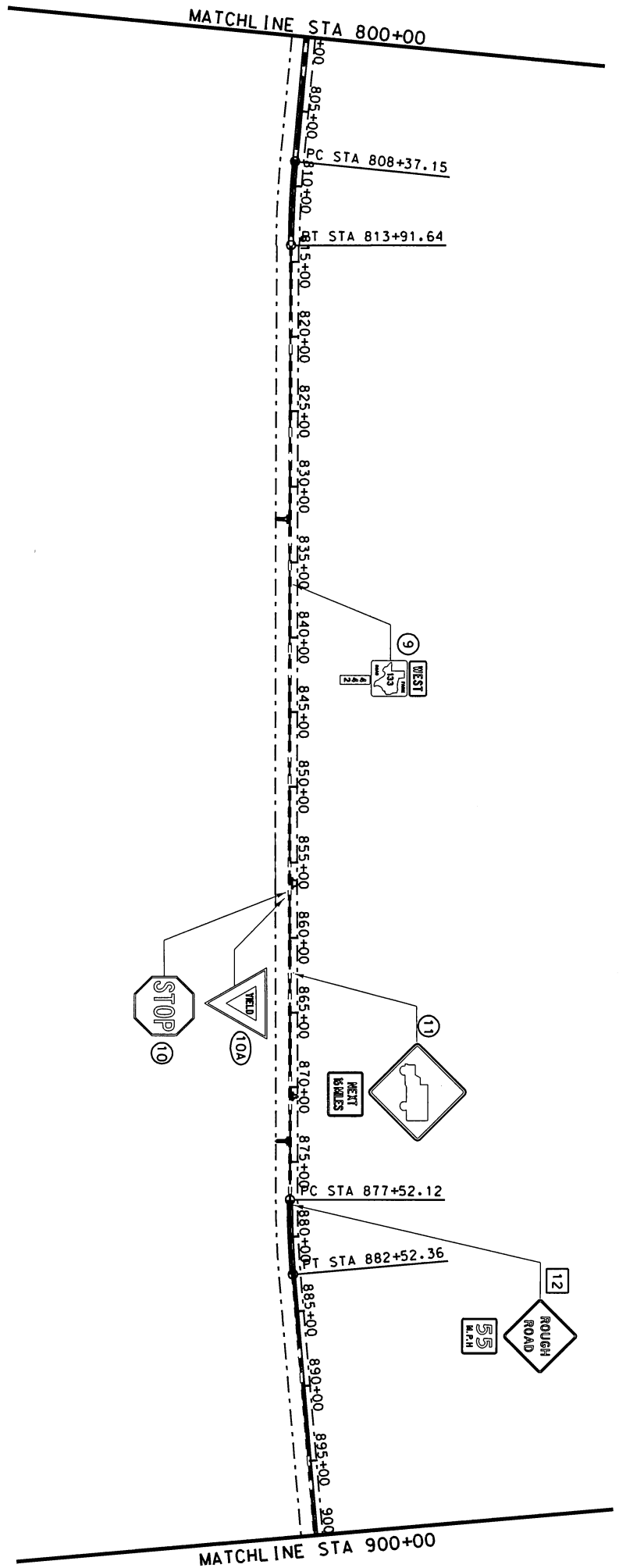

DESIGN
 LUKE REED
 PROFESSIONAL ENGINEER
 LICENSE NO. 101242
 DATE: 5/31/2013

REVIEW AND APPROVAL
 JAMES A. LUTZ
 PROFESSIONAL ENGINEER
 LICENSE NO. 841722
 DATE: 5/31/2013

SCALE: PLAN 1"=1000'

Pape-Dawson
ENGINEERS

555 EAST FRASER | SAN ANTONIO, TEXAS 78216 | PHONE: 210.375.9000
 TEXAS BOARD OF PROFESSIONAL ENGINEERS, FIRM REGISTRATION # 410 | FAX: 210.375.9010

Texas Department of Transportation
 © 2013

FM 133
 PROJECT
 LAYOUT

BEGIN TO STA 900+00

DATE	FIG. NO.	STATE	FEDERAL AID PROJECT NO.	HIGHWAY NO.
05/31/13	6	TEXAS		FM 133
DATE	DIST.	COUNTY	CONTR. NO.	JOB NO.
05/31/13	LAREDO	LA SALLE	0237	018
DATE	NO.			SHEET NO.
05/31/13	01			3

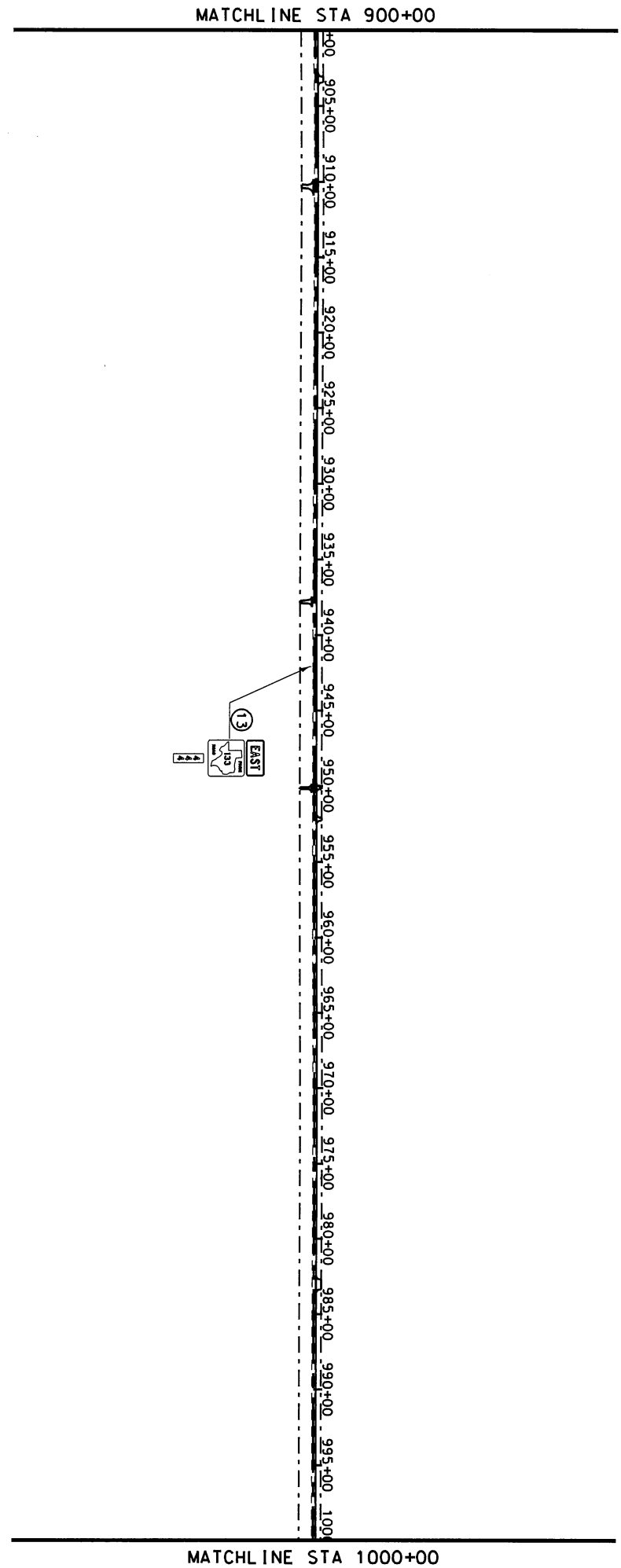
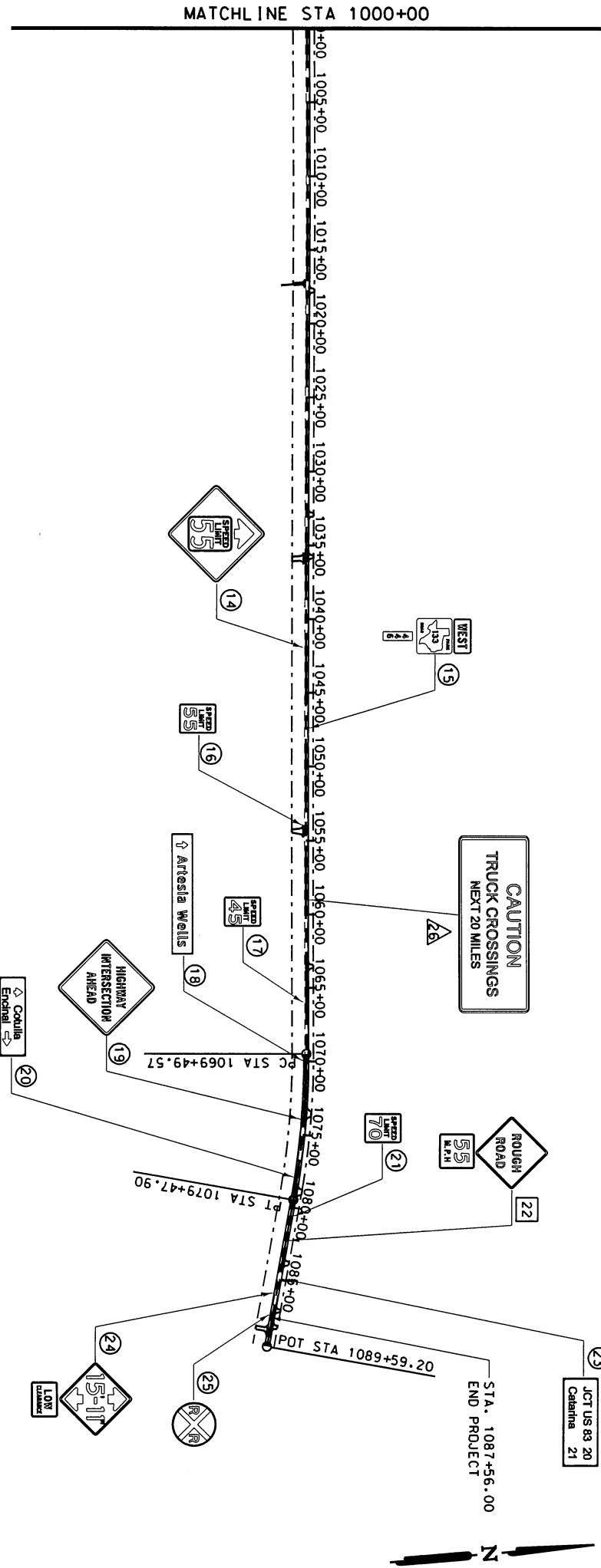

- LEGEND**
- (X) SMALL ROAD SIGN DESIGNATION TO BE REPLACED
 - (X) SMALL ROAD SIGN DESIGNATION TO BE REMOVED
 - (X) SMALL ROAD SIGN DESIGNATION TO BE RELOCATED
 - (X) SMALL ROAD SIGN DESIGNATION NEW SIGN

DESIGN
 LUKE REED
 101242
 PROFESSIONAL ENGINEER
 STATE OF TEXAS
 5/31/2013
 DATE

REVIEW AND APPROVAL
 JAMES A. LUTZ
 841727
 PROFESSIONAL ENGINEER
 STATE OF TEXAS
 5/31/2013
 DATE

SCALE: PLAN 1"=1000'

Pape-Dawson
ENGINEERS

555 EAST RAMSEY | SAN ANTONIO, TEXAS 78216 | PHONE: 210.375.9000
 TEXAS BOARD OF PROFESSIONAL ENGINEERS, FIRM REGISTRATION # 410 | FAX: 210.375.9010
 © 2013 Texas Department of Transportation

FM 133
 PROJECT
 LAYOUT

STA 900+00 TO END

DATE	REV.	BY	CHKD.	DESCRIPTION
01/18/13	1	LAREDO	L.A.SALLE	0237
01/18/13	2			01
01/18/13	3			01B
01/18/13	4			4

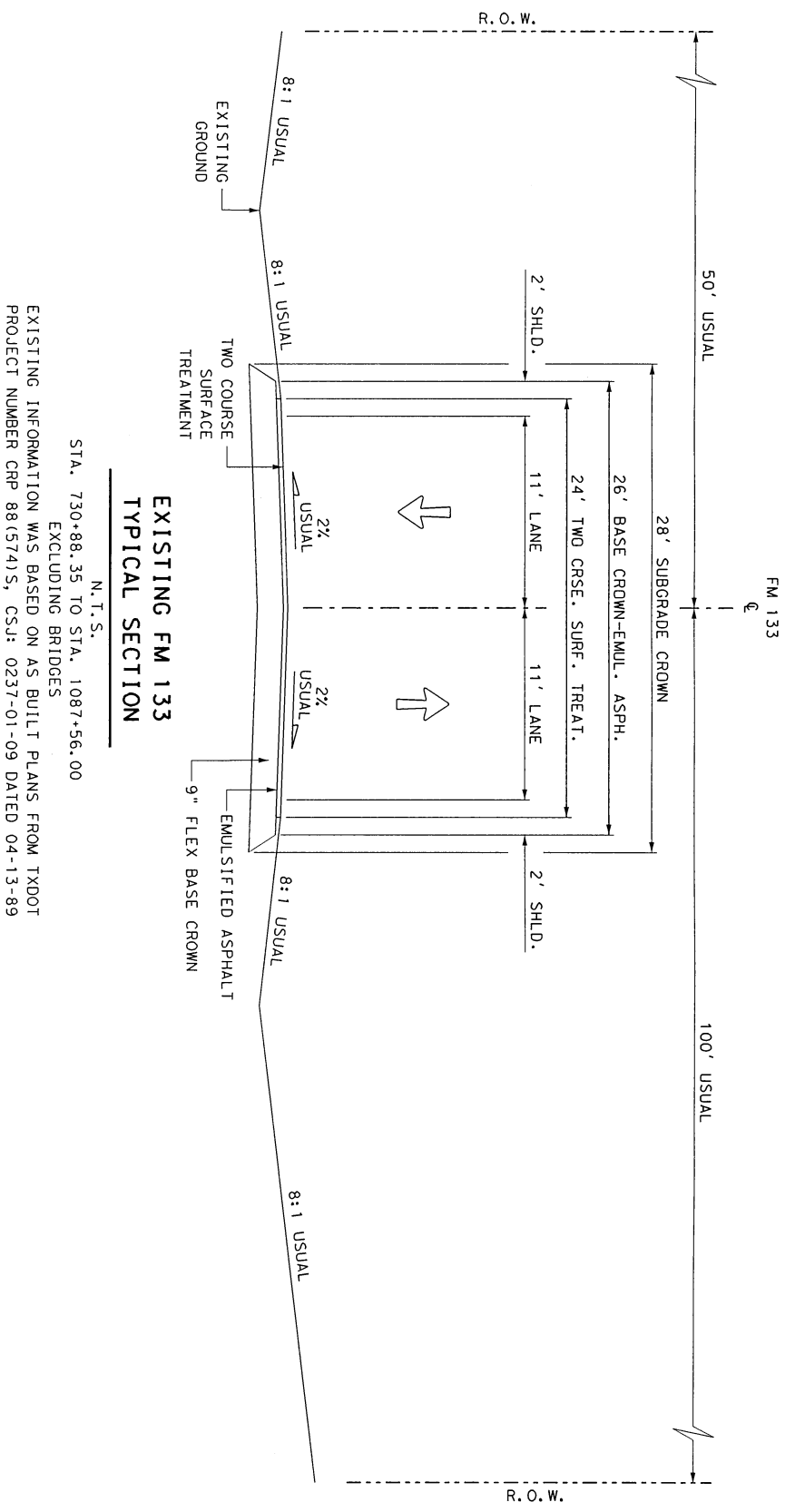

DESIGN
 LUKE REED
 101242
 5/31/2013
 DATE

REVIEW AND APPROVAL
 JAMES A. LUTZ
 841722
 5/31/2013
 DATE

REV. NO.	DATE	DESCRIPTION	BY

Texas Department of Transportation
 © 2013

FM 133
EXISTING
TYPICAL SECTIONS

SHEET 1 OF 3

DATE	FIG. NO.	STATE	FEDERAL AID PROJECT NO.	HIGHWAY NO.
5/31/2013	6	TEXAS		FM 133
PAGE	DIST.	COUNTY	CONTR. NO.	SECT. NO.
5	LAREDO	LA SALLE	0237	01
				018
				5

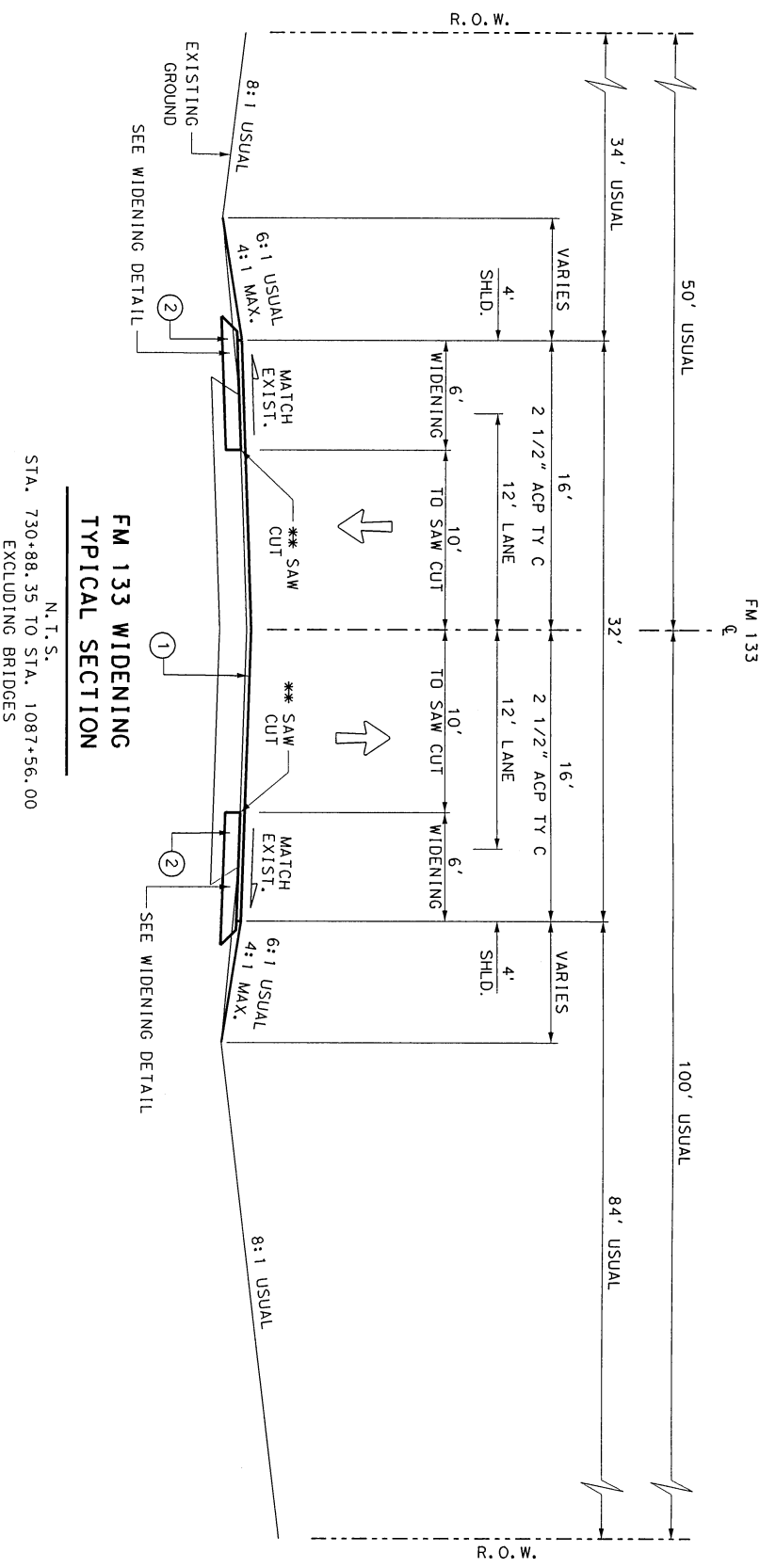

**FM 133 WIDENING
TYPICAL SECTION**
N.T.S.
STA. 730+88.35 TO STA. 1087+56.00
EXCLUDING BRIDGES

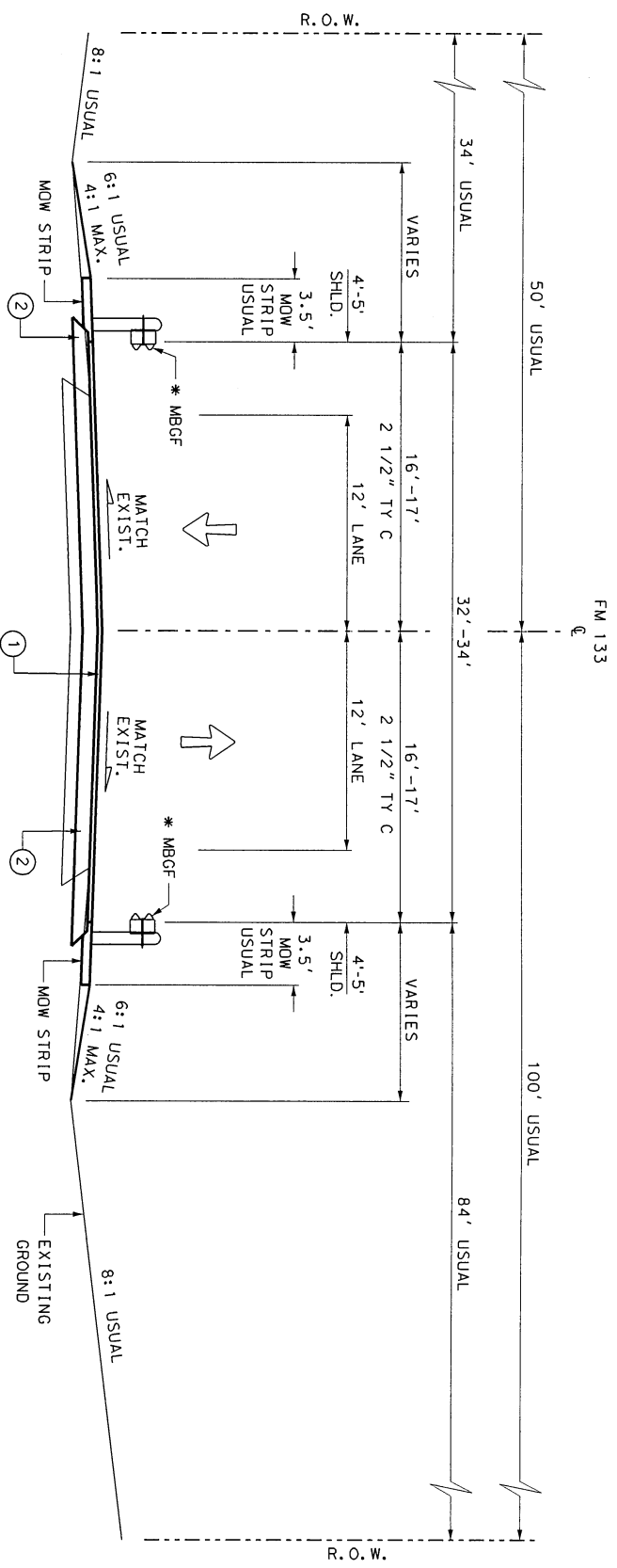

**FM 133
FULL WIDTH RECONSTRUCTION & WIDENING
TYPICAL SECTION**
N.T.S.

TO BE USED AT THESE STRUCTURE LOCATIONS:
BRIDGE CLASS CULVERT STA. 827+17, SLAB SPAN BRIDGE STA. 886+76
SLAB SPAN BRIDGE STA. 1002+74, SLAB SPAN BRIDGE STA. 1022+43
SLAB SPAN BRIDGE STA. 1026+77, SLAB SPAN BRIDGE STA. 1060+80

* SEE METAL BEAM GUARD FENCE DETAIL SHEET FOR MBOF LOCATIONS

** SAW CUT AND REMOVE THE TOP 5 1/2" OF EXISTING ASPHALT PAVEMENT AND FLEX BASE OVER THE WIDENING AND PAVEMENT REPLACEMENT AREAS IN A NEAT LINE, SAW CUT TO BE SUBSIDIARY TO ITEM 3224 HMA TY C, NO SEPARATE PAY.

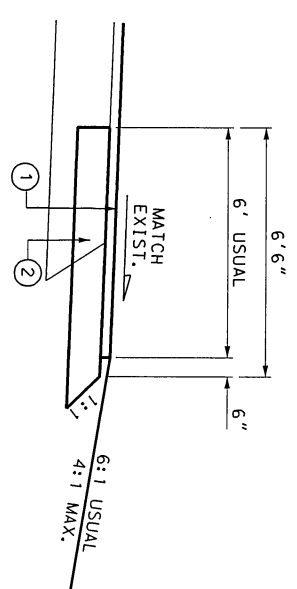

WIDENING DETAIL
N.T.S.

- ① 2 1/2" TY-C
 - ② 5 1/2" TY-B TO BE PLACED IN 2 EQUAL LIFTS
- SEE GENERAL NOTES FOR APPLICATION RATES



DESIGN
LUKE REED
LUKE REED
101242
5/31/2013



REVIEW AND APPROVAL
JAMES A. LUTZ
JAMES A. LUTZ
841722
5/31/2013

REV. NO.	DATE	DESCRIPTION	BY

Pape-Dawson ENGINEERS
555 EAST RAMSEY | SAN ANTONIO, TEXAS 78216 | PHONE: 210.375.9000
TEAS BOARD OF PROFESSIONAL ENGINEERS, FIRM REGISTRATION # 410
FAX: 210.375.9010

Texas Department of Transportation
© 2013

FM 133
**PROPOSED
TYPICAL SECTIONS**

DATE	REV.	BY	CHKD.	DESCRIPTION	SHEET NO.
05/31/2013	1	LAREDO	L.A.SALLE	0237	01

SHEET 2 OF 3
HIGHWAY NO. FM 133

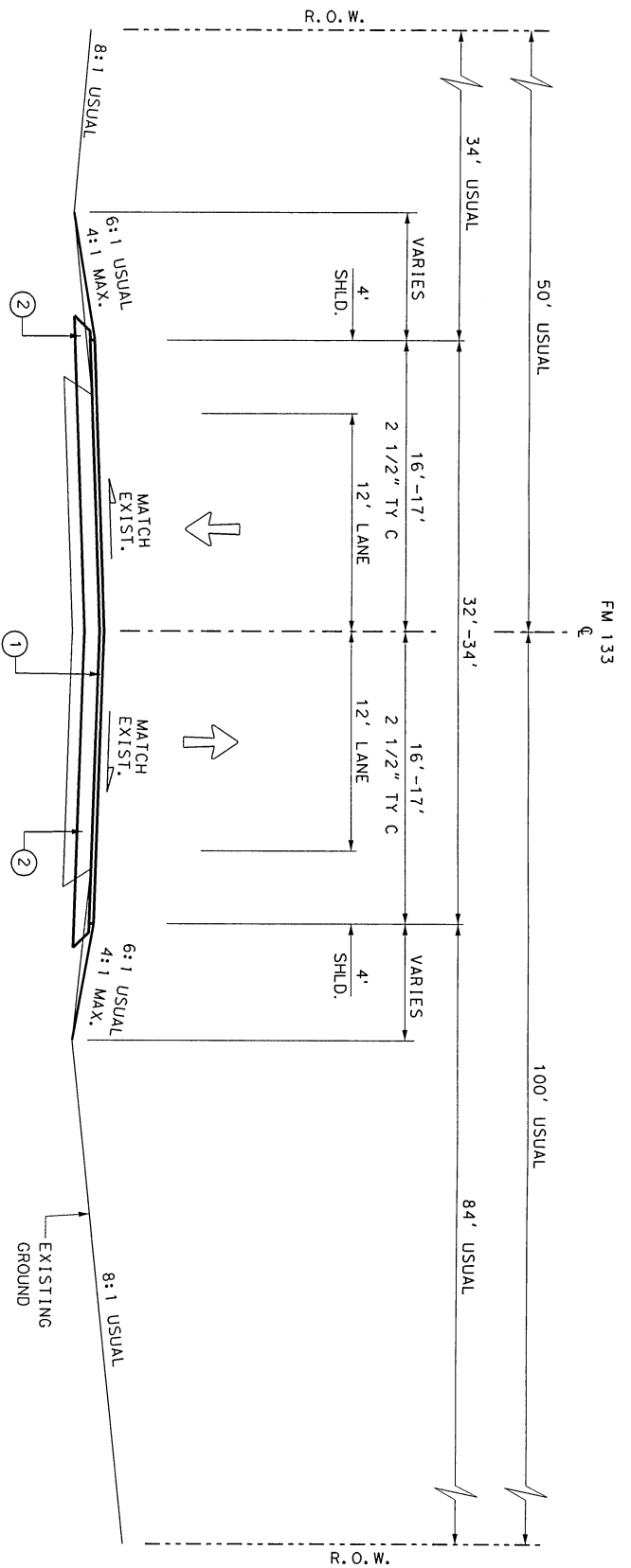

FM 133
FULL WIDTH RECONSTRUCTION & WIDENING
TYPICAL SECTION

N.T.S.
TO BE USED AT 5 LOCATIONS (20' X 50') TO
BE DETERMINED BY ENGINEER

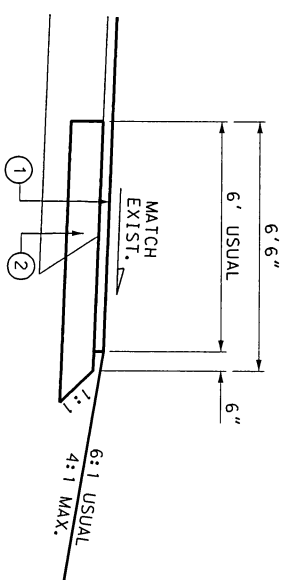

WIDENING DETAIL

N.T.S.

- ① 2 1/2" TY-C
- ② 5 1/2" TY-B TO BE PLACED
IN 2 EQUAL LIFTS

SEE GENERAL NOTES FOR APPLICATION RATES

DESIGN
LUKE REED
PROFESSIONAL ENGINEER
101242
5/31/2013
DATE

REVIEW AND APPROVAL
JAMES A. LUTZ, P.E.
PROFESSIONAL ENGINEER
84722
5/31/2013
DATE

REV. NO.	DATE	DESCRIPTION	BY

555 EAST RAMSEY | SAN ANTONIO, TEXAS 78216 | PHONE: 210.375.9000
 TEXAS BOARD OF PROFESSIONAL ENGINEERS, FIRM REGISTRATION # 410 | FAX: 210.375.9010

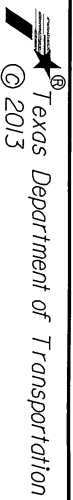

FM 133

PROPOSED
TYPICAL SECTIONS

SHEET 3 OF 3	
DATE	5/31/2013
DRAWN BY	LA SALLE
CHECKED BY	01
DATE	018
PROJECT NO.	7

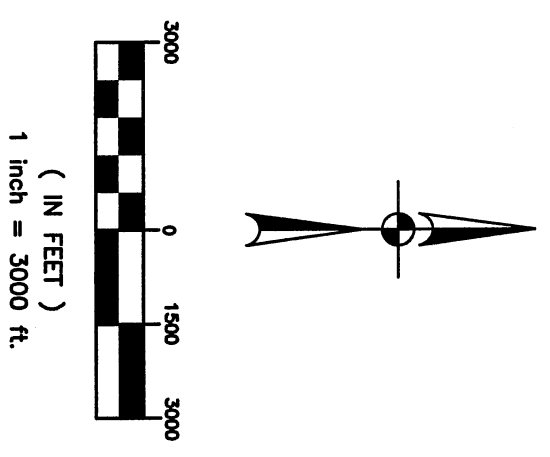
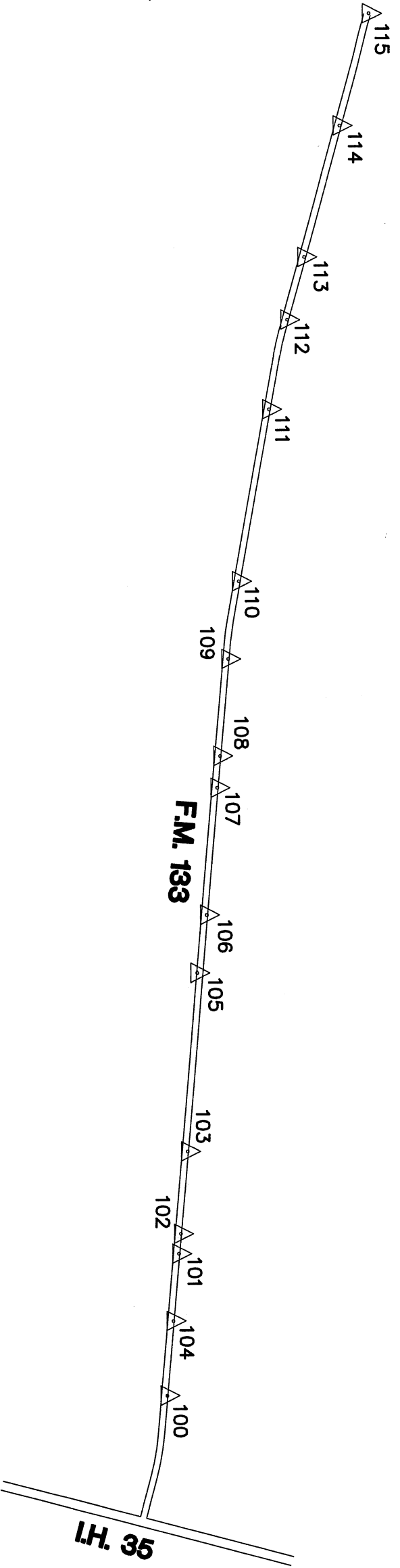

- NOTES:**
1. COORDINATES SHOWN ARE DISPLAYED IN US SURVEY FEET, BASED ON THE NORTH AMERICAN DATUM OF 1983 (epoch 2010) FROM THE TEXAS COORDINATE SYSTEM ESTABLISHED FOR THE SOUTH CENTRAL ZONE, DERIVED FROM THE TEXAS DEPARTMENT OF TRANSPORTATION VRS NETWORK, WITH A SURFACE ADJUSTMENT FACTOR OF 1.00000 APPLIED.
 2. ELEVATIONS SHOWN ARE BASED ON NAVD88 (GEOID 12A) ESTABLISHED BY GPS RTK METHODS.

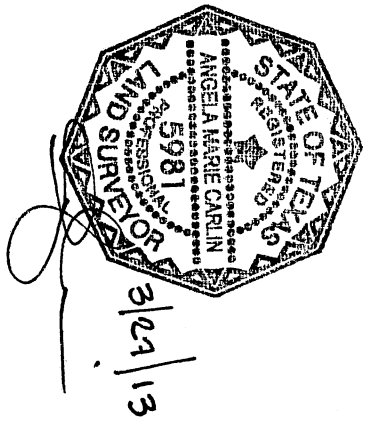

REV. NO.	DATE	DESCRIPTION	BY

Pape-Dawson
ENGINEERS

555 EAST PALMERY | SAN ANTONIO, TEXAS 78216 | PHONE: 210.375.9000
 TEXAS BOARD OF PROFESSIONAL ENGINEERS, FIRM REGISTRATION # 479 | FAX: 210.375.8000

Texas Department of Transportation
 © 2013

F.M. 133
 FROM 100- FEET WEST OF I.H. 35
 TO THE DIMMITT/LA SALE COUNTY LINE
 PRIMARY HORIZONTAL
 AND VERTICAL
 CONTROL

JOB NO.	STATE	FEDERAL AID PROJECT NO.	HIGHWAY NO.			
0081	TEXAS		FM 133			
CHK. DATE	DIST.	COUNTY	CONTR. NO.	SECT. NO.	JOB NO.	SHEET NO.
02/13	06	LA SALLE	0237	01	018	3