

- LEGEND**
- DRAINAGE AREA BOUNDARY
  - EXISTING RIGHT-OF-WAY
  - PROPOSED RIGHT-OF-WAY
  - AREA ID
  - DRAINAGE AREA IN ACRES
  - FLOW DIRECTION

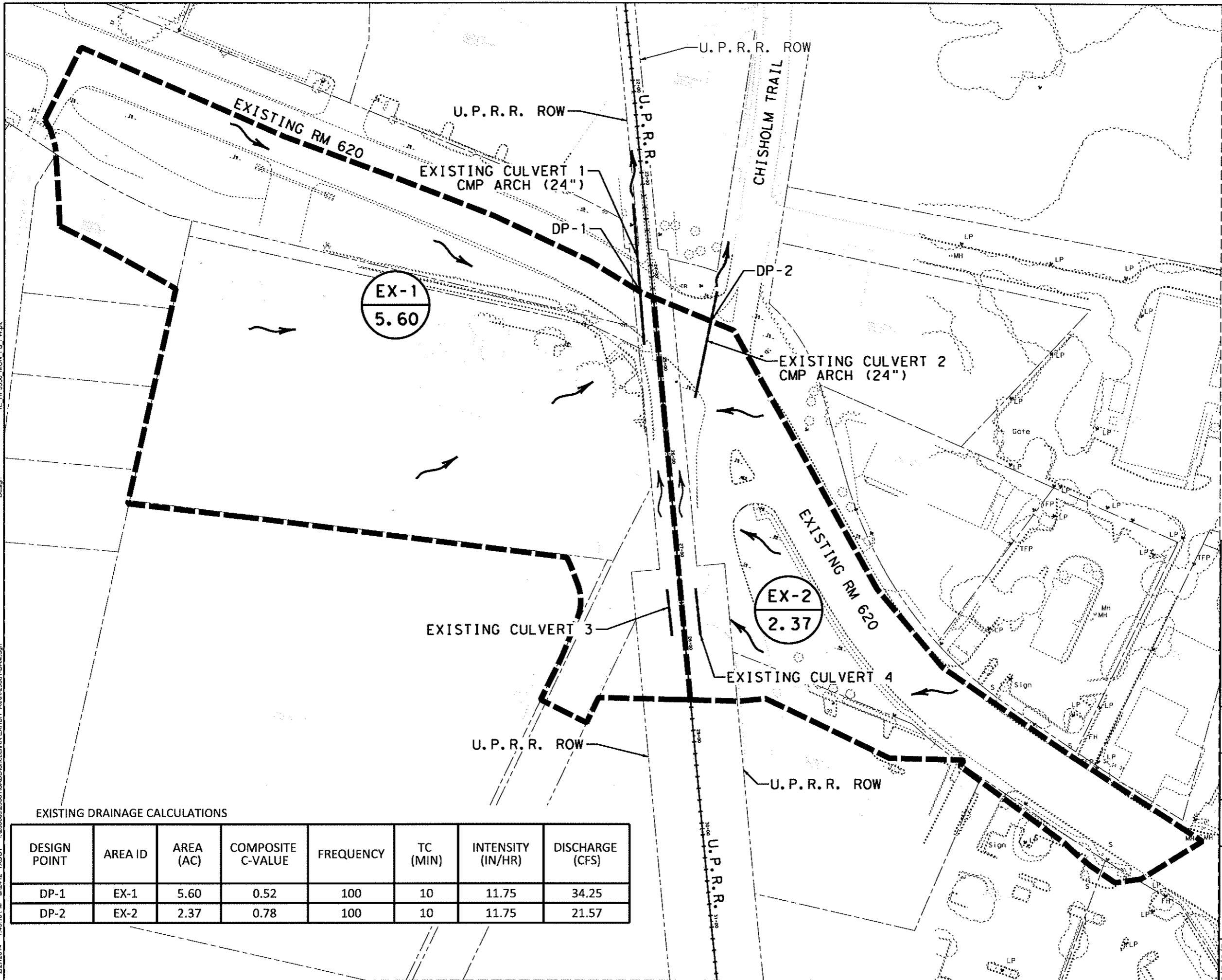

HALFF ASSOCIATES, INC.  
 ENGINEERS - SURVEYORS - SCIENTISTS  
 PRELIMINARY - FOR INTERIM REVIEW ONLY  
 This document is for informational purposes only, and is not for construction. It was prepared by, or under the supervision of:  
 CHAD CORMACK, P.E. 114227 02/25/2014  
 Type or Print Name PE# Date

**HALFF** 4030 WEST BRAKER LANE, SUITE 450  
 AUSTIN, TEXAS 78759-5356  
 TEL (512) 252-8184  
 FAX (512) 252-8141  
 TYPE FIRM NO. F-312

2014 Texas Department of Transportation

CITY OF ROUND ROCK, TX  
 2008 ENTERPRISE DRIVE  
 ROUND ROCK, TX 78664

**RM 620 DRAINAGE REPORT**  
**EXISTING DRAINAGE AREA MAP**

SCALE: 1" = 100' SHEET 2 OF 4

Designed: XX	DATE: 02/25/14	STATE: TEXAS	FEDERAL AID PROJECT NO.:	HIGHWAY NO.:
Checked: XX				RM 620
Drawn:	DIST.:	COUNTY:	CONTROL NO.:	SECTION NO.:
Checked: ER	AUS	WILLIAMSON	0683	01 056

EXISTING DRAINAGE CALCULATIONS

DESIGN POINT	AREA ID	AREA (AC)	COMPOSITE C-VALUE	FREQUENCY	TC (MIN)	INTENSITY (IN/HR)	DISCHARGE (CFS)
DP-1	EX-1	5.60	0.52	100	10	11.75	34.25
DP-2	EX-2	2.37	0.78	100	10	11.75	21.57

2/27/2014 1:45:18 PM a2412 TXDOT I:\28000\28581\CADD\Sheets\RR EXHIBIT\_A\RR-29581-DAM.dgn Design: IE\_HP5550\_MGN\_FS\_FW.plt

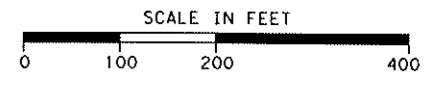

- LEGEND**
- DRAINAGE AREA BOUNDARY
  - EXISTING RIGHT-OF-WAY
  - PROPOSED RIGHT-OF-WAY
  - AREA ID
  - DRAINAGE AREA IN ACRES
  - FLOW DIRECTION

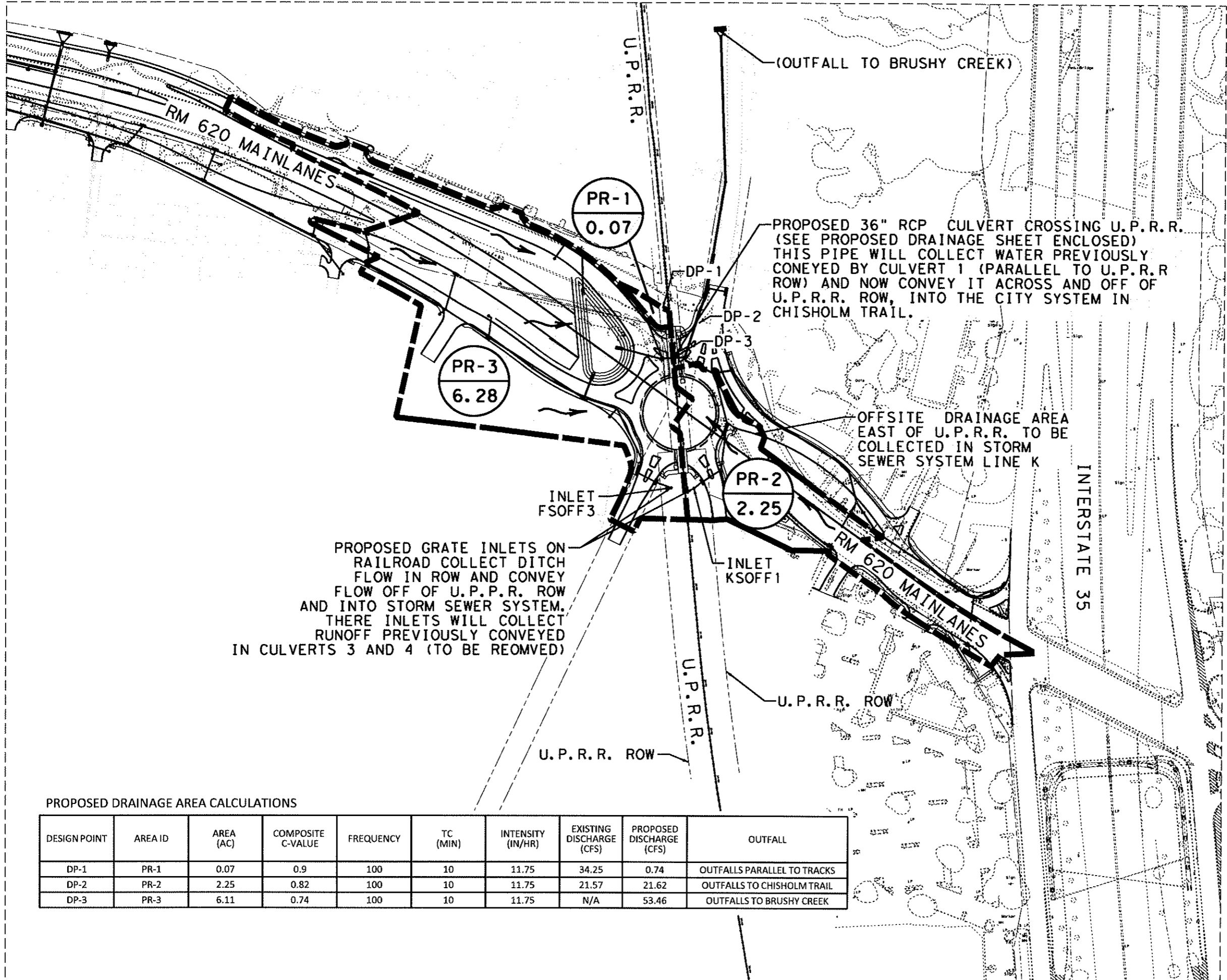

PROPOSED GRATE INLETS ON RAILROAD COLLECT DITCH FLOW IN ROW AND CONVEY FLOW OFF OF U.P.P.R. ROW AND INTO STORM SEWER SYSTEM. THERE INLETS WILL COLLECT RUNOFF PREVIOUSLY CONVEYED IN CULVERTS 3 AND 4 (TO BE REOMVED)

PROPOSED DRAINAGE AREA CALCULATIONS

DESIGN POINT	AREA ID	AREA (AC)	COMPOSITE C-VALUE	FREQUENCY	TC (MIN)	INTENSITY (IN/HR)	EXISTING DISCHARGE (CFS)	PROPOSED DISCHARGE (CFS)	OUTFALL
DP-1	PR-1	0.07	0.9	100	10	11.75	34.25	0.74	OUTFALLS PARALLEL TO TRACKS
DP-2	PR-2	2.25	0.82	100	10	11.75	21.57	21.62	OUTFALLS TO CHISHOLM TRAIL
DP-3	PR-3	6.11	0.74	100	10	11.75	N/A	53.46	OUTFALLS TO BRUSHY CREEK

HALFF ASSOCIATES, INC.  
 ENGINEERS - SURVEYORS - SCIENTISTS  
 PRELIMINARY - FOR INTERIM REVIEW ONLY  
 This documents is for informational purposes only, and is not for construction. It was prepared by, or under the supervision of:  
 CHAD CORMACK, P.E. 114227 02/25/2014  
 Type or Print Name PE# Date

**HALFF** 4030 WEST BRAKER LANE, SUITE 450  
 AUSTIN, TEXAS 78758-3356  
 TEL (512) 252-8184  
 FAX (512) 252-8141  
 TPE FIRM NO. F-312

Texas Department of Transportation

CITY OF ROUND ROCK, TX  
 2008 ENTERPRISE DRIVE  
 ROUND ROCK, TX 78664

RM 620 DRAINAGE REPORT

PROPOSED DRAINAGE AREA MAP

SCALE: 1"=200' SHEET 3 OF 4

Designed: XX	BY: RR	STATE	FEDERAL AID PROJECT NO.	HIGHWAY NO.
Checked: XX	TEXAS			RM 620
Drawn:	DIST.	COUNTY	CONTROL SECTION NO.	JOB NO.
Checked: ER	AUS	WILLIAMSON	06B3	01 056

2/27/2014 1:59:24 PM a62412 TXDOT I:\29000\29581\CAD\Drawings\RR EXHIBIT A\RR-29581-DAM-PROP.dgn Design 1E\_HPS550\_MON\_FS\_EW.plt

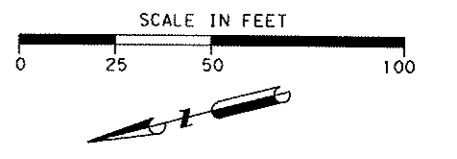
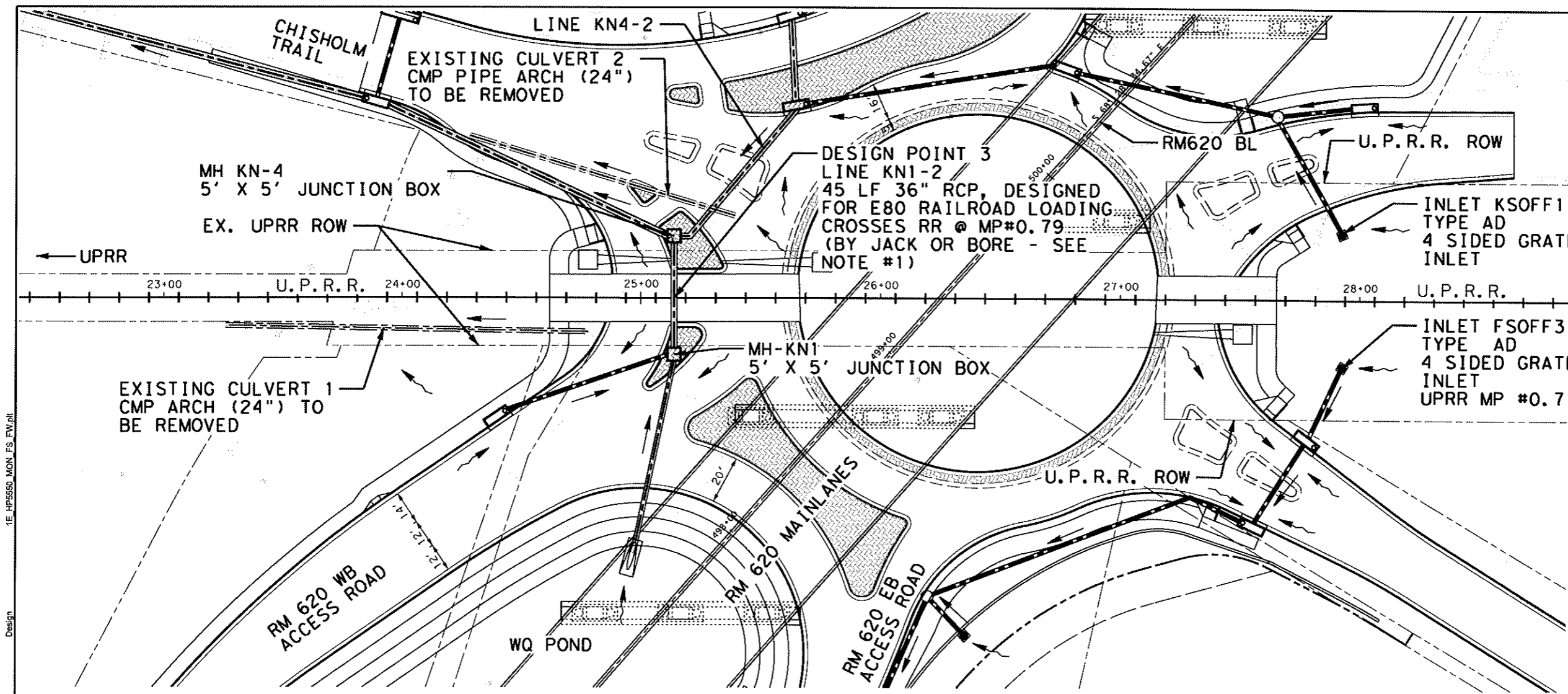

- LEGEND**
- DROP INLET
  - CURB INLET
  - OVERLAND FLOW DIRECTION
  - PIPE FLOW DIRECTION
  - DITCH FLOWLINE
  - EXISTING ROW
  - PROPOSED ROW
  - PROPOSED STORM SEWER
  - PROPOSED CONC. RIPRAP

**NOTES:**  
 1. A PIPELINE INSTALLATION PERMIT APPLICATION WILL BE SUBMITTED ON-LINE TO UPRR FOR THIS PIPE CROSSING AND DRAINAGE INLETS IN UPRR ROW.

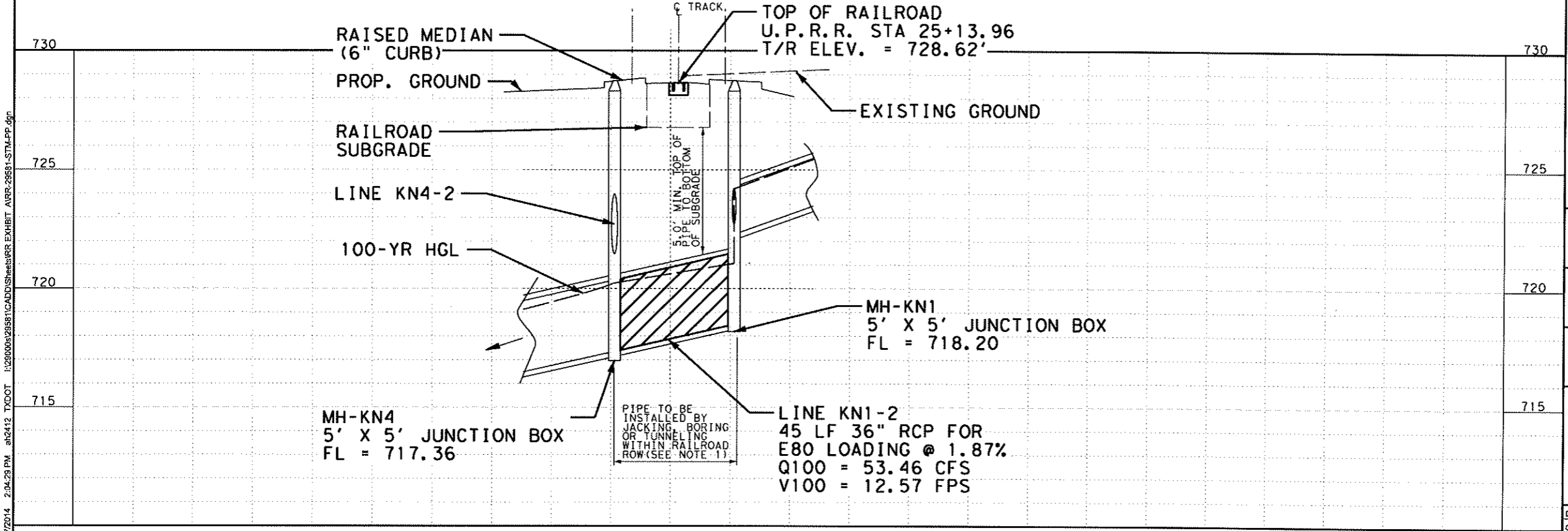

HALFF ASSOCIATES, INC.  
 ENGINEERS - SURVEYORS - SCIENTISTS  
 PRELIMINARY - FOR INTERIM REVIEW ONLY  
 This document is for informational purposes only, and is not for construction. It was prepared by, or under the supervision of:  
 CHAD CORMACK, P.E. 114227 02/25/2014  
 Type or Print Name PE# Date

**HALFF** 4030 WEST BRAKER LANE, SUITE 450  
 AUSTIN, TEXAS 78759-5356  
 TEL (512) 252-8184  
 FAX (512) 252-8141  
 TYPE FIRM NO. F-312

©2014 Texas Department of Transportation

CITY OF ROUND ROCK, TX  
 2008 ENTERPRISE DRIVE  
 ROUND ROCK, TX 78664

**RM 620 DRAINAGE REPORT**  
**PROPOSED DRAINAGE PLAN**  
 UPRR MP #0.79  
 EXISTING DOT #439705H  
 GEORGETOWN INDUSTRIAL LEAD SUB  
 DOT #

SCALE: 1" = 50' SHEET 4 OF 4

Designed: XX	STATE	FEDERAL AID PROJECT NO.	HIGHWAY NO.
Checked: XX	TEXAS		RM 620
Drawn:	DIST.	COUNTY	CONTROL SECTION JOB
Checked: ER	AUS	WILLIAMSON	0683 01 056

1E\_HP5550\_MON\_FS\_FW.pl  
 Design  
 I:\200000\20581\CADD\Sheets\RR EXHIBIT\_A\RR-28581-STML-PP.dgn  
 2/27/2014 2:04:29 PM ah2412 TXDOT